

novita
AIR • WATER • BODY



HUMICONTROL™
SAFEGUARDING VALUABLE SERIES

DEHUMIDIFIER ND390i-LCD

PRODUCT FEATURES



PREFERRED
HUMIDITY
SETTING



AUTO
HUMIDITY
SENSOR



EXTENSIVE
COVERAGE
AREA



ROTARY
COMPRESSOR



CFC FREE
REFRIGERANT



PROG.
TIMER



CONTINUOUS
DRAINAGE
OPTION



AUTO STOP
WITH FULL
TANK INDICATOR



EASY ROLL
CASTORS

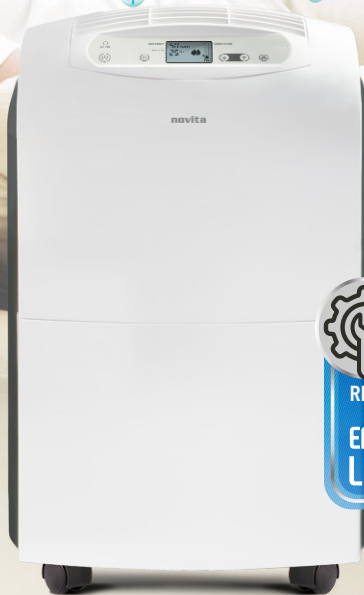

OPERATING INSTRUCTIONS AND E-WARRANTY APPLICATION

Please read instructions before using the Dehumidifier

CONTENTS

PRODUCT DESCRIPTION	02
CONTROL PANEL & DISPLAY SCREEN DESCRIPTIONS	02
TECHNICAL SPECIFICATIONS	03
FEATURES	03
• Auto-Humidity Sensor	
• Preferred Humidity Setting	
• Defrost Function	
• Auto-shut Off Function	
• Programmable Timer	
• Fan Speed Options	
• Room Temperature & Humidity Setting Display	
• Nylon Mesh Pre-filter Screen	
• Enhanced Dual Mesh Activated Carbon Filter ◊	
• Continuous Drainage	
USING THE NOVITA DEHUMIDIFIER	06
• Setting Up	
• Operating Notes	
EMPTYING THE WATER TANK	07
6 MONTHS* ENHANCED DUAL MESH ACTIVATED CARBON FILTER	07
CLEANING & MAINTENANCE	08
• Cleaning the novita Dehumidifier	
• Cleaning the Air Inlet Frame & Pre-Filter Screen	
TROUBLESHOOTING	09
SAFETY PRECAUTIONS	10
SAFETY INSTRUCTIONS	10
NOVITA CUSTOMER SERVICE GUARANTEE	11
E-WARRANTY APPLICATION	11
LIMITED WARRANTY TERMS & CONDITIONS	12
LIMITED WARRANTY EXTENSION - EXTENDED WARRANTY	13

This product includes:

- novita Dehumidifier ND390i-LCD
- novita Dehumidifier ND390i-LCD Operating Instructions & e-Warranty Application (e-copy)
- Starter Guide

* Please contact us immediately if any of the above-mentioned items are not included.

OPTIONAL	PRODUCT ACCESSORY
Includes:	
• 2 x Enhanced Dual Mesh Activated Carbon Filter◊	

◊ It is an optional product accessory.

* Based on average 8 hours a day, 7 days a week under normal domestic indoor environment usage.

PRODUCT DESCRIPTION

Dehumidifier ND390i-LCD

FRONT VIEW

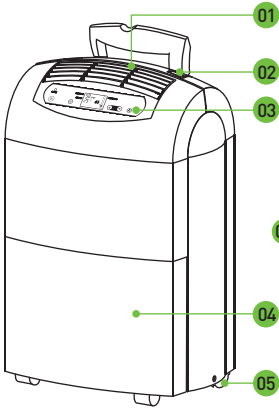

BACK VIEW

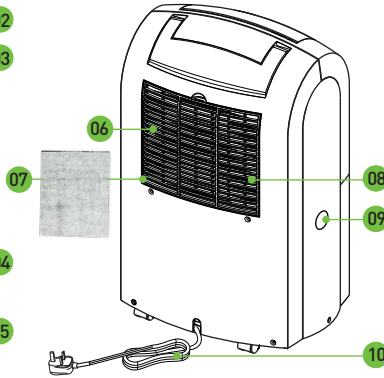

- 01 Air Outlet
- 02 Handle
- 03 Control Panel
- 04 Water Tank
- 05 Easy Roll Castor
- 06 Air Inlet Frame & Pre-Filter Screen
- 07 Enhanced Dual Mesh Activated Carbon Filter (Optional)
- 08 Air Inlet
- 09 Optional Continuous Drainage Outlet
- 10 Power Cord & Power Plug

CONTROL PANEL & DISPLAY SCREEN DESCRIPTIONS

CONTROL PANEL

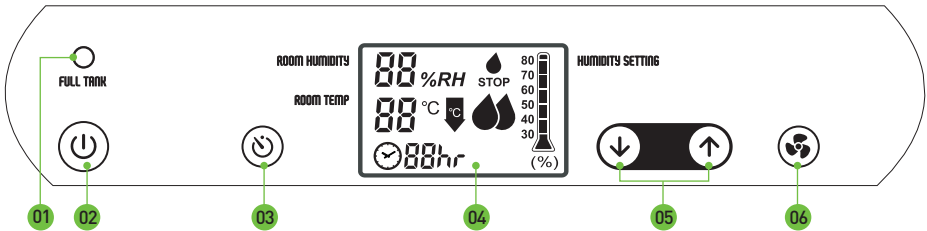

- 01 Full Tank Indicator
- 02 Power ON/OFF Button
- 03 Prog. Timer Button
- 04 Display Screen
- 05 Humidity Setting Button
- 06 Fan Speed Button

DISPLAY SCREEN

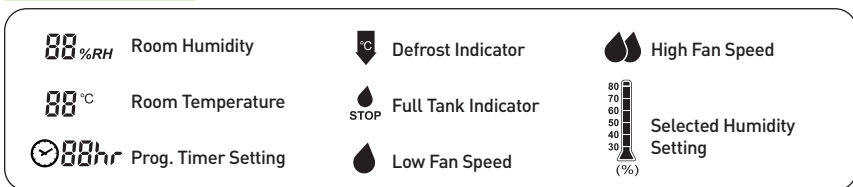

TECHNICAL SPECIFICATIONS

Power Consumption	600 Watts
Extraction (30°C, 80% RH)	35 Litres/Day (30 °C, 80% RH)
Humidity Setting	Available
Auto Humidity Sensor	Available
Easy Roll Castors	Available
Running Temperature	5°C to 32°C
Compressor	Rotary
Coolant	R-410A
Empty Weight	15 Kg
Dimension (W x D x H)	390 mm x 274 mm x 612 mm
Continuous Drainage	Available
Recommended Coverage	Up To 600 ft ² or 56 m ²
Tank Capacity	6.5 Litres
Air Flow	Low Speed: 180 m ³ /hr High Speed: 220 m ³ /hr
Optional Product Accessory	<ul style="list-style-type: none"> • 2 x Enhanced Dual Mesh Activated Carbon Filter (Recommended every 6 months replacement) • PVC Hose (13 mm Internal Diameter)

□ It is recommended to confine to the stated recommended coverage area for effective and optimum dehumidification performance.
*Based on average 8 hours a day, 7 days a week under normal domestic indoor environment usage.

FEATURES

Auto-Humidity Sensor

The inbuilt hygrostat detects the humidity level of the surrounding and compares it to the humidity level set. The compressor stops while the fan continues to run when the desired humidity level is achieved. Compressor will reactivate when humidity level of the surrounding surpasses the desired humidity level.

Preferred Humidity Setting

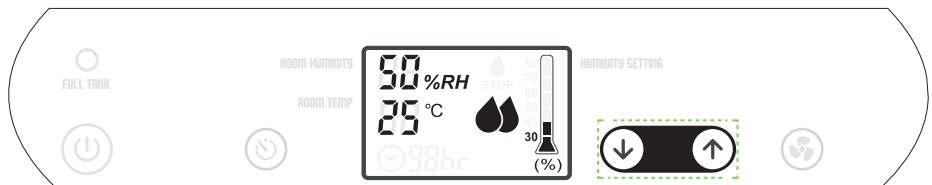

The humidity level can be set according to individual's desire within a range of 30% to 80% RH, at interval of 5% RH or select continuous dehumidification mode that dehumidifies continuously regardless of the humidity level in the surrounding.

Defrost Function

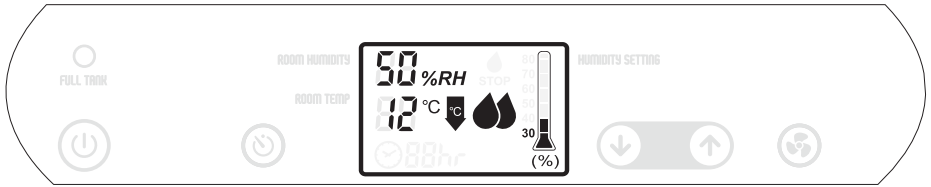

Defrost mode will be activated automatically when room temperature drops to 12°C and below and defrost light  indicator illuminates as sensor detects the drop in temperature.

Auto-Shut Off Function

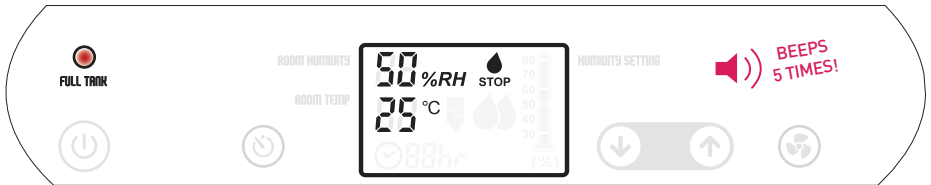



Unit shuts off automatically and full water tank indicator illuminates in red in the following circumstances.

- A. Water tank is full.
- B. Water tank is not placed properly.
- C. Water tank is removed.

 • Unit beeps five times when the tank is full.

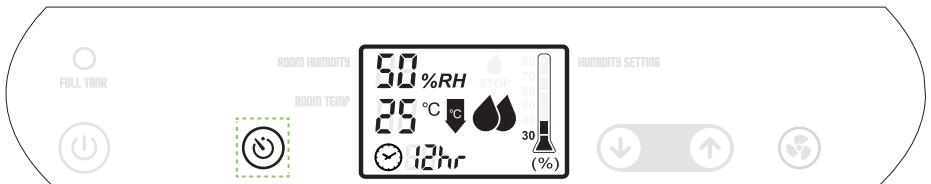
Programmable Timer



Press timer  button to select the preferred timer operation from 01 to 12 hours, at an interval of 1 hour. Timer can be applied to both ON and OFF mode to turn OFF or turn ON the unit respectively.

Fan Speed Option

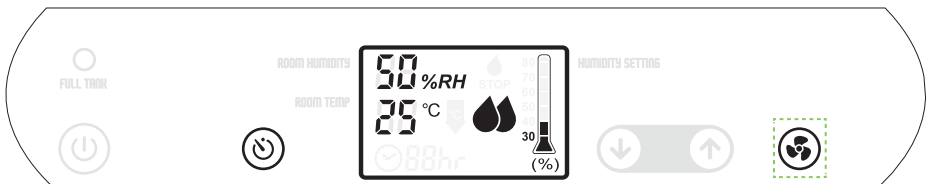

Fan speed  button to select  high or  low fan speed setting.

Room Temperature & Humidity Setting Display

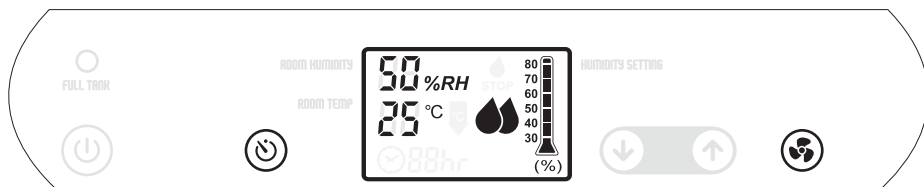

Unit is equipped with sensors to detect the current surrounding temperature and humidity level and it will be displayed in degree Celsius and RH% respectively

Nylon Mesh Pre-filter Screen

The pre-filter sieves out contaminants from the air before the dehumidification process. This works to increase the efficiency of the unit and help to filter the air that is released back into the surroundings.

- ⚡ • DO NOT use the dehumidifier without the Air Inlet Frame & Pre-Filter Screen in place.

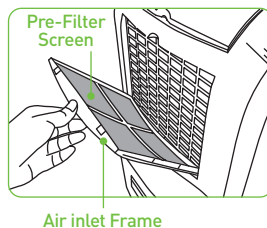

Enhanced Dual Mesh Activated Carbon Filter^o

Enhanced Dual Mesh Activated Carbon Filter^o eliminates musty smell and unpleasant odour lingering in the air. It is recommended to replace the Enhanced Dual Mesh Activated Carbon Filter^o once every 6 months* for optimum performance.

◊ It is an optional product accessory.

* Based on average 8 hours a day, 7 days a week under normal domestic indoor environment usage.

Continuous Drainage Option

Instead of manually removing the water from the water tank, the novita dehumidifier ND390i-LCD can be set to use with the optional continuous drainage option.

Using the continuous drainage option:

01. Turn off the power supply and remove the plug from the power outlet.
02. Remove the water tank from the unit.
03. Punch out the designated continuous drainage hole located at the side of the unit.
04. Insert the 13 mm diameter PVC hose (compatible with garden hose) through the drainage hole. Ensure the hose is placed in a downward angle.
05. Replace the water tank back onto the unit. Always ensure the dehumidifier is placed on a stable and level surface for continuous drainage option, otherwise water will be channelled into the water tank instead. The dehumidifier is now ready for continuous drainage.

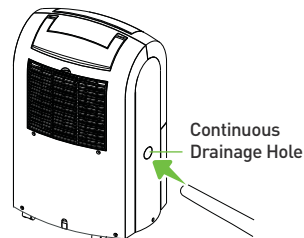

- When using the continuous drainage option, the PVC hose must be placed lower than the drainage hole.
- Avoid uneven ground and bending the PVC hose.
- Always ensure the drainage path is not blocked or obstructed to maintain a smooth flow and operation.
- To revert using the water tank for water collection, it is advised to cover the exposed continuous drainage hole with a cloth tape to prevent small amount of water that might splash or squirt out while the unit is operating.
- PVC hose is available upon request. To request, please contact novita Customer Care Centre.

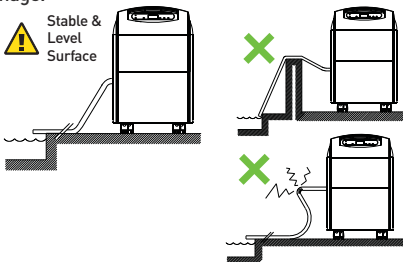

USING THE NOVITA DEHUMIDIFIER

Setting Up

01. Remove all packaging materials and place the unit on a dry, stable and level surface.

 • DO NOT remove the polystyrene from the water tank.

02. From the back of the unit, grasp the Air Inlet Frame and pull it outwards to remove both the Air Inlet Frame and Pre-Filter Screen from the unit.

03. To enhance the HumiControl™ experience, it is recommended to use the Enhanced Dual Mesh Activated Carbon Filter® in conjunction with the dehumidification process. Remove the Enhanced Dual Mesh Activated Carbon Filter® from the filter pack and place it against the unit's internal housing. Then proceed to re-attach the Air Inlet Frame and Pre-Filter Screen back onto the unit.

◊ Enhanced Dual Mesh Activated Carbon Filter is an optional product accessory and can be purchased separately.

 • Ensure the Enhanced Dual Mesh Activated Carbon Filter® is properly assembled and installed in position before use.

• Please refer to operating instructions manual for instructions to assemble/remove the Enhanced Dual Mesh Activated Carbon Filter® from the unit.

 • Please handle the Enhanced Dual Mesh Activated Carbon Filter® with care while inserting or removing it from the unit as it is designed tight for optimum purification coverage.

• It is recommended to replace the Enhanced Dual Mesh Activated Carbon Filter® once every 6 months for optimum performance.

• DO NOT use the dehumidifier without the Air Inlet Frame and the Pre-Filter Screen in place.

04. Ensure there is a clearance of at least 50 cm from the air inlet and clearance of at least 10 cm from the air outlet.

 • DO NOT block the air inlet and air outlet to ensure sufficient air ventilation and maximum efficiency of the unit.

05. Insert the power plug to the power supply, power on and unit beeps once.

Operating Notes

01. Turn on the unit by pressing the power control  button.

 • Unit is equipped with memory function whereby when power is restored, unit will operate in accordance to its preceding settings.

• When the unit is turned on for the first time, if the full tank indicator illuminates, simply pull out the water tank and reassemble it into the unit to resolve the notification.

02. Press the humidity setting or button to select the preferred humidity range of 30% to 80% at an interval of 5% RH or continuous dehumidification mode. The selected humidity level will illuminate on the display screen as illustrated below.

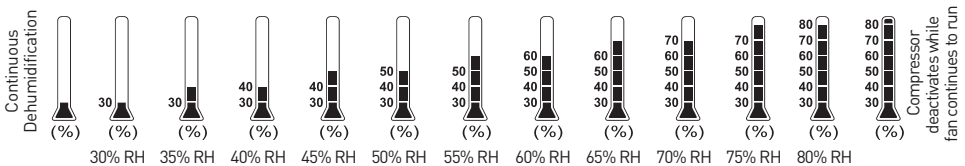

 • The inbuilt thermostat detects the humidity level of the surrounding and compares it to the humidity level set. The compressor stops while the fan continues to run when the desired humidity level is achieved. Compressor will reactivate when humidity level of the surrounding surpasses the desired humidity level.

• At continuous dehumidification mode, unit dehumidifies continuously regardless of the humidity level in the surrounding. Dehumidification stops when the water tank is full.

03. Defrost mode will be activated automatically when room temperature drops to 12°C and below and  indicator illuminates on the display screen.

04. When the water tank is full, unit shuts off automatically. The full water tank indicator lights up in red and the corresponding  indicator illuminates on the display screen.

 • Unit beeps five times when the tank is full.

05. Press speed (🌀) button to select the preferred fan speed (high 🌊 or 🌊 low) and the corresponding indicator will illuminate on the display screen.
06. Press timer (🕒) button to select the preferred timer operation from 01 to 12 hours, at an interval of 1 hour. Timer can be applied to both ON and OFF mode and selected timer duration 🕒:00hr will be shown on the display screen.
- In OFF mode, the unit can be programmed to start operating in accordance to the timer set.
 - In ON mode, the unit can be programmed to stop operating in accordance to the timer set.
07. Unit is equipped with sensors to detect the current surrounding humidity level and temperature and the readings 88%RH and 88°C will be shown on the display screen.

EMPTYING THE WATER TANK

novita Dehumidifier ND390i-LCD shuts off automatically when the water tank is full. Follow the simple steps below to empty the water tank.

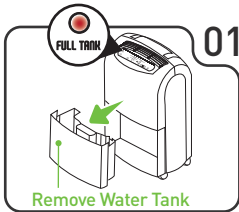

01 Remove the water tank from the unit.

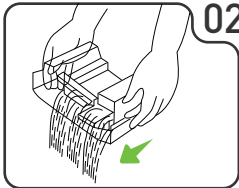

02 Hold the water tank with both hands and discard the content. Reassemble the water tank into the unit. The unit will auto resume its operation again.

6 MONTHS* ENHANCED DUAL MESH ACTIVATED CARBON FILTER[®] REPLACEMENT

For an optimum HumiControl™ performance, it is recommended to replace the Enhanced Dual Mesh Activated Carbon Filter[®] once every 6 months* from initial usage.

◊ Enhanced Dual Mesh Activated Carbon Filter is an optional product accessory and can be purchased separately.

*Based on average 8 hours a day, 7 days a week under normal domestic indoor environment usage.

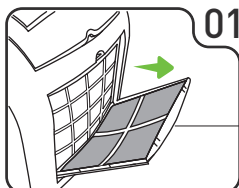

01 Grasp the Air Inlet Frame and pull it outwards to remove both the Air Inlet Frame and Pre-Filter Screen from the unit

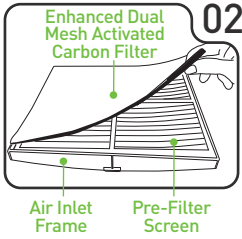

Place a new Enhanced Dual Mesh Activated Carbon Filter on top of the pre-filter screen as illustrated.

- Ensure the Enhanced Dual Mesh Activated Carbon Filter is properly assembled and installed in position before use.
- Please handle the Enhanced Dual Mesh Activated Carbon Filter with care when removing/assembling it as it is designed tight for optimum purification performance.

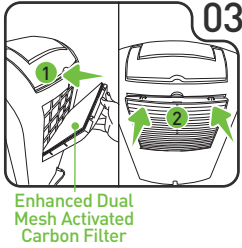

Align and re-attached the Air Inlet Frame & Pre-Filter Screen with Enhanced Dual Mesh Activated Carbon Filter back onto the unit.

- **DO NOT** use the dehumidifier without the Air Inlet Frame & Pre-Filter Screen in place.

CLEANING & MAINTENANCE

Cleaning the novita Dehumidifier

To ensure the effectiveness of the dehumidifier, it is recommended to clean & maintain the unit at least once a week.

01. Disconnect the dehumidifier from the power supply.
02. Use a soft cloth to gently wipe the outer case to remove dust.
03. Remove stubborn stains with a mild household cleaner.
04. Remove any inevitable dust intake at the continuous drainage outlet port to prevent it from being clogged and result in overflowing.
05. Remove the water tank, check and clean the water float sensor. Ensure the water float sensor can move and pivot freely in order to actuate the auto shut-off mechanism when the water tank is full. In the event if the water float sensor is stuck, it will lead to water tank overflow.

- Please turn Off the power supply and disconnect the power plug before cleaning and maintenance.
- **DO NOT** spray water directly onto the unit.

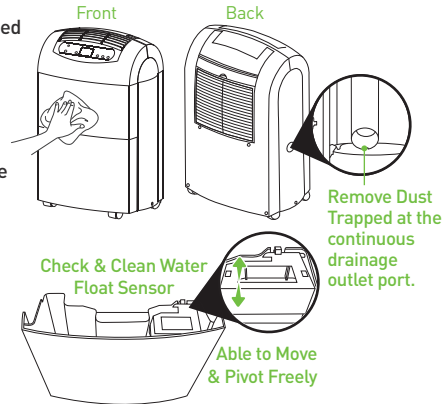

Cleaning the Pre-Filter Screen

For optimum performance, it is recommended to clean the Pre-Filter Screen once every two (2) weeks.

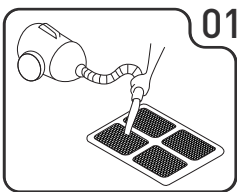

1. Remove the pre-filter screen from the unit and vacuum the surface or use a brush to gently remove the lint collected.
2. To wash the pre-filter screen, use warm soapy water and rinse it.
3. Ensure the pre-filter screen is dry before replacing it back into the unit.

- **DO NOT** use the dehumidifier without the Air Inlet Frame and Pre-Filter Screen in place.

TROUBLESHOOTING

CONDITION	POSSIBLE CAUSE	POSSIBLE SOLUTION
Fan & compressor are not working.	• Water tank is not placed correctly.	• Remove water tank and replace it into the unit again.
	• Plug or cord is damaged.	• Contact novita Customer Care Centre.
Fan is not working.	• Motor has broken down.	• Contact novita Customer Care Centre.
	• 3 Minutes protection time (when overheated, it will stop functioning).	• It should resume function in 3 minutes.
	• Compressor failure.	• Contact novita Customer Care Centre.
Poor performance or not dehumidifying at optimum capacity.	• Pre-filter screen is dirty.	• Clean the pre-filter screen.
	• Low temperatures.	• When operating in low temperatures, dehumidifiers do not work as effectively.
	• Low relative humidity (RH) levels.	• Effectiveness of dehumidifier will increase as RH increases.
	• Exceed recommended room coverage area.	• Maximum room coverage area for ND390i-LCD to operate effectively: Dehumidifying Up to 600 ft ² or 56 m ²
Making excessive noise.	• Unit is placed on uneven surface.	• Move unit to level and stable surface.
	• Loose or foreign particles inside the unit.	• Contact novita Customer Care Centre.
	• Motor or compressor is loose.	• Contact novita Customer Care Centre.
	• Sound of flowing water.	• This is normal.
Water in tank overflows.	• The water tank is damaged.	• Replace the water tank.
	• The water float sensor is stuck/is not in place.	• Check, clean the water float sensor and adjust if required. Ensure the water float sensor can move and pivot freely in order to actuate the auto shut-off mechanism when the water tank is full.
	• Internal drainage passage is blocked or obstructed.	• Contact novita Customer Care Centre.
	• Motor or compressor is loose.	• Contact novita Customer Care Centre.

SAFETY PRECAUTIONS

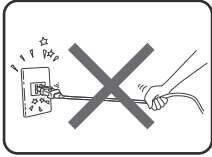

DO NOT pull or tug the unit by the power cord to prevent safety hazards or damage to the unit.

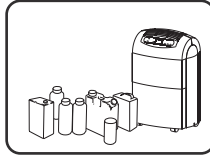

Keep the unit away from flammable liquids.

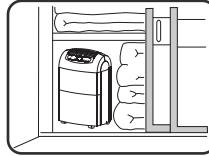

Refrain from placing the dehumidifier in confined closets.

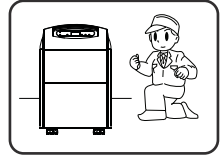

Servicing should only be conducted by professional service technicians from novita.

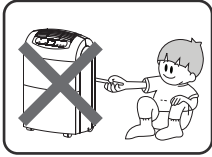

DO NOT insert any foreign objects into any crevices of the unit.

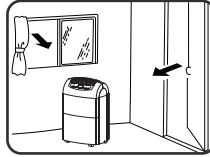

For maximum efficiency, ensure that the dehumidifier is placed in an enclosed area with windows & doors firmly shut.

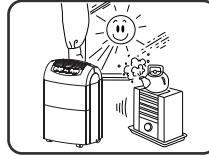

Keep the unit away from direct sunlight or any heat source.

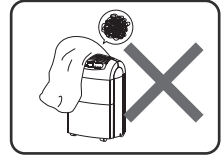

DO NOT block the air inlet & outlet when the unit is operating & DO NOT drape any garments or fabrics on top of the unit for drying purposes.

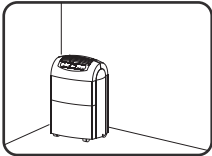

Allow adequate clearance & space around the unit for air ventilation. DO NOT move or incline the unit during operation.

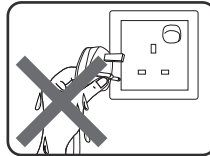

DO NOT handle the unit or the power cord with wet hands.

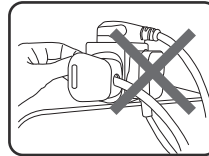

Refrain from overloading your power supply with multiple power plugs.

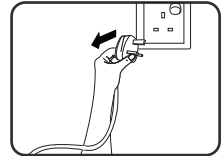

Always disconnect the unit from the power supply during transportation, maintenance or cleaning.



SAFETY INSTRUCTIONS

01. Read the operating instructions carefully before using the dehumidifier & keep it for later reference.
02. Persons who are not familiar with the operating instructions, as well as children & persons under the influence of medication, alcohol or drugs are not advised to operate the dehumidifier, or are only advised to operate it under supervision.
03. DO NOT use the dehumidifier if there is any damage to the unit or power cord.
04. Only operate the unit when it is completely assembled & on a stable and level surface. Placing the unit on uneven surfaces can result in water leakages or additional noise.
05. DO NOT handle the unit with wet hands.
06. Always use the correct power supply.
07. DO NOT insert any foreign objects into any crevices of the unit.
08. Keep the unit away from direct sunlight or heat sources.
09. Disconnect the dehumidifier from the power supply:
 - When emptying the water tank
 - Before cleaning
 - During assembly or dismantling the unit
 - Before moving the unit
10. Repairs of appliance should only be done by qualified service technicians from novita. Improper repair work can cause considerable danger to the user.

NOVITA CUSTOMER SERVICE GUARANTEE

At the cornerstone of novita's core values is the importance we place in Continuous Relationships. Consequently, we believe in harnessing the relationship we have with our customers. The first step in establishing this relationship is to ensure that we are always there for the customers whenever we're needed. These are just a few ways that we look out for you.



Free Evaluation

Check in your product for a FREE assessment and evaluation by our qualified technician. Upon your confirmation, charges only apply when there is replacement of technical parts.



Minimum Downtime

Understanding that time is of the essence, for each servicing or repair, novita guarantees that we will only take up to 7 working days to get your product up and ready for collection.



Optional Home Delivery

Time and convenience might not always be in the advantage of customers, hence, for a nominal fee of S\$18 one-way and S\$36 two-ways, customer can choose to use our delivery service instead of bringing in the product themselves.



Optional Loan Set*

Knowing how inconvenient it can get when your product is sent for servicing or repair, novita lends a hand by offering you a temporary loan set at no charge.

* Please note that this service is upon request and subjected to the availability of the product. Temporary loan set might be of a different model from original set brought in for repair.



Service Trekking*

With everyone's busy schedule, it's sometimes hard to keep track of everything. Sit back, relax and leave the fussing to us. Instead of calling and checking up on the status of your product, let novita keeps you updated.

*Customers can choose to be updated via email, phone or even sms.



Dedicated Customer Care Personnel

WhatsApp us at 8182 7665 for any enquiry or feedback. Alternatively, you can drop us an email at custcare1@novita.com.sg or visit our website at novita.com.sg. Our friendly customer care personnel will be glad to assist you.

e-WARRANTY APPLICATION

Thank you for purchasing novita HumiControl™ Dehumidifier ND390i-LCD.

In our attempt to enhance our customer's after-sales experience, we have streamlined the warranty registration process to make it hassle-free. You no longer have to make a trip to the post office or worry about losing your warranty card.



Simply scan the QR code or visit novita.com.sg/ewarranty to access to our user-friendly website and register your product warranty online at the comfort of your home or office.

E-warranty registration is only applicable to customers in Singapore and stated countries who have purchased novita product(s) from our authorised retailers or dealers. Please register your product's warranty within 14 days from the date of original purchase. Upon successful registration, an acknowledgement email will be sent to you. By submitting your e-warranty application, you have agreed to all the terms and conditions stated for this warranty.

We hope you find it a breeze to safeguard the valuables with novita HumiControl™ Dehumidifier ND390i-LCD.

LIMITED WARRANTY TERMS & CONDITIONS

01. Unless otherwise specified, this limited warranty is valid for Product installed and purchased in Singapore and stated countries for the period of 36 months limited warranty on compressor and 12 months on all parts commencing from the date of original purchase and does not include installation, removal and reinstallation.
02. This product and all parts thereof are hereby guaranteed to the purchaser/user to be free from defects in material and workmanship.
03. Please retain the original purchase receipt for verification purposes when required. To be eligible for limited warranty coverage, Product has to be registered by the original end-user purchaser/user within 14 days from the date of purchase at novita.com.sg/ewarranty.
04. This limited warranty is not transferable and shall not extend to anyone other than the original purchaser/user of this Product and does not include cleaning of the Product during the specific period.
05. Eligibility for limited warranty coverage is limited to repair, or replacement of any parts (excluding consumable parts and accessories exhausted through usage that may be packaged or sold together from the Product) which proves to be manufacturing defects within the applicable limited warranty period.
06. Limited warranty coverage does not extend to damages and/or defects resulting from:
 - a. Accidents, abuse, misuse, improper installation, or any manner of tampering.
 - b. Usage of wrong electrical supply/voltage.
 - c. Usage not in accordance with the operation instructions, maintenance and environmental instructions that are covered and prescribed in the operating instructions manual.
 - d. Any unauthorized repairs.
 - e. Any alteration or modification made to the Product.
 - f. Exterior finish or cosmetic damage.
 - g. Normal usage wear and tear, finishes or consumables.
 - h. Corrosion, rusting or stains.
 - i. Improper transportation, inappropriate storage conditions or materials, improper ventilation, reconfiguration of the Product.
 - j. Operating the Product in an unattended manner.
 - k. Lacking of periodically Product servicing and preventative maintenance.
 - l. Losses, damages, defects and malfunctions caused by fire or acts of God.
07. This limited warranty does not apply/cover for:
 - a. Parts requiring replacement due to normal wear and tear, corrosion or stain.
 - b. Damage due to usage of other incompatibility equipment/solutions/accessories being used in conjunction with the covered Product.
 - c. Transportation, delivery and incidental cost incurred in fulfilment of this limited warranty. The purchaser/user shall be fully responsible for the due delivery of the Product for any repair work to novita and for the subsequent collection. Any Product to be repaired must be sent to the service centre directly. No outdoor servicing will be provided. novita can provide collection and return service and a transportation fee of S\$36 is applicable.
08. To the fullest extent permitted by law, novita shall not be in any way liable for any incidental or consequential, direct, indirect damages whatsoever caused by the breach of any express, implied or statutory warranty or condition. Except to the extent prohibited by applicable law, any implied warranty or condition of merchantability of fitness for a particular purpose is limited in duration to the duration of the above limited warranty. novita disclaims all other warranties, conditions or representations, express, implied, statutory or otherwise. novita shall not be liable for any damages of any kind resulting from the purchase, use or misuse of, or inability to use the product including incidental, special, consequential or similar damages or loss of revenue or profits, failure to realize savings or other benefits, or for any breach of contract, fundamental or otherwise, or for any claim brought against purchaser/user by any other party, regardless of the legal theory on which the claim is based, and even if novita has been advised of the possibility of such damages.
09. Without limiting the generality of the foregoing, the purchaser/user assumes all risk and liability for loss, damage or injury to the purchaser/user and their property and to any third parties and their property arising out of the use, misuse, lack of periodic servicing and proper maintenance or inability usage of the novita Product.

10. This limited warranty will be invalidated and rendered void upon the usage of any non-original filters/parts/accessories that is not approved by novita for the use with the product.
11. This limited warranty is void if the serial number on the Product had been removed, erased, defaced, altered, tampered or is illegible.
12. novita will repair or replace this product at their option and at no charge with new or reconditioned parts or Product if found to be defective during the limited warranty period specified above. novita does not warrant uninterrupted or error-free operation of the product. All replaced Product or part, or fully refunded Product, shall become the absolute property of novita and must be returned to novita. Replacement parts and Products assume the remaining original limited warranty.
13. In the event that the Product is out of stock, obsolete or beyond repair, novita reserves all rights to replace the Product with another similar value as deem appropriate, subject to availability. In no event shall any recovery against novita exceed the actual price paid for the purchase of the Product.
14. novita reserves all rights to impose charges for services on the Product which are outside the perimeter of limited warranty coverage. novita also reserve the right to decline Product servicing where the Product is obsolete, no longer deemed serviceable or replaceable for any reason.
15. If any section, provision, clause, sentence or part thereof of this limited warranty is held to be void, invalid or unenforceable, it shall be modified necessarily to make it valid and enforceable, and it shall not in any way be affected or impaired thereby.
16. novita shall reserve the right to modify or change the terms and conditions herein due to change(s) in availability of Products and/or spare parts or for the purposes of complying with applicable policies, rules, regulations and law, without prior notice.
17. With the proceeding of the Product usage, it means the purchaser/user have read, understood and agreed on the novita's Product usage and limited warranty terms and conditions and also acknowledged that novita's limitations of liability are reasonable and within the context and circumstances under which it is applied on.

LIMITED WARRANTY EXTENSION - EXTENDED WARRANTY

- Extended limited warranty is offered for all other parts (excluding compressor) repair or replacement after 1 year of the standard limited warranty period, subjected to all of the terms, conditions and limited to standard limited warranty coverage. Extended limited warranty is not applicable for the compressor warranty for the 4th year - after the compressor's standard 3-year limited warranty term expires.
- Extended limited warranty is available for purchase within the 1-year standard limited warranty period at estore.novita.com.sg/nd-services.
- An order confirmation email will be sent to your registered email address within 7 working days after receiving the extended limited warranty purchase order and payment and the system will be updated within 14 working days.
- Extended limited warranty commencement date is inferred from product purchase date or installation; notwithstanding the extended warranty purchase date.

MODEL	HumiControl™ Dehumidifier ND390i-LCD
NEXT 12 MONTHS STANDARD EXTENDED LIMITED WARRANTY	S\$85/Unit

• All Information is accurate at the point of print. novita reserves all rights to update the information without prior notice.

eStore 
novita 



 **novita.com.sg**

COPYRIGHT © 2021 NOVITA SG

SV/M/ND390i-LCD/V1