



AAVANTE BAR ORION PLUS

Thank you for choosing the boAt Aavante Bar Orion Plus as the audio source for your home. You are a step away from the realm of pure audio bliss. Stay plugged into the sound with an array of wired connections, USB port, and wireless Bluetooth v5.3 technology. This 2.1 channel soundbar with a wired Subwoofer provides balanced sound for movies, music, and even video games where you can experience cinematic sound that revolves around you. We recommend that this manual be carefully read for proper usage and referred to in case of difficulties.

Package Contains:

- 1X Soundbar
- 1X Wired Subwoofer
- 1X AUX Cable
- 1X User Manual
- 1X Remote Control
- 1X Wall Mounting Accessories
- 1X Warranty Card
- 1x Power Cable

USER MANUAL

SAFETY & WARNINGS

Caution

To reduce the risk of electric shock, do not dismantle the product and do not expose the apparatus to rain or moisture. The unit has no user-serviceable parts inside. Refer servicing to qualified personnel only

The lightning flash within an equilateral triangle is intended to alert you to the presence of uninsulated dangerous voltage within the product's enclosure that may be of sufficient magnitude to constitute an electric shock to a person or persons.

Important! This symbol alerts you to read and observe important warnings and instructions on the unit or in this manual.

Notice:

This appliance is not intended for use by persons (including children) with reduced physical sensory or mental capabilities, or lack of experience and knowledge, unless they have been given supervision or instruction concerning use of the appliance by a person responsible for their safety.

1. To prevent possible hearing damage, do not listen at high volume levels for long periods of time or a sudden high volume level.
2. Never use the device unsupervised! Switch off the device whenever you are not using it, even if not using it only for a short while.
3. The appliance is not intended to be operated by means of an external timer or separate remote controller system.
4. If the power supply cord is damaged, it must be replaced by the manufacturer, its service agent or similarly qualified persons in order to avoid a hazard.
5. Before operating this system, check the voltage of this system to see if it is identical to the voltage of your local power supply.
6. The unit should not be impeded by covering the ventilation opening with items such as newspaper, table-cloths, curtains etc. Make sure that there are at least 20 cm of space above and at least 5 cm of space on each side of the unit.
7. The apparatus must not be exposed to dripping or splashing. Do not place objects filled with liquids such as vases, bottles or humidifiers on the unit.
8. To prevent fire or shock hazard, do not expose this equipment to direct heat, rain, moisture or dust.

9. Do not place this unit near any water sources e.g. taps, bathtubs, washing machines or swimming pools. Ensure that you place the unit on a dry, stable surface.
10. Do not place this unit close to a strong magnetic field.
11. Do not place the unit on an amplifier or a receiver.
12. Do not place this unit in a damp area as the moisture will affect the life of electric components.
13. Do not attempt to clean the unit with chemical solvents as this might damage the finish. Wipe with a clean, dry or slightly damp cloth.
14. When removing the power plug from the wall outlet, always pull directly on the plug, never pull on the cord.
15. Depending on the electromagnetic waves used by a television broadcast, if a TV is turned on near this unit while it is also on, lines might appear on the LED TV. Neither this unit nor the TV is malfunctioning, if you see such lines, keep this unit away from the TV set.
16. The mains plug is used to disconnect the device, the disconnected device should remain readily operable.

IMPORTANT SAFETY INSTRUCTIONS

1. Read, keep, and follow all instructions. Heed all warnings.
2. Avoid dropping. Do not disassemble.
3. Do not use any corrosive cleaner/oil to clean. Clean only with a dry cloth.
4. Do not submerge in water; do not use this appliance near water. The product should not be exposed to dripping or splashing water.
5. Do not block any ventilation openings. Install it in accordance with the manufacturer's instructions.
6. Avoid extreme temperatures. Do not install near any heat sources such as radiators, heaters, stoves, or other apparatus (including amplifiers) that produce heat.
7. Protect the power cord from being walked on or pinched, particularly at plugs, convenience receptacles, or where they exit from the appliance.
8. Only use original or certified cables or attachments/accessories specified by the manufacturer.
9. Do not use the device outdoors during thunderstorms. Unplug this appliance during lightning storms or when unused for long periods of time.
10. Refer all servicing to qualified service personnel only. Servicing is required when the appliance has been damaged in any way, for example, when the power-supply cord or plug is damaged, liquid has been spilled or objects have fallen into the appliance, the appliance has been exposed to rain or moisture, does not operate normally, or has been dropped.
11. The AC plug is used to disconnect the device; the disconnected device should remain readily operable. In order to disconnect the device from the AC power completely, the AC plug must be removed from the AC outlet completely.

UNPACKING AND SET UP:

- Remove the Soundbar from the carton and remove all packing material from the Soundbar. Save the packing material, if possible, in case the Soundbar ever needs to be serviced or transported. The original carton and packing material are the only safe way to pack your Soundbar to protect it from damage in transit.
- Remove any descriptive labels or stickers on the front or top of the cabinet. Do not remove any labels or stickers from the back or bottom of the cabinet.
- Place your Soundbar on a level surface such as a table, desk, or shelf, convenient to an AC outlet, out of direct sunlight, and away from sources of excess heat, dirt, dust, moisture, humidity, or vibration.
- Unwind the Line cord connecting the AC adapter and extend it to its full length.

INSTALLATION - FREE STANDING

This soundbar can sit free-standing on a surface, or it can be mounted to a wall.

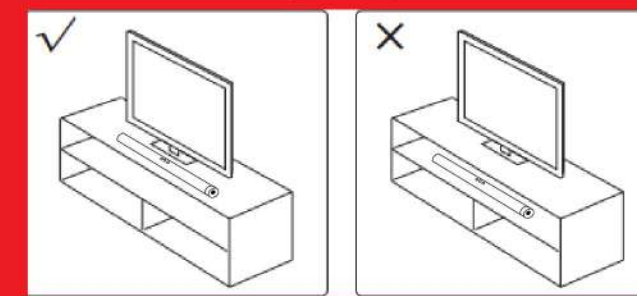

- Place the soundbar horizontally on a flat surface such as a TV unit or shelf and align it centrally with the TV screen.
- Allow some space between the speaker and the wall.
- Don't place it inside a cabinet or a wall shelf. Follow this guidance for the best sound output and good airflow around the soundbar.

INSTALLATION – MOUNT ON THE WALL

Wall mounting instructions are as follows:

- If you don't feel confident to correctly and securely wall-mount the soundbar, Seek the assistance of an experienced person of professional.
- Install the speaker on a vertical, fast, reinforced area of the wall.
- For plaster walls, it is recommended to screw into wall studs for greater security.
- For optimum performance, allow at least 25mm/1" distance between the soundbar and the TV.

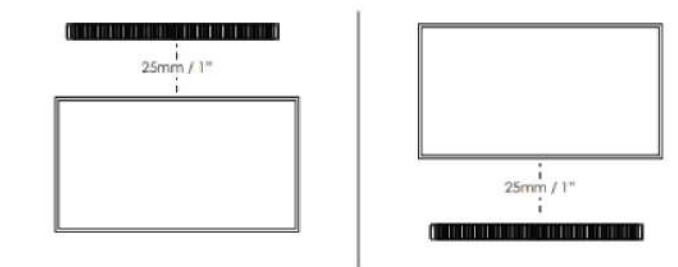

INSTALLATION – WALL MOUNT

1. Open 4 holes in the wall referring to the iron bracket for wall mounting, the spacing distance of the holes in the wall is corresponding to the symmetrical position on the soundbar. (When measuring the position of wall mounting, avoid the soundbar pads put on the iron bracket, because the pad is not flat, and will not be sticky well on the double-sided tape on the bracket.)
2. Fix the plastic anchor in the 4 holes of the wall mounting bracket.

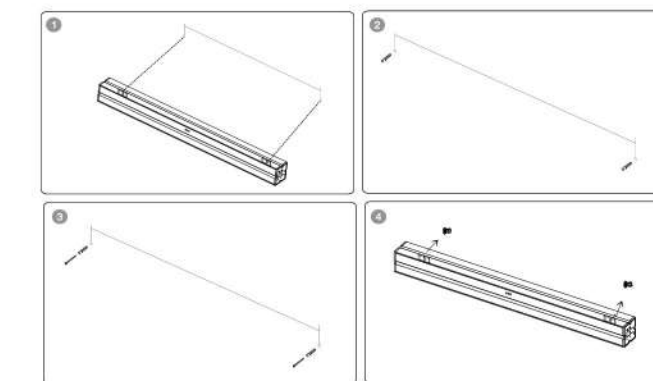

3. Then fix the supplied screws on the plastic anchor and tighten the screws to ensure that the wall mounting bracket will not shake.
4. After fastening the screws, tear off one side of the two double-sided tapes in the supplied packaging, and paste them on the right and left into the extension of the wall brackets according to the suitable position where the Soundbar is on the iron bracket.
5. Then tear off the other side of the double-sided tape attached to the iron bracket, place the Soundbar on the double-sided tape on the metal fittings, press it firmly, and release it until it is completely stuck.

CONTROLS & CONNECTION

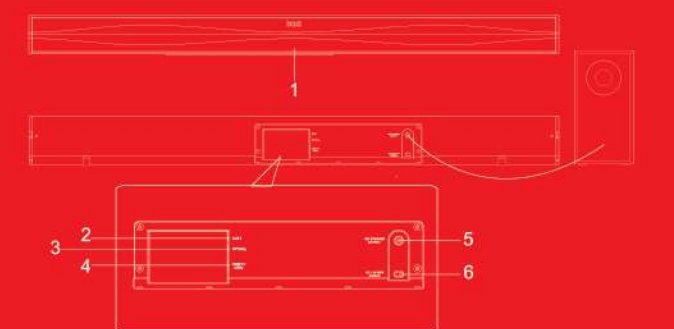

1. Display
2. AUX
3. Optical
4. HDMI TV (ARC)
5. SW Speaker Output
6. AC110-240 V 50/60Hz

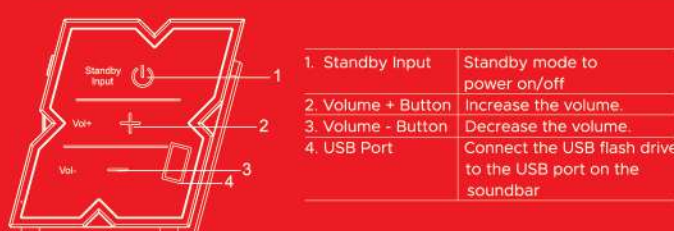

1. Standby Input
2. Volume + Button
3. Volume - Button
4. USB Port

REMOTE CONTROL BATTERY SETUP AND REPLACEMENT

Please insert the batteries as shown below

Step 1: Remove the battery compartment cover.

Step 2: Insert two AAA batteries according to the polarity markings (+ / -) inside the compartment. Make sure the batteries are correctly aligned and properly pushed into place.

Step 3: Close the battery compartment.

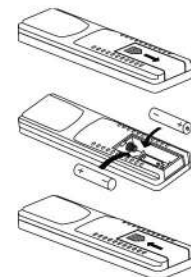

Precautions When Using Batteries:

- Do not use old and new batteries together.
- The batteries must not be exposed to excessive heat such as sunshine, fire etc.
- Do not use different types of batteries together.
- Install the batteries correctly as per the polarity markings to prevent battery leakage.
- Remove the batteries from the remote if you do not intend to use it for a long time.
- When discarding used batteries, follow the guidelines for recycling and disposal of batteries that apply in your local area.
- Keep batteries away from children and pets.

OPERATING RANGE OF THE REMOTE CONTROL

When the unit is mounted on a wall, point the remote control at the remote control sensor on the panel. The provided Remote Control allows the unit to be operated from a distance.

Even if the Remote Control is operated within the effective range of 26.2 feet (8m), remote control operation may be impossible if there are any obstacles between the unit and the remote control.

If the Remote Control is operated near other products which generate infrared rays, or if other remote-control device using infrared rays are used near the unit, it may operate incorrectly. Conversely, the other products may operate incorrectly.

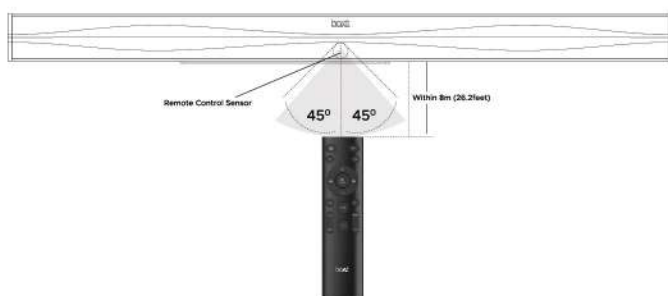

REMOTE CONTROL OVERVIEW

1. Power Button: Standby mode for power on/off.
2. PAIR: Connect or disconnect to the pairing device.
3. Volume+: Master volume up
4. Pre button: Previous program (Only work under USB & BT Mode).
5. Volume- : Master volume down
6. MUSIC: Select the Music EQ mode.
7. TR+: Treble volume up.
8. TR-: Treble volume down.
9. MUTE: Mute mode.
10. INPUT: Input mode (AUX/USB/HDMI TV (ARC)/OPT/BT).
11. Next button: Next program. (Only work under USB and BT mode).
12. Play/Pause: (Only work under USB and BT mode).
13. MOVIE: Select the Movie EQ mode
14. NEWS: Select the News EQ mode
15. Bass +: Treble volume up
16. Bass -: Treble volume down
17. 3D: Select the 3D EQ mode.

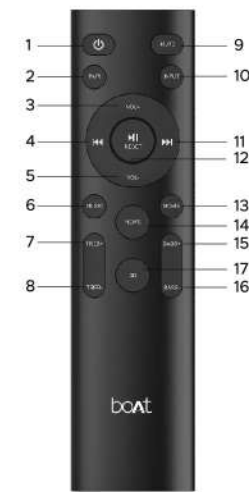

OPERATION GENERAL OPERATION

Function	Action
Turn the soundbar ON	Press the \odot button on the top of the soundbar or press the (POWER) button on the remote control to switch the soundbar on.
Turn the soundbar OFF	Press and hold the \odot button on the top of the soundbar or press the (POWER) button on the remote control to switch the soundbar off.
Change the input source/mode	When the soundbar is on, press the INPUT button on the remote repeatedly to change the input source.
Increase/Decrease the volume	Press the + / - buttons on the soundbar or the VOL + / VOL - buttons on the remote control to adjust the volume level

INPUT MODE

Mode	Description
HDMI (ARC)/Optical	Audio from TV (via HDMI ARC port or OPTICAL jack)
Bluetooth	Sound from a Bluetooth-connected device
USB	Sound from a USB storage device
AUX	Sound from a connected device (via AUX port)

AUTO STANDBY

1. The unit will automatically turn to standby mode when no audio input is received for 20 minutes. The soundbar will wake up from standby mode when any button is pressed, or source input is received.
2. If the TV or the external unit is disconnected, switch off the soundbar. To switch the unit off completely, remove the mains plug from the mains socket. Please turn the unit off completely to save energy when not in use.
3. The screen will be turned off for around 20 seconds without any operation, when pressing the power buttons on the soundbar or on the remote control or using the volume button, the display will be awakened up again.

BLUETOOTH PAIRING

Connect the Soundbar to your Bluetooth device (such as an iPad, iPhone, iPod touch, Android phone, or laptop), and then you can listen to the audio files stored on the device through your Soundbar speakers.

1. Turn on the soundbar and short press the INPUT button repeatedly on the unit or the INPUT button on the remote control to switch the soundbar to Bluetooth mode. The LED display on the soundbar will flicker in the Bluetooth pairing mode.
2. On the Bluetooth device, switch on the Bluetooth, search for and select "Aavante Bar Orion Plus" on your Bluetooth list to pair. If prompted for a password, please use "0000".
3. Wait until you hear a sound prompt from the Soundbar. The LED will stop flickering once the pairing is done and BT will be displayed on the display panel of the soundbar.

Note:

- Remove Aavante Bar Orion Plus from your device's Bluetooth history and ensure it's less than 8 meters away. Then try pairing again. To get the best sound quality, make sure there is a clear line of sight between the connected device and your soundbar.
- If your pairing device or connected device is switched off or manually disconnected, the soundbar will automatically enter pairing mode.
- The music streaming may be interrupted by obstacles between the device and soundbar, such as a wall, metallic casing that covers the device, or other devices nearby that operate at the same frequency.
- If you want to connect your Soundbar with another Bluetooth device, press, and hold Pair on the remote control to disconnect the currently connected Bluetooth device.

PLAYING VIA USB PORT:

The soundbar automatically switches to USB input mode with the LED display USB when a USB flash drive is inserted (this mode isn't selectable on the soundbar or remote control unless a USB flash drive is connected).

1. Ensure that your USB flash drive contains MP3 audio files (other file types not supported)
2. Connect the USB flash drive to the USB port on the soundbar (or your own USB extension cable connected to the USB port); music will automatically play with an LED display "00:00", when music is played, the play time will be automatically displayed on the screen.
3. Press the VOL +/- buttons to adjust the volume to your desired level.

PLAYING VIA AUX MODE:

Use a 3.5mm to 3.5mm audio cable to connect the PC, tablet, smartphone, TV's headphone socket to the AUX socket on the soundbar.

- Use an RCA to 3.5mm audio cable to connect the Blue Ray DVD Player / TV's audio output sockets to the AUX socket on the soundbar.
- Then short press the INPUT button on the soundbar or on the remote controller to switch to audio input mode with LED display lighting up.
- In this mode, playback can only be controlled on your connected device

Note: For some computers, you may need to access the audio control panel to manually set the soundbar as above picture.

PLAYING VIA OPTICAL MODE:

Using an optical cable, connect the OPTICAL connector on your Soundbar (Optical digital input) to the OPTICAL OUT connector on the TV or other device. The TV or other device must have an optical digital output. Proceed as follows:

- Connect the optical cable to the OPTICAL jack on the rear of the soundbar.
- Connect the other end of the optical cable to the audio output jack on the TV or other device.
- Set the TV to PCM Stereo or Stereo 2.0.
- Start playing on the TV
- Press the source input button on the soundbar or remote control to activate the corresponding mode (the OPTICAL mode) to open the optical digital input of your soundbar. After successfully connecting, the LED display will show OPT. Operate your audio device directly for playback features.

PLAYING VIA HDMI TV (ARC) MODE: CONNECT TO HDMI TV (ARC) SOCKET

Some 4K HDR TVs require the HDMI input or picture settings to be set for HDR content reception. For further setup details on HDR display, please refer to the instruction manual of your TV.

- **Option 1: ARC (enhanced Audio Return Channel)**
- Your Soundbar supports HDMI with an enhanced Audio Return Channel (ARC). If your TV is HDMI ARC compliant, you can hear the TV audio through your Soundbar by using a single HDMI cable.
- Use a High-Speed HDMI cable, connect HDMI (ARC) on the soundbar to HDMI (ARC) connector on your TV.
- Then short press the INPUT button on the soundbar or the INPUT button on the remote controller to switch to HDMI (ARC) mode. After a successful connection, the LED display will show ARC. (If TV support ARC, LED display will show ARC.)
- Note: Your TV must support the HDMI-CEC and ARC functions. HDMI-CEC and ARC must be set to be on.
- The setting method of HDMI-CEC and ARC may differ depending on the TV.
- For details about the ARC function, please refer to your TV owner's manual.
- Only HDMI 1.4 compatible cables can support the ARC function.

SPECIFICATIONS:

Model	boAt AAVANTE BAR Orion Plus
Bluetooth Version:	V5.3
Net Weight:	6.60kg
Working Range:	8-10m
Driver Size:	2.25"*4 SB + 6.5inch SW
Working Voltage	SMPS AC 110-240V 50/60Hz
Frequency:	80Hz-20Khz
Output Power:	160W
Compatibility	USB/BT/AUX/Optical/HDMI(ARC)