



DASH 2

WIRELESS KARAOKE MIC WITH SPEAKER

User Manual

1. Package Contents

Karaoke Microphone with Speaker	1IN
Type-C Cable	1IN
User Manual	1IN

2. Features

• Bluetooth 5.3

Just connect with your smartphone and play wireless karaoke and music with built-in DSP(Digital Signal Processing) effect.

• Aux-in

Start singing or recording by connecting 3.5mm headphones and the device.

• FM transmission mode

The FM Car system/speaker can scan this Microphone transmit FM frequency(FM87.9, FM88.5, FM89.7)

• Headphone mode

The audio and singing will play through headphones instead of the microphone.

• TWS (True Wireless Stereo) Function

The Dash 2 can be paired to another Dash 2 over Bluetooth and play with an enhanced sound output, it is also perfect for singing duets.

• Voice Cancelling Feature

With voice cancelling function can eliminate vocals in songs, and turn songs into backing tracks

• Multiple Lighting modes

With 4 lighting modes:
Flow, breathing, nightlight, and rhythm

• Multiple Sound modes

With 4 Sounds Modes:
Speech, original sound, karaoke and professional

3. Product Specifications

Bluetooth Version : 5.3

Bluetooth Profiles : A2DP, AVRCP

Bluetooth Frequency : 2.4GHz

Bluetooth Chipset : MV silicon BP1048B2

Aux In:3.5mm

Battery Capacity : 3.7V 2500 mAh, 9.25Wh

Battery Type : Lithium 18650 battery

Input Rating : DC 5V 1A

Microphone Polar Pickup : condenser

Microphone Sensitivity : -40DB

Microphone Frequency Range:100HZ-20KHZ

Microphone Impedance : 2.2KΩ

Microphone working mode : Speech, original sound, karaoke, professional

Speaker Driver : 52mm full range driver*1

Speaker Output Power : RMS 7.5W, MAX 10W

Speaker Frequency Range : 130HZ-20KHZ

Speaker Impedance : 3 Ω

LED Light Modes : Flow, breathing, nightlight, and rhythm

Charging time : 3.5h @ 5V 1A

Total Playing / Usage time : 3 hours @100% volume; 10 hours @ 50% volume;

Charging cable length : 1m

Dimensions : 75*72*204mm

Net Weight : 335g

Charging jack : USB C

Bluetooth Distance : Single mode at 10m, TWS mode 5m

4. Slots and Keys Explained

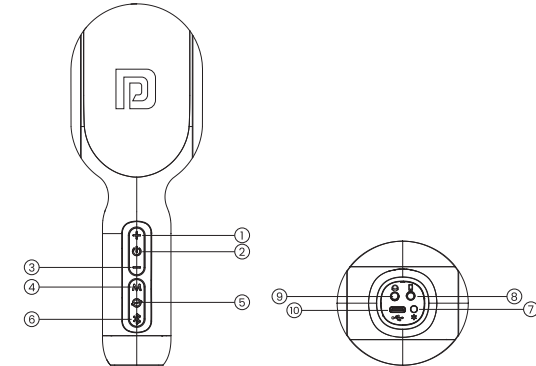

1. +

Long press for 2s: Next track
Short press: Volume up for Microphone/speaker

2. ⏻

Long press for 2s: Power on/off
Short press: Switch music volume/microphone volume

3. —

Long press for 2s: Previous track
Short press: Volume down for Microphone/speaker

4. M

Long press for 2s: Turn on the FM transmitter, broadcast and switch FM frequency(FM87.9, FM88.5, FM89.7)
Short press: Switch Microphone working mode

5. ⏻

Long press for 2s: Suppress the vocal in music
Long press for 2s: Restore the vocal in music

6. ✖

Long press for 3s: Get into TWS mode and search for another Dash 2 to connect
Short press twice: Disconnect the paired Bluetooth device

7. ☀

Long press for 2s: Turn on/off the LED lighting
Short press: Switch LED light modes (Flow, breathing, nightlight, and rhythm)

8. Ⓜ

Aux in port

9. Ⓜ

Headphone port

10. Ⓜ

Type C Charging port

5. How to operate?

1. Power on/off

1) Long press Ⓜ button for 2s to power on/off the microphone.

2) There are 4 sound effects on the microphone: Karaoke, Professional, Speech, and Original Sound.

3) Short press Ⓜ the button to switch between sound effects.

2. Bluetooth

1) Turn on Bluetooth from your Android/iOS smartphone. In bluetooth search look for "Dash 2". Upon successful connection, the voice prompts "Bluetooth connected" followed by a light indication.

2) Please turn on your phone's music player, and the speaker will play the selected music.

3) The speaker will pair with the latest used Bluetooth device automatically. Short press Ⓜ button twice to disconnect the current Bluetooth connection to pair other Bluetooth devices that can connect with speaker.

4) Turn on the karaoke/music applications on your device and start your singing. Short press Ⓜ button to select music volume or microphone volume, then press the volume +/- button to adjust the volume.

5) If there is no signal input for 20 minutes, the microphone will shut down automatically.

3. TWS(True Wireless Stereo) function -

Please note this works for Duet mode(only works in Bluetooth mode)

1) Power on the Dash 2, search Dash 2 from your device and click to connect.

2) Power on the second Dash 2. Long press simultaneously the Ⓜ button of two microphones for 3s prompted by "searching for connection" and then both will prompt "TWS channel" to pair in the TWS/duet mode.

3) Once two microphones are paired, the two microphones' Ⓜ button lights will stop twinkling. The microphone connected to your device is the master one.

4) 2pcs Dash 2 TWS paired before will paired automatically when 2pcs Dash 2 re-powr on.

5) Long press the Ⓜ button for 3s on either microphone to disconnect the TWS pairing.

6) In TWS mode, if one of them is powered off, the other will also be powered off.

4. Aux in Mode

1) Insert the AUX cable to connect the microphone with your device, and 3.5mm headphones

Insert the microphone's headphone port.

2) Power on the microphone.

3) Turn on the karaoke/music applications on your device and start your singing or recording.

NOTE:

1. The AUX Mode is for voice recording, and supports original sound effects only.
2. The audio won't play through the microphone, please insert the 3.5mm headphones as well.
3. Unplug the AUX cable, the microphone will switch to Bluetooth Mode automatically.

5. Headphone Mode

1) Power on the microphone and connect it to your device via Bluetooth.

2) Insert the 3.5mm headphones into the headphones port.

3) Turn on the karaoke/music applications on your device and start your singing or recording.

NOTE:

The audio and your singing will play through the headphones instead of the microphone in this mode. Enjoy your private singing time.

6. FM Transmitter

1) Power on the microphone.

2) Long press the Ⓜ button for 2 seconds to turn on the FM transmitter, and the microphone will broadcast to the current frequency.

3) Long press the Ⓜ button repeatedly for 2s switch the frequency of the microphone, or adjust the frequency on your device/car to match the microphone's.

NOTE:

1. There are 3 FM frequencies to choose from: 87.9MHZ, 88.5MHZ, 89.7MHZ.
2. Make sure the FM frequencies are the same as your devices (Car FM or other radio products), one frequency is allowed to match at a time.

7. Charging

1) The microphone will prompt "battery low" every 5 minutes once the battery is under 10%. The lighting will be flashed in red at the same time. Please charge the battery via an adaptor/charger immediately.

2) Charging is indicated by red light. When fully charged, the red indicator light shuts off.

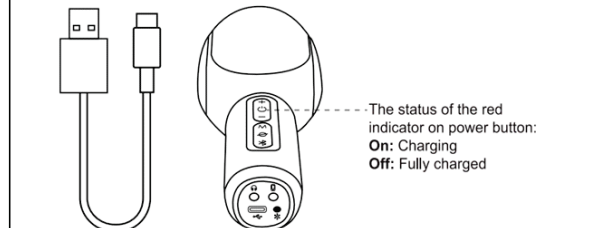

NOTE:

1. Please use a good-quality adaptor to charge the speaker. We suggest using the adaptor specification at 5V/1A.
2. When a speaker with low battery capacity, please charge the speaker immediately.
3. Do not charge in a sub-zero environment, charging below zero may cause damage to the battery.
4. Do not use the microphone while charging, the output power is lower than normal working status.
5. When the battery is under 30%, the power of the microphone will be automatically reduced to protect the battery and avoid voice distortion.

Important Safety Instructions

- Do not use the speaker in extremely cold or hot environments.
- Please avoid the speaker dropping or getting hit with a hard object, it may damage the hardware.
- Be cautious when charging the speaker, excessive or prolonged charging will damage the battery lifetime.
- Charge the speaker to full capacity when using for the first time.
- When the battery is low, the lighting will be flashed in red and the voice prompts "battery low", please charge the speaker in time.
- If you do not use this speaker for a long time, then please charge it at least once within one month. In order to prevent the lithium battery from getting damaged.
- Adjust the volume to the appropriate level to avoid disturbing others.