

Warranty Registration Card

2 +3 Year Warranty

Whirlpool Washing Machine Warranty Registration Card

Serial Number Model

Date of Purchase: _____

Original Purchaser: _____

Address: _____

Contact No: _____

Dealer's Name: _____

Address: _____

Dealer's signature _____ Purchaser's Signature _____

With rubber stamp 1* 2yr Comprehensive Warranty
3 yr Extended Warranty on Wash Motor and Prime Mover only

**Note: 1. Please retain the bill of purchase.
2. Please quote Serial Number, Model and Date of purchase in all your correspondence**

WHIRLPOOL OF INDIA LIMITED (WOIL)
warrants to the original purchaser of the Whirlpool washing machine, provided the washing machine is still in the possession of and is being used by the purchaser, from the date of purchase.

2 YEARS COMPLETE WARRANTY FOR WASHING MACHINE
The washing machine and all parts hereof (except the top, lid assembly, control panel, window, knobs, escutcheon, cabinet, dispenser assembly, drain hose, lint filter, castors/wheels/ foot and other plastic parts) to be free from defects in material and workmanship under normal use and service. WOIL's obligation under this warranty shall be limited to repairing or providing replacement of any part (except the top, lid assembly, control panel, window, knobs, escutcheon, cabinet, dispenser assembly, drain hose, lint filter, castors/wheels/foot and other plastic parts) of the said washing machine which thus proves defective within two years from the date of original purchase and which on WOIL's examination discloses to its satisfaction to be thus defective.

3 YEARS EXTENDED WARRANTY ONLY ON WASH MOTOR AND PRIME MOVER*****
The Prime Mover*** and Wash Motor** to be free from defects in material and workmanship under normal use and service. WOIL's obligation under this warranty shall be limited to repairing or providing the replacement of Prime mover*** and/or wash motor** with another in working condition which thus proves defective within 3 years commencing immediately after the expiry of the 2 year period from the date of purchase and which on WOIL's examination discloses to its satisfaction to be thus defective. This warranty covers only motor** and prime mover***.

*** Prime mover : Prime mover (Impeller/Agipeller) is a wash plate which rotates water & clothes.
** Motor : Wash motor only.

The 2 year Warranty will automatically terminate on the expiry of the warranty period of two years from date of purchase and extended warranty on Prime Mover** and Wash Motor** will also automatically terminate on the expiry of 3 years which commences immediately after the expiry of 2 years from the date of purchase as provided in the original invoice, even if the washing machine may not be in use for any time during the warranty period for any reason whatsoever including any technical breakdowns and the time taken for such repairs / replacements of parts and transit, whether under this warranty or otherwise shall not be excluded from the warranty period.

13

Limitations of Warranty

- This contract does not apply if:
 - damage is caused by accident, misuse, improper installation or neglect in following instructions of the user manual issued by WOIL.
 - damage is caused due to defects in electrical installations of fittings outside the washing machine or by any defective electrical supply.
 - damage is caused by rodents/insects, accident, misuse, fire, flood or other acts of God.
 - any part of the washing machine has been tampered with, altered, repaired or serviced by any person not authorised by WOIL.
 - the serial number on the washing machine is defaced, missing or altered.
 - sea water or any substituted detergent has been used in the washing machine.
 - The washing machine is taken out of India.
 - Leakage is due to Coin Entry / Foreign Particles entry.
 - the Product is not used as per the guidelines and instructions given in use and care guide.
- In the event of repairs/replacement of any parts, this warranty will there after continue to remain in force only for the remaining warranty period.
- While WOIL will make every effort to carry out repairs/replacement of parts under this warranty as soon as possible, it is expressly made clear that WOIL shall not be liable to do so within any specified period of time.
- This warranty is not applicable if the washing machine is used for commercial purposes or at places like institutions, hospitals, community hall, hostels and other similar applications.
- This warranty will continue to be in force for the term here in specified, irrespective of whatever repairs / replacements provided under it and such repairs / replacements shall not attract any fresh warranty.
- In case of any replacement of any part or entire product, the defective part or entire product should be returned to WOIL.
- WOIL's employees and/or dealer have no authority to vary the terms of this warranty. This warranty does not create any contractual relationship between us and the purchaser of the washing machine, who must look to the performance obligations of the dealer from whom the washing machine is bought. We shall, however, fulfill the terms of the warranty.
- This warranty will automatically terminate on the expiry of the warranty period of two years, even if the washing machine may not be in use for any period during the warranty period for any reason whatsoever including any technical breakdowns and the time taken for such repairs / replacements of parts and transit, whether under this warranty or otherwise shall not be excluded from the warranty period.
- It is entirely left to WOIL's discretion to effect repairs/replacement of parts at the site of installation or at any service centre of it's branches or Authorized Representatives' Dealers.
- Under the terms of warranty, free service will be provided only within Municipal limits of the locality and where the Service Centre of WOIL or its authorised representative/dealer is available. Free services outside the Municipal limits specified above, will be provided after charging the actual fee and for travelling and other incidental expenses, as prevailing from time to time.
- Any repair/replacement/refund shall be chargeable as per actual cost of such repair, replacement, etc., where any damage to the product occurs due to any of the following reasons.
 - House wiring issues
 - Rat bite issues on wiring harness
 - Coin/Foreign particles entry
 - Choke due to fluff / Muck accumulation
 - Inlet water pipe re-fixing
- The Warranty does not cover any accessories external to the product, like trolleys, covers, etc. even those marketed by Whirlpool.
- Only courts in National Capital Region Of Delhi or Gurgaon shall have jurisdiction for settling claims or disputes arising out of present warranty.

14

Installation Report - Company Copy

WHIRLPOOL OF INDIA LIMITED - CONSUMER SERVICE DEPT.

Model: _____ Serial No. _____
Customer ID: _____ SR No. _____
Customer Name: _____
Tel No: _____ Address: _____
Machine Delivered on: _____ Machine Installed on: _____

Washing Machine Package Contains **Tick Appropriately (By Technician)**

- Received following items - Water Inlet Pipe, Spin cap, User Manual Yes No
- Condition of Earthing / Plug Point Good Poor
- Warranty Terms & Conditions explained Yes No
- Deletergent usage Recommendation explained Yes No
- Basic Demo Given for Hot Wash, if applicable Yes No
- Thermal Cut out Explained Yes No
- Advised to Turn off the machine after use Yes No
- Inlet hose checked for water leak after connection Yes No

Demonstration

- Any Transit damage Observed after unpacking Yes No
- Condition of Earthing / Plug Point Good Poor
- If Poor, has customer been advised on action to be taken? Yes No
- Warranty Terms & Conditions explained Yes No
- Deletergent usage Recommendation explained Yes No
- Basic Demo Given for Hot Wash, if applicable Yes No
- Thermal Cut out Explained Yes No
- Advised to Turn off the machine after use Yes No
- Inlet hose checked for water leak after connection Yes No

Explanation

- Usage of Washing Machine Yes No
- Wiring and Voltage Condition Good Poor
- If Poor, has customer been advised on action to be taken? Yes No
- Leveling the Machine Yes No
- Explained proper cloth separation for the best wash Yes No
- Clothes Loading pattern Yes No
- During wash, clothes to be evenly distributed around Agipeller / Impeller Yes No
- Explained hanging of wet hose to tap Yes No
- Spin Cap usage & importance Yes No
- Heater Function (if applicable) Yes No
- Explained Lint filter cleaning method & frequency Yes No
- Explained hanging of lint filter to tap Yes No
- Explained Drain Hose positioning - Flat on ground Yes No
- Additional Drain Hose added Yes No
- Explained all features of the machine to customer Yes No
- Explained regular check up and Safety instruction Yes No
- Explained that Washers should not be exposed to direct sunlight and rain Yes No
- Dis & Don'ts Yes No

Name of SP: _____ Installation Date: _____ Installed By: _____

Customer Voice - Your feedback matters !!!

- The Installation Person is Courteous & Helpful Satisfied Not Satisfied
- I would Describe my Experience with installation Satisfied Not Satisfied
- I confirmed my warranty by calling Whirlpool call center, post installation. Satisfied Not Satisfied

I certify, that the above information & demonstration has been done to my satisfaction & I am fully satisfied with the appliance

Customer Signature: _____ Date: _____

15

Spin Drying Process



- Loading the clothes into spin basket**
 - Open the spin tub lid.
 - Transfer the clothes to the spin basket.
 - Distribute the clothes evenly in the basket.
 - Before closing the spin lid, press the spin cap down on the clothes.

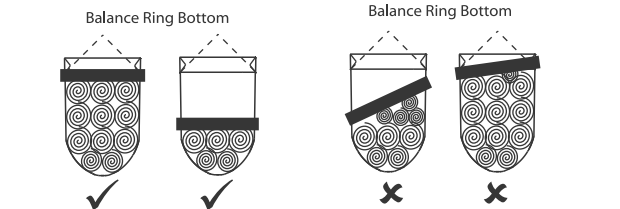

- Closing the lids**
 - First, close the inner lid and then close the spin lid.
 - The machine will not spin if the spin lid is either open or not closed properly.

- Spin Drying**
 - Set the dryer to the desired spin time as shown in the table below.

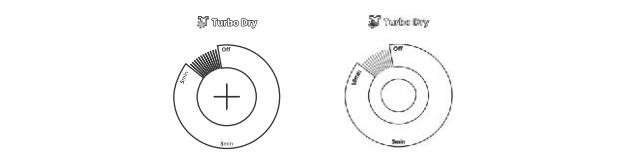

Fabric type	Spin duration
Clothes that wrinkle easily (Synthetic, Fibres, Delicate Material, Sarees)	3 minutes
Clothes that do not wrinkle easily (Cotton Shirts, Cotton Pants, Bed Spreads)	5/10* minutes

* 10 min Spin timer available only in 8.5/9.0 Kg Models

- Note:**
- Spin drying without spin cap may cause cloth entry between spin basket and tub
 - Hang the clothes to dry immediately after spin to avoid excessive wrinkles on the fabric.
 - Do not run spin continuously for more than 3 cycles. If spin is operated continuously for more than 3 cycles, motor thermal cut out (a safety feature) may happen resulting in non functioning of spin. If this happens, give a time gap of 25 minutes and restart the spin process.

16

Easy Trouble shooting that keeps you in control

Simple Tips For Trouble - Free Performance

Foreign object entrapment
Please ensure that you empty all pockets of objects such as coins, pens, toothpicks, matchsticks etc. They may get stuck inside the machine and could even cause damage your clothes

Metallic buckles / zippers
All metallic buckles / zippers must be closed before putting clothes into the washing machine. Open buckles and zippers could damage/scratch inner plastic parts of the machine.

Lint
Separate white coloured clothes from the rest of the laundry when washing. Always ensure that "lint producing" clothes (e.g. towels, cotton, clothes) are separated from "lint attractors" (e.g. Synthetic fibers, black colour garments, woollen clothes). Make sure that you put the recommended amount of detergent for each wash load.

Tangling
Do not stuff clothes or wrap them around the agitator. Drop them loosely around the agitator / Impeller.

Electrical
Kindly ensure that the household electrical wiring and earthing is proper. plug point must be intact.

Prolonged Non usage
In case of prolonged non-usage of machine, please run the machine with plain water (without clothes) for 2 minutes and drain out the used water. This will ensure that residual detergent etc, if any, gets discharged from your machine.

Rodents
Protect your machine from Rodents. Rat bites can damage the wiring leading to Short circuits or general non - functioning of the machine.

19

Service at your doorsteps



RECOMMEND - INSTALLATION BY WHIRLPOOL SERVICE FOR FREE INSTALLATION, DEMONSTRATION & SERVICE
SMS WPL to 58558
CALL 1800 208 1800 (Toll Free)
Email: helpdeskindia@whirlpool.com

Shifting your Whirlpool Washing Machine

It is essential to pack the machine properly before it is moved from one place to another to prevent any damages in transportation. This becomes most essential when you move the machine from one city to another.

To pack of machine properly. Kindly contact your authorized Whirlpool of India Limited branch or dealer office in your city. During the warranty period whenever the machine is shifted from the original city of purchase to another, a warranty transfer fee of Rs. 200/- will be collected. This also includes the machine reinstallation charge.

In addition to proper packing, it is important to ensure for any transit damages. Damages to the machine during transportation by the customer is not covered under warranty provided by Whirlpool of India Limited.

Chargeable calls

House Wiring Issues

Damage caused due to house wiring issues such as short circuit leading to general non - functioning of the machine.

Rat bite issues on wiring harness

Damage such as short circuit leading to general non - functioning of the machine due to rat bite on wiring harness.

Coin Entry / Foreign Particles Entry

Noise caused or machine not working due to coin / Foreign Particles Entry.

Cleaning

Machine internal cleaning

Cloth Entry

Damages caused due to cloth entry such as spin bellow wear off & spin. Drying not working.

20

ACE XL



Specifications

MODEL NAME	ACE XL		
WASH CAPACITY in "kg"	8.5/9.0 Kg	9.5 / 10.5 kg	
WASHING RATE	120 rpm		
SPIN SPEED	1400 +/- 25 rpm		
MACHINE WEIGHT in "kg"	26	32	
WATER PRESSURE in "kg/cm ² (kpa)	0.15 - 1.0 (14.7 - 98.06)		
WATER LEVEL in "ltrs"	HIGH 1	73	95
	HIGH	65	81
	MEDIUM	55	69
	LOW	45	57
	D (V. Low)	35	45
MACHINE DIMENSIONS in "mm"	HEIGHT	965	1020
	WIDTH	886	940
	DEPTH	515	567
INPUT POWER	WASH MOTOR	350 W	375 W
	SPIN MOTOR	150 W	250 W

Circuit Diagram

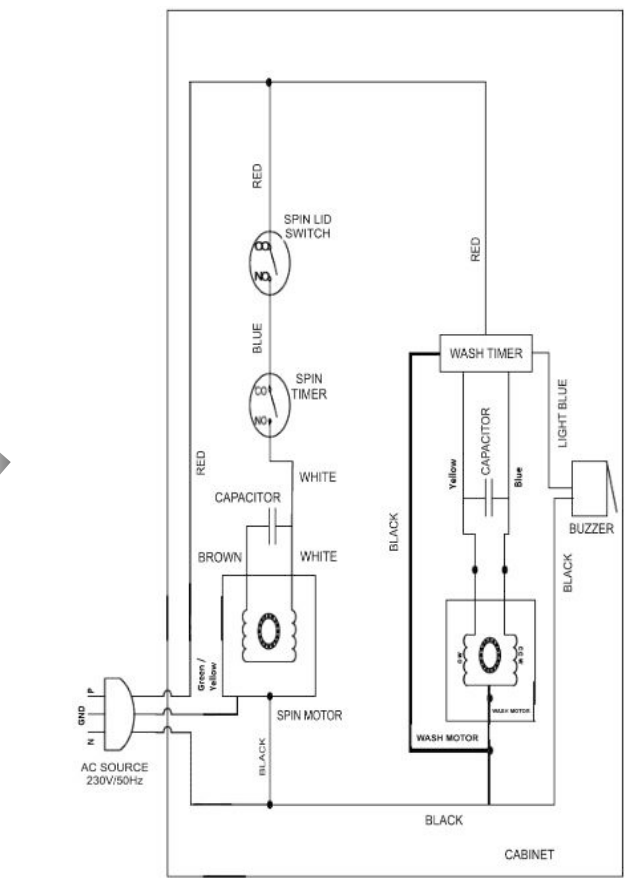

ACE XL Stainfree* : 8.5, 9.0, 9.5 & 10.5 Kg models removes tough stains like Ketch Up, Chocolate, Crayon, Mosquito Repellent, Butter, Honey, Deodorant, Oil, Softener Stains, Fruit Jam, Fruit Juice, Soft Drinks Stains, Snack Stains.

Note:
The results may vary due to water quality & detergent used.

The best performance is guaranteed if you use the appropriate amount of detergent. Use four scoops (1-140g) of advanced compact detergent for the wash process.

*You have to use the Stainfree wash within 48 hours of the clothes getting stained

Whirlpool
Manufactured by:
Whirlpool of India Limited
Thirubhuvaneswari Village, Puthucherry - 605107, India
Please call : 1800 208 1800 (Toll Free)
Write us : helpdeskindia@whirlpool.com

WH1177901

17

18

21

22

CONTENTS

Welcome To Whirlpool Family	2
Let's Get Started & Package Contents	3
Installation Of Whirlpool ACE XL	4
Safety Precautions	5
Features	6
Know Your Washing Machine	7
Control Panel	8
Washing Process	9
Rinsing Process	11
Installation Report – Customer Copy	12
Warranty Registration Card	13
Limitation Of Warranty	14
Installation Report – Company Copy	15
Spin Drying Process	16
Maintenance Of Your Whirlpool Ace Washing Machine	17
Easy Trouble Shooting To Keep You In Control	18
Service At Your Door Steps	20
Specifications	21
Circuit Diagram	22

ACE XL



Dear Homemaker,

Congratulations on your new appliance and welcome to the Whirlpool family of homemakers. We believe that happiness begins at home and aim to have our products deliver the very best for a happier home.

At Whirlpool, we endeavor to make your life easier and more enjoyable with an extended range of products from Washing Machines, Refrigerators, Cooking Products and Air Conditioners to Water Purifiers and Built-in Appliances. Always helping you to make a happier home.

Please go through this Use & Care guide to know your appliance better and simply call the Whirlpool Home Care Center, in case of any queries.

We look forward to years of happiness and a lifelong relationship with you and your family.

Yours Sincerely,

Head Marketing
Whirlpool of India Limited

Safety Precautions

Take note of the following safety precautions and maintenance suggestions

Note : Remove coins from the pockets of clothes before loading into the machine.

Features

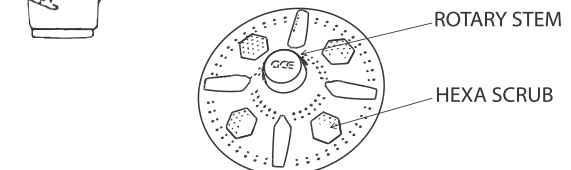

3D Turbo Impeller (Stainfree Models) :
The new 3D Turbo Impeller provides superior washing performance through the unique action of hexa scrub pads & rotary stem. It gently rotates the clothes & also repeatedly moves them up and down, resulting in better scrubbing & optimal washing action.

Rotary Stem :
The Rotary Stem gently rotates the clothes & repeatedly moves the laundry up & down in the wash tub ensuring that even the toughest of dirt is removed from your clothes.

Agipeller (Turbodry Models):
Agipeller with five vanes will give better scrubbing action & Roll-over movement of clothes, resulting in better wash quality.

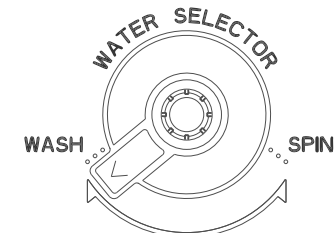

Rotary Inlet :
Whirlpool's unique Rotary Inlet system allows you to guide the water flow to Wash Tub & Spin Tub.

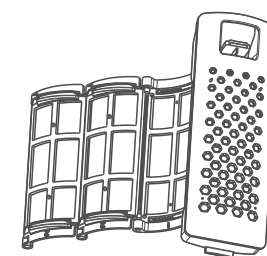

3D Lint Filter :
Whirlpool's unique 3D Lint Filter ensures near Zero Lint residue giving better cleaning performance.

Washing Process

- Preparation before Wash**
 - Connect one end of a fill hose to a water tap and other end to the water inlet.
 - Unhook the drain hose and place it flat on the floor
 - Plug in the power cord properly into an electrical socket.
 - Shirt collars, cuffs, dress hem and pockets have to be pre-treated before washing, by brushing them with a pre-wash product or liquid detergent.

2. Selecting the Wash process

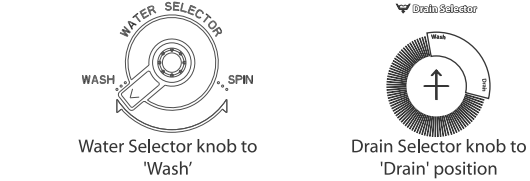

3. Loading the clothes into your machine

- Hang the Wash Lid in the side wall of the Wash tub as shown in the figure in Page 7
- Check for coins/pins/sharp foreign objects before loading the clothes into your machine.
- Drop clothes loosely around the Agipeller / Impeller
- Load the clothes uniformly in the Wash tub. Do not load clothes on one side of the machine

4. Adding Detergent

- As per the table below, sprinkle detergent inside the tub before loading the clothes.

Fabric Type	Water Level	WASH PROGRAM - DELICATE & GENTLE			
		Load in Kg	Detergent Quantity (Cup)	Water in L	Water in L
Wool	L	2.5-3.5	1.5	1.5	45
Wool	M	2.5-3.5	1.5	1.5	45
Wool	H	2.5-3.5	1.5	1.5	45

Fabric Type	Water Level	WASH PROGRAM - NORMAL*			
		Load in Kg	Detergent Quantity (Cup)	Water in L	Water in L
Wool	L	3.5-4.5	2	2	50
Wool	M	3.5-4.5	2	2	50
Wool	H	3.5-4.5	2	2	50

Fabric Type	Water Level	WASH PROGRAM - STAINWASH			
		Load in Kg	Detergent Quantity (Cup)	Water in L	Water in L
Wool	L	3.5-4.5	2	2	50
Wool	M	3.5-4.5	2	2	50
Wool	H	3.5-4.5	2	2	50

* 1 typical cup = 35 gms.

Note : Foam overflow may occur if more than the recommended quantity of detergent is used, especially with high foaming detergents.

Rinsing Process

A good wash is incomplete without a proper rinse. Not only does a thorough rinsing help you to clean off minute traces of dirt, it also removes the detergent water, which could be harmful to your precious clothes and your skin.

Method 1 : Rinse in Wash Tub

- Draining the detergent water
 - Set the drain selector to the drain position
 - It will take about 3 mins for the detergent water to drain.
- Selecting the rinse process
 - Set the drain selector to the Wash position



- Filling water into the washing machine
 - Open the water tap and fill the tub to a suitable water level for the rinse load
 - Ensure that the clothes are fully submerged in water. Before start of rinse close the tap.
- Rinsing your clothes
 - Set the dirt level selector to 5-8 mins. The machine will start rinsing thereafter.
 - Drain the rinsed water by using Drain selector as in Point 1 above

Note : For complete soap removal, please rinse in the wash tub only. You have the option of using the following alternate method to ensure removal of detergent. Ensure that the drain hose is placed on the floor.

- Method 2 : Rinse in Spin Tub**
 - Move the clothes from the wash tub to the spin tub
 - After setting the water selector to 'Spin', open water tap for 4 to 5 minutes and then set the spin timer to 5/10 minutes for effective spin shower
 - The spin shower ensure a better quality rinsing of your clothes and also makes sure that the detergent is effectively removed
 - We recommend that one round of rinsing is done in the wash tub before loading the clothes in to the spin basket.

Note : User discretion is advised in selecting the rinsing method. It is recommended to avoid spinning the tub, when the water tap is open. This will ensure that water reaches all fabric inside the basket, before spinning begins.

Method 3 : Over flow rinse in wash tub

- Draining the detergent water
 - Set the drain selector to the drain position
 - It will take about 3 mins for the detergent water to drain.
- Selecting the Rinse process
 - Set the drain selector to the Wash position
- Filling water into the washing wash tub.
 - Open the water tap and fill the tub to a suitable water level for the rinse load

- Ensure that the clothes are fully submerged in water before star of rinse.
- Rinsing your clothes
 - Set the dirt level selector to 5-8 mins. The machine will start rinsing thereafter.
 - Continue the water supply throughout the cycle for a best rinse.
- Drain the water by using Drain selector as in Point 1 above

Note : This method consumes more water than the previous methods.

Let's Get Started

- Get the machine installed by a Whirlpool technician.
- Ask for the demonstration of the machine.
- Check the 'Installation Report' to ensure that it is completed and sign it before the technician takes it away.
- Read the manual carefully – clarify with the technician while installing.
- Check the Warranty card and understand the term of Whirlpool Offers*
- Look for the machine number and model number written on a rectangular plate at the back of the machine and note this down on your Warranty Card. This number must be quoted at all times when you contact Whirlpool – that will speed up your response.

For Mobility



For mobility, lift the machine minimum 170mm (as shown in image) by using the handle.

(For all ACE XL 9.5 & 10.5 Kg Stainfree Models)

Installation of Whirlpool Ace XL

ELECTRICAL CONNECTIONS

- Ensure that the earth connection in your electrical supply is proper before connecting the power cord. The socket should be of standard and independent 3 pin type of 230V, 5A connection with a separate line fuse or circuit breaker of the value 5A.
- The appliance must be earthed properly. Do not use an extension junction box as it may not be earthed properly.*
- If the power cord is damaged, it must be replaced by the Whirlpool Authorized Service Person in order to avoid hazard.
- Do not install in an environment where there is a possibility of water splashing onto the machine.
- Do not expose the machine to direct sun light or rain.
- Do not install the machine in a damp place or bathroom.

*The manufacturer declines any responsibility for damage caused due to non-compliance with this caution. You are therefore advised to check that your household electricity supply is properly earthed.

INSTALLING THE MACHINE

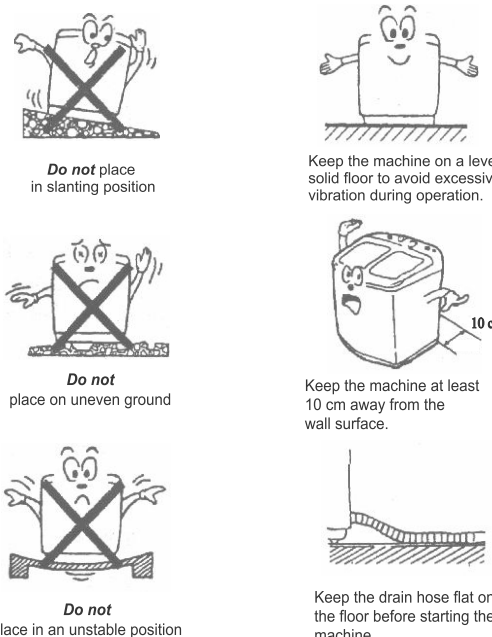

Know your Washing Machine

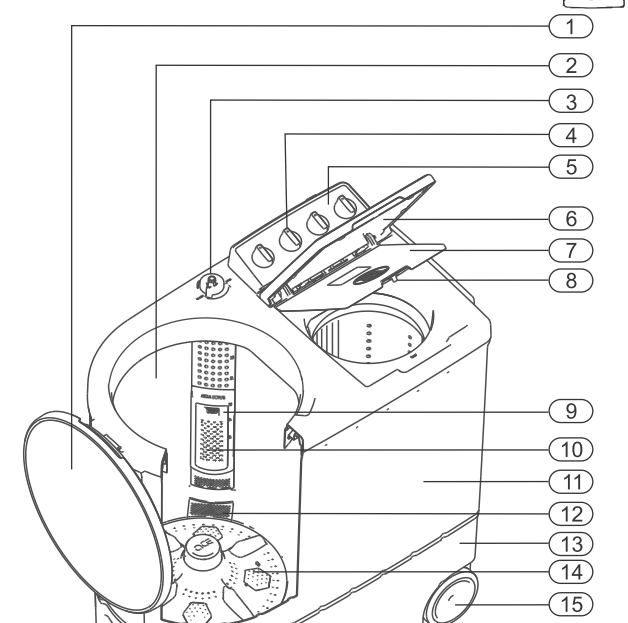

- Wash Lid
- Wash Tub
- Water Selector
- Knob
- Decorative Panel
- Spin Lid
- Spin Inner Cover
- Spin Lid Handle
- Water Level Indicator
- Cover Lint Filter
- Tub
- Strainer
- Under base
- Impeller
- Big Wheel

The following items are included in the package. If something is missing, please contact the retail outlet / service centre number.

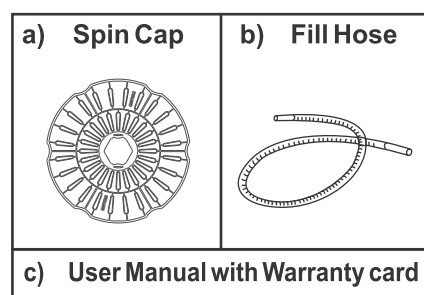

Control Panel

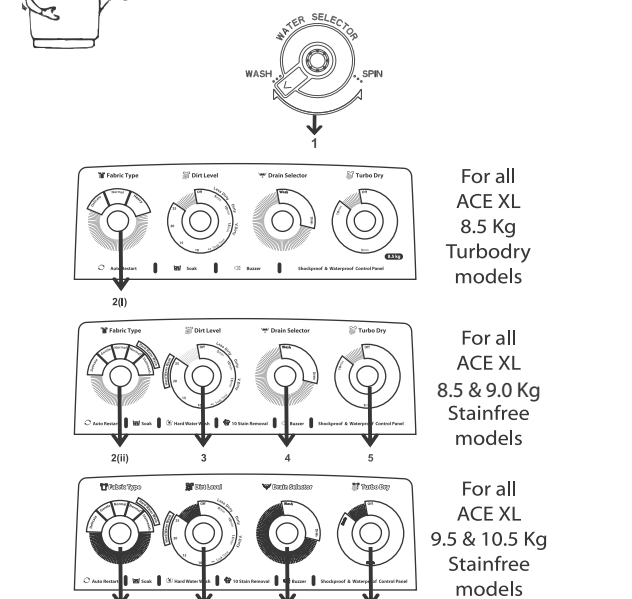

- Water Selector :** Rotate this knob to fill water in Wash Tub or Spin Tub.
 - Fabric Type Selector – 3 & 5 Wash Program :**
 - Use this knob to select the Fabric type like Delicate, Normal & Heavy
 - Introducing a special program for Tough Stains and Hard water wash.
- Stainwash**
- This special program removes select stains from heavy clothes like cotton, etc.
- Hard Water Wash**
 - We understand that water hardness may vary from region to region and if hardness id high, you will not get a good wash performance.
 - We have introduced unique Normal* and Stainwash programs for Hard Water Wash. The machine adopts a different agitronic wash profile with extended soak giving you the best Wash Performance.
 - Dirt Level Selector :** Use this knob to set the time for Wash/Soak according to the dirt level of the clothes.
 - Wash/Drain Selection :** Use this knob to drain the water from the Wash Tub.
 - Dryer :** Use this knob to set the time for drying according to Fabric Type.

Note : The images shown are only schematic representation of the machines. They do not replicate the exact model.

Washing Process

- Filling Water**
 - Open the water tap and fill water in the wash tub to a suitable water level for the wash load.
 - Ensure to replace the wash lid over the top of the tub before starting the wash.
- Adjust the Tap to reduce the water pressure:**
 - If water splash is observed.
 - If water filling in wash tub and spin tub is observed at the same time

6) Washing your clothes

- Before starting the wash timer ensure all clothes are fully submerged in water.
- Select a suitable wash program depending on the Fabric Type & Dirt Level.

Note : If water level selected is 'Low' use either 'Delicate' or 'Normal' wash programs.

Soak* can be selected as an option. You can soak clothes max. of 25 min. before washing.

Turn the wash timer / dirt level selector clockwise until you reach the desired wash timer position. The Wash action starts as soon as the wash time is set.



Images used on this page are only for illustration purpose

Installation Report - Customer Copy

WHIRLPOOL OF INDIA LIMITED - CONSUMER SERVICE DEPT.

Model: Serial No.

Customer ID SR No.

Customer Name

Tel No Address

Machine Delivered on Machine Installed on

Washing Machine Package Contains Tick Appropriately (By Technician)

1. Received following items - Water Inlet Pipe, Spin cap, User Manual	Yes	<input type="checkbox"/>	No	<input type="checkbox"/>
Demonstration				
1. Any Transit damage Observed after unpacking	Yes	<input type="checkbox"/>	No	<input type="checkbox"/>
2. Condition of Earthing / Plug Point	Good	<input type="checkbox"/>	Poor	<input type="checkbox"/>
If Poor, has customer been advised on action to be taken?				
3. Warranty Terms & Conditions explained	Yes	<input type="checkbox"/>	No	<input type="checkbox"/>
4. Detergent usage Recommendation explained	Yes	<input type="checkbox"/>	No	<input type="checkbox"/>
5. Basic Demo Given for Hot Wash, if applicable	Yes	<input type="checkbox"/>	No	<input type="checkbox"/>
6. Thermal Cut out Explained	Yes	<input type="checkbox"/>	No	<input type="checkbox"/>
7. Advised to Turn off the machine after use	Yes	<input type="checkbox"/>	No	<input type="checkbox"/>
8. Inlet hose checked for water leak after connection	Yes	<input type="checkbox"/>	No	<input type="checkbox"/>
Explanation				
1. Usage of Washing Machine	Yes	<input type="checkbox"/>	No	<input type="checkbox"/>
2. Wiring and Voltage Condition	Good	<input type="checkbox"/>	Poor	<input type="checkbox"/>
If Poor, has customer been advised on action to be taken?				
a. Phase & Neutral <input type="checkbox"/> V				
b. Phase & Earth <input type="checkbox"/> V				
c. Neutral & Earth <input type="checkbox"/> V				
3. Levelling the Machine	Yes	<input type="checkbox"/>	No	<input type="checkbox"/>
If Poor, has customer been advised on action to be taken?				
4. Explained proper cloth separation for the best wash	Yes	<input type="checkbox"/>	No	<input type="checkbox"/>
5. Clothes Loading pattern	Yes	<input type="checkbox"/>	No	<input type="checkbox"/>
During wash, Clothes to be evenly distributed around Agipeller / Impeller				
6. Spin Cup usage & Importance	Yes	<input type="checkbox"/>	No	<input type="checkbox"/>
Dump spin, place Heavy Clothes at bottom of spin basket and lighter clothes above them				
7. Heater Function (if applicable)	Yes	<input type="checkbox"/>	No	<input type="checkbox"/>
8. Explained Lint filter cleaning method & frequency	Yes	<input type="checkbox"/>	No	<input type="checkbox"/>
9. Explained fixing of Inlet hose to tap	Yes	<input type="checkbox"/>	No	<input type="checkbox"/>
10. Explained Drain Hose positioning - Flat on ground	Yes	<input type="checkbox"/>	No	<input type="checkbox"/>
11. Additional Drain Hose added	Yes	<input type="checkbox"/>	No	<input type="checkbox"/>
12. Explained all features of the machine to customer	Yes	<input type="checkbox"/>	No	<input type="checkbox"/>
13. Explained regular check up and Safety instruction	Yes	<input type="checkbox"/>	No	<input type="checkbox"/>
14. Explained that Washers should not be exposed to direct sunlight and rain	Yes	<input type="checkbox"/>	No	<input type="checkbox"/>
15. Do's & Don'ts	Yes	<input type="checkbox"/>	No	<input type="checkbox"/>

Name of SP Installation Date Installed By

Customer Voice..... Your feedback matters !!!

1. The Installation Person is Courteous & Helpful	Yes	<input type="checkbox"/>	No	<input type="checkbox"/>
2. I would Describe my Experience with Installation	Satisfied	<input type="checkbox"/>	Not Satisfied	<input type="checkbox"/>
3. I confirmed my warranty by calling Whirlpool call center, post installation.	Yes	<input type="checkbox"/>	No	<input type="checkbox"/>

I certify, that the above information & demonstration has been done to my satisfaction & I am fully satisfied with the appliance

Customer Signature Warranty is not applicable in case:

Name : - This product is not used as per installation guidelines/usage explanation, beyond 360 days from purchase.

Date : - Changeable situations as explained in user and care guide.