

FINISHING TOUCH™
FLAWLESS
NU RAZOR™

**NO WATER
NO SOAP
NO CREAMS**



READ ALL INSTRUCTIONS BEFORE USING THIS PRODUCT

- Use on clean, dry skin. No water, soap or creams should be used.
- **Prior To First Use** test on small, discreet area and wait 10 minutes.
- If sensitivity or allergic reactions occur, discontinue use immediately.
- Use the optional SensaGuard cover for sensitive areas.
- As with all razors/shavers, use with caution.

USING NU RAZOR

- Before first use, fully charge the unit.
- Use on clean, dry skin. No water, soap or creams should be used.
- On sensitive areas like under arms and bikini area, use the SensaGuard attachment (Image 1).
- Glide lightly over dry skin. Pressing hard may reduce cutting performance and cause irritation.
- Shave back and forth.

SENSAGUARD – USE ON SENSITIVE AREAS –

- Align the tabs on the SensaGuard attachment to the tabs on the head of the Flawless Nu Razor™ device (Image 2).
- Press onto the head until you hear it click into place (Image 3).
- Use the SensaGuard attachment for sensitive areas like under the arms and the bikini area.
- To remove, place your thumb on the center of the head while lifting the corner of the SensaGuard attachment and releasing it from the head (Image 4).

NOTE: Some areas can be sensitive. Please use the SensaGuard attachment and be gentle.

CHARGING / RECHARGING

1. Make sure the unit is turned off.
2. Insert charging cable as shown. Insert USB end into USB compliant power adapter (image 5).
 - Only use with charging cable provided.
3. The LED light will flash while charging.
4. Once the unit is completely charged, the light will become solid and will stop flashing.
5. Remove charging cable from power adapter, then from the unit.
 - Approximate charging time is 3 hours.

NOTE: The unit won't operate while charging.

OPERATING TIME

- The unit has an operating time of approximately 60 minutes.
- If the unit begins to slow down, clean the head. If still slow, charge unit.

REMOVE AND REPLACE HEAD

- Remove any attachments.
- Place your thumb at the base of the head and press upward while holding the sides of the head to prevent falling (Image 6).
- Hold the new head by its sides and press onto the neck of unit. There will be a “click” when the head is secure (Image 7).

NOTE: The Replacement Head is not included.

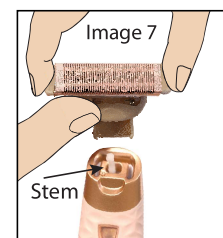
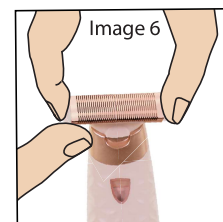
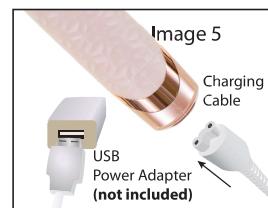
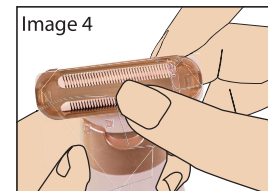
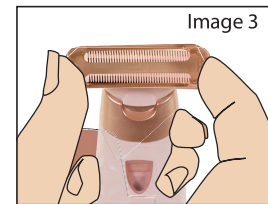
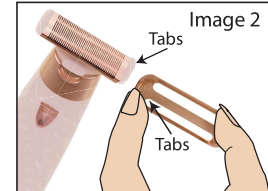

FINISHING TOUCH®
FLAWLESS
NU RAZOR™

CARE AND MAINTENANCE

- Never use harsh liquids such as alcohol, acetone or nail polish remover to clean the unit.
- Clean the unit after every use.
 1. To clean, turn the unit off. Remove the SensaGuard if still attached to the head.
 2. Blow off any hair and debris which remain after use.
DO NOT tap the cutting head on a hard surface, as it may cause damage.
 3. Switch the unit on and run only the shaving head under lukewarm water for approximately 10 seconds. Do not fully submerge head in water.
 4. Turn the unit off and carefully shake off the excess water.
Set unit aside and allow to air dry completely.
 5. Store unit and accessories in a dry, safe place.

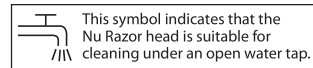

NOTE:

- The Finishing Touch Flawless Nu Razor™ head is precision crafted and can be damaged if you drop, or bang it. Care should be taken during use and cleaning. Always check the unit for damage before each use. Replace a damaged shaving head immediately.
- This product has no other user-serviceable parts. Contact Flawless Customer Service for further assistance.

IMPORTANT SAFETY INSTRUCTIONS

WHEN USING AN ELECTRICAL PRODUCT, BASIC PRECAUTIONS ARE REQUIRED TO ALWAYS BE FOLLOWED, INCLUDING THE FOLLOWING:

DANGER

To reduce the risk of electrical shock:

- Do not reach for the unit if it has fallen into water while charging. Unplug immediately from outlet.
- The power cord and the accessories connected to it are not for immersion or for use in shower.
- Always unplug product from the electrical outlet/adaptor after charging.
- Do not place or store product where it is able to fall or be pulled into a tub or sink. Do not place in or drop into water or other liquid.
- Unplug this product before cleaning.
- The battery used in this product may present a fire or chemical burn hazard if mistreated. Do not disassemble, heat above 200°F or incinerate.

WARNING

To reduce the risk of burns, fire, electric shock, or injury to persons:

- The appliance is not to be used by persons (including children) with reduced physical, sensory or mental capabilities, or lack of experience and knowledge, unless they have been given supervision or instruction concerning use of the appliance by a

person responsible for their safety. Do not allow children to use or play with product.

- Use this product only for its intended household use as described in this manual.
- Charge only with the charging cable provided with this product.
- Use only with a USB compliant power adapter or a FLAWLESS branded USB power adapter.
- Never charge this product when it has a damaged cord or plug, operate when it is not working properly, after it has been damaged, or after it has been dropped in water. Contact Flawless customer service immediately.
- Always check the shaving head before use. Do not use this product with a damaged or broken shaving head, as it has the potential to result in injury.
- Keep product, charging cord and USB power adapter away from heated surfaces.
- Always attach charging cable to product first then to compliant power adapter, then to outlet. To disconnect, remove adapter from outlet, then remove charging cable from unit.
- Do not operate where aerosol (spray) products are being used or where oxygen is being administered.

SAVE THESE INSTRUCTIONS

Visit www.FlawlessBeauty.com to register your Flawless Nu Razor™ device, purchase an adapter and to sign up for special offers.

Customer Service Contact: 1 (866) 972-4739, CustomerCare@FlawlessBeauty.com.

FCC Statement

This device complies with part 15 of the FCC Rules. Operation is subject to the following two conditions: (1) this device may not cause harmful interference, and (2) this device must accept any interference received, including interference that may cause undesired operation.



Distributed by:

Wayne, NJ 07470

Made in China © 2019 Ideavillage
customerservice@flawlessbeauty.com
FTFLAWNNU030521MW