



**FABER**  
AIR MATTERS

KITCHEN ESSENTIALS

*Inspired by you*

# USER MANUAL FOR CHIMNEYS

Dear Customer,

Congratulations ! You are a proud owner of Faber Kitchenhood. Globally, Faber has millions of smiling satisfied customers and it is our constant endeavour to keep you smiling while you cook.

FRANKE FABER INDIA PRIVATE LIMITED.



Recommended Company



Toll Free Number :1800 209 3484

# CONTENTS

* Faber New Technology	08
* Before Use	10
* Precautions	10
* Installation	11
* General Installation Guidelines	11
* Ducting / Connection	12
* Dimensions	13
* Fitting Chimney	14
* Use Control Panel	14
* Use & Maintenance / Operations	16
* Maintenance	17
* Trouble Shooting Guide	20
* Know Your Kitchen Chimney	20
* After Sales Service	23
* Service Centers	25

## FABER NEW TECHNOLOGY

### World's Only Hood with T2S2 Technology

**Faber 3D Hood Technology :** The new faber 3D hoods are capable of capturing the smoke & fumes in three directions compared to the regular hood where the suction happens only in one direction. In regular hoods , there are chances that the heavy and extra fumes get bypassed. But in the new T2S2 abled technology hoods , there are additional lateral filters are provided which are scientifically placed to capture the fumes the escape the hood's bottom suction.

**Idea of Invention :** In case of existing technology , the smoke / fumed that escape / move out of the area covered under hood , start to rise upwards through sides , and settle near kitchen ceiling . The idea to capture theses escaped fumes led us to undertake this invention.

**Principle :** To provide better air captation using more no. of air inlets which have been positioned scientifically.

#### Features :

- Improved suction capability. Suction from 3 directions using scientifically placed vents cleaner cooking area by absorbing the leftover smoke and fumes from more number of inlets in different directions.
- Cleaner cooking area as no fumes settle on cabinets, ceiling, walls etc.
- Reduction in temperature of cooking area ( hot air which gets accumulated in the upper area of the hood will also be sucked-in from the side vents ).Exception in recirculating mode.
- Easier, faster and improved suction.
- Attractive aesthetics of hood due to side vents on the hood's body giving a premium and designer look.

#### Advantageous Effects :

- **Better efficiency :**Two additional vents available for air inlet, the pressure motors used in the hood will operate at a lower pressure compared to conventional models. Thus the hood will work with overall better efficiency.
- **Reduced air cutting noise :** Reduction in air cutting noise due to lesser pressure inside the hood and more air inlets available to motor from the sides. This helps to lower the resultant noise power.
- **Balanced suction :** In case of a regular hood, if the main filters are not clean, the hood may tend to make more noise due to insufficient air inlet and suction will be hampered. Due to the presence of side vents, the hood will have additional air inlets which will help the hood to perform in drastic conditions.

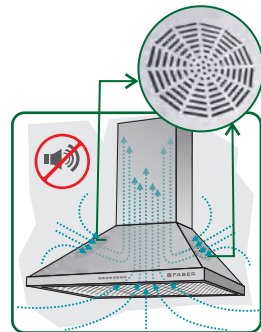
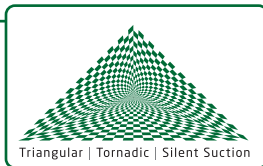

## Smoke Sensor Technology

---

### Step To Activate Smoke Sensor:

1. Turn OFF all the loads, if they are ON eg. Motor, Light
2. Touch the Power Button for more than 3 seconds.
3. The hood shall start at required speed and the same should also be indicated on the display.
4. The sensor is working now and shall not allow the user to manually change the speed. Only lights can be operated in this mode. No special functions will work . eg. 24 Hr , Intensive speed , Delay.
5. Press the Power Button for more than 3 seconds to turn off the auto feature and the hood shall revert to the manual working mode. All special functions will work now.
6. After hood turn OFF , Auto / Sensor mode will be automatically deactivates.

### Precautions:

1. The sensor must not be cleaned or dipped in water.
2. Do not use reactive agents and aerosol products to clean the sensor.
3. Do not tap the sensor on a hard surface.

## World's Only Hood with Spot Cooling Technology.

---

### “ NOW STOP SWEATING IN KITCHEN ”

Faber Spot Cooling Technology providing comfort to user while cooking.

Regular Hood only works to Exhaust smoke & Fume from the kitchen but this technology ensure to provide the clean air during “Spot cooling mode” to the user & reduce tempering problem effectively in addition to it's regular suction operation of smoke & fumes.

## Idea of Invention:

While user cooking into kitchen, It will start hood & it will extract generated smoke & fumes but because of heat generation, after some time user feels uncomfortable & sweaty. To provide pleasant environment while cooking we are presenting this Spot cooling technology.

## Features & Benefits :

- Spot cooling with clean, controlled & directional air flow from front side of hood.
- Clean air flow for user using Air filter placed upper side of hood.
- Control speed of air flow with separate controller.
- Using Vent you can adjust the direction of air.

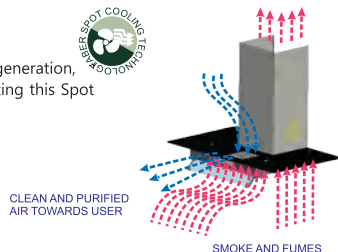

## BEFORE USE

- \* Keep the packaging material out of reach of children.
- \* Please read these instructions carefully and keep them for future reference.
- \* Peel off protective film before using the product for safety.
- \* Your Product Carries A Lifetime Warranty. To Activate The Warranty, Please Refer Steps of Registration.
- \* For Any Further Queries Please Call Faber Care at **1800 209 3484 (TOLL FREE)**

**WARNING !**  
Peel off protective film before using the product for safety.

## PRECAUTIONS

- \* Ensure that the mains voltage corresponds with the recommended voltage of the chimney.
- \* Connect the chimney to the electric supply with proper earthing.
- \* When installed, the minimum gap between the Chimney and the cooking appliance must be at least 65cm - 75cm.
- \* Never leave frying pans unattended during use, as overheated oil may catch fire.
- \* In the Ducting mode, the chimney duct must not be connected to an outlet that is used for exhausting fumes from other appliances like central heating flue.
- \* Before carrying out any maintenance, unplug the chimney from electric supply.



- \* Never use high naked flame under the chimney when it is in operation.
- \* When using a gas hob underneath the chimney, never leave the burner of the hob uncovered while the chimney is in use or when the pans have been removed. Switch-off the burner after usage, never leave the burner "ON", when unattended / not in use.
- \* Always ensure that the appliance is used in accordance with the manufacturer's instruction.



## INSTALLATION

---

- The Faber Baffle Chimney can be installed in one of the two ways : Extraction Mode ( Ducting) Or Re - circulating mode ( Recycling). **All Chimneys perform more efficiently in the Ducting mode.**
- The installation must be done by an authorised service representative , with thorough knowledge of the parameters concerning installation of the chimney.
- Ensure that the installation is carried out as per enclosed general installation guidelines mentioned in the booklet.
- Use recommended size for the outlet duct pipe. A duct pipe with a smaller cross sectional area damages the unit and also invalidates the warranty. Best suited flexible ducting pipes are available with service centers at an additional cost.

## GENERAL INSTALLATION GUIDELINE.

---

\*Except Sunday & Public holidays

- Ensure the installation type of chimney i.e. Recycling or Ducting.
- Mark the standard distance between top of the hob and bottom of the chimney(ideally 65 cm - 75 cm)
- Find and match the center of the chimney and hob.
- As per the size of an easy cube hook , mark holes.
- By making standard holes , fix the wall mounting bracket on the wall.
- Install the chimney on the wall.
- Align the chimney horizontally by adjusting the wall level screw.
- Connect the power supply cord to electrical supply point.
- In ducting mode , after installing the chimney , make the ducting as per company recommended guidelines.
- In recycling mode , install charcoal filter as applicable to model.
- Fix the duct cover.

## DUCTING FOR EXHAUST SYSTEM

---

### Mounting the hood body

Before attaching the hood body, tighten the two screws located on the hood body mounting points.

Hook the hood body onto the screws. 12a

Fully tighten the support screws . 12a

Adjust the screws to level the hood body.

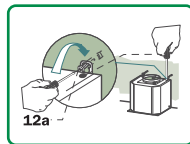

## CONNECTIONS

---

### Ducted Version Air Exhaust System

When installing the ducted version, connect the hood to the chimney using either a flexible or rigid pipe  $\varnothing$  150 or 120 mm, the choice of which is left to the installer.

- \* To install a  $\varnothing$  120 mm air exhaust connection, insert the reducer flange 9 on the hood body outlet.
- \* Fix the pipe in position using sufficient pipe clamps (not supplied).
- \* Remove charcoal

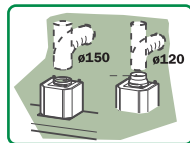

### RECIRCULATION VERSION AIR OUTLET

---

- \* Cut a hole  $\varnothing$ 125 mm in any shelf that may be positioned over the hood.
- \* Insert the reducer flange 9 on the hood body outlet.
- \* Connect the flange to the outlet on the shelf over the hood by using a flexible or rigid pipe  $\varnothing$ 120 mm.
- \* Fix the pipe in position using sufficient pipe clamps (not supplied).
- \* Fix the air outlet grill 8 on the recirculating air outlet by using the 2 screws 12e(2,9 x 9,5) provided.
- \* Ensure that the activated charcoal filters have been inserted.

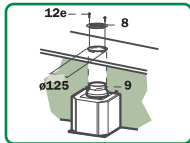

## ELECTRICAL CONNECTION

---

Remove the grease filters (see paragraph Maintenance) being sure that the connector of the feeding cable is correctly inserted in the socket placed on the side of the fan.

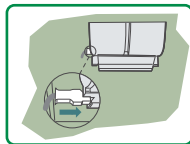



## DIMENSIONS

### Collection Series SIL-K MODELS

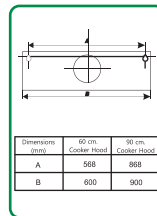
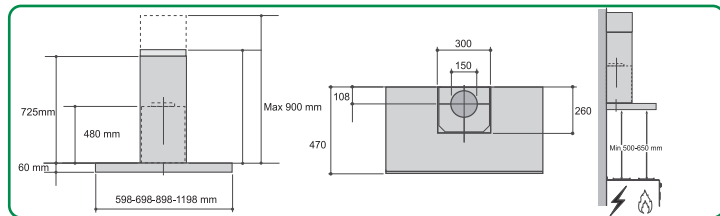

TRADITIONAL

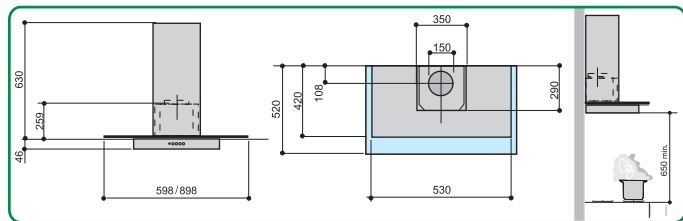

EASY CUBE DECORATIVE MODELS

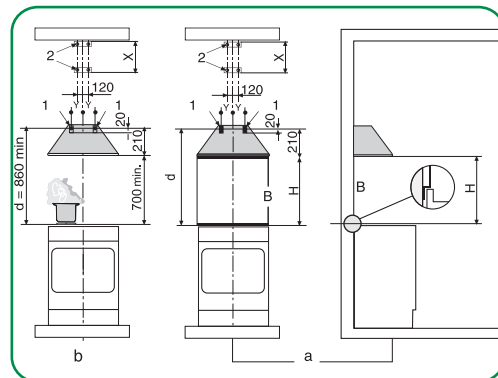

STAINLESS STEEL DECORATIVE MODELS

Dimensions are in mm

## FITTING THE CHIMNEY

### Upper Chimney

- Open the two side pieces out slightly, hook them up behind the bracket 7.2.1 and bring them back together again until they are in contact.
- Fix the upper part of the Chimney to the upper Bracket at the side, using the Screws 12c (2.9 x 9.5) provided.
- Warning: If it has been extended so far that the lower slots in the upper chimney are level with the holes in the bracket, use the screws 12c provided to fix it; otherwise only use the bottom bracket as a stop for the upper chimney.

### Lower Chimney

- Open out the two Chimney side flaps, hook them up between the upper chimney and the wall and then close them up again until they touch.
- Fix the lower part to the Hood canopy at the sides, using 2 screws 12c (2.9 x 9.5) provided.

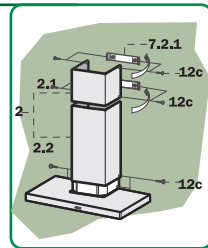

## USE CONTROL PANEL

### Curvy Touch Control Panel



### Stilux DD Touch Control Panel



### Stilux Touch Control Panel

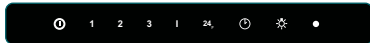

### Cocktail Touch Control Panel

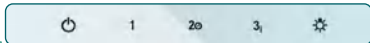

## FUNCTIONS

ⓘ	⏻	A
1	↶	B
2	✖	C
3	✖	D
—		E
+		F

**A:** Turns the motor OFF , it will blink at stand by condition for some models.

**B:** Turns the motor ON at speed one

**C:** Turns the motor ON at speed two

**D:** Turns the motor ON at speed three

**E:** Decrease speed by one level

**F:** Increase speed by one level

**G:** Intensive speed/Maximum hood speed

Stilo Slim DD Soft Touch Control Panel



Backlight Soft Touch Control Panel

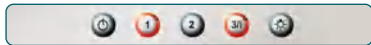

Silk Soft Touch Control Panel

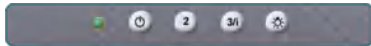

Feather Touch Control Panel

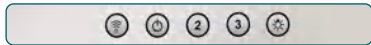

Push Buttons Control Panel

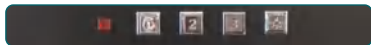

Overlay Touch Control Panel



Aerostation Touch Control Panel



i	G
3/i	H
24	24 <sub>F</sub>
	J
	K
	L
	M
	P
	Q

**H:** When pressed/touched for < 3 sec the hood will start at third speed. When pressed/touched for > 3 sec the hood will start at intensive speed. The hood will remain in this speed for 10 mins. and will come back to the previous speed after 10 mins. The intensive mode can be displayed by pressing/touching the same button for > 3 sec.

**I:** Starts the 24 hr function in which the motor starts at a speed that allows suction of 100 m3/h for 10 minutes per hour. This mode cannot be activated if intensive or delay modes are active. To deactivate it, press the same button or button A. When pressed/touched for > 3 sec, will clear the filter clean indication flashing on the display.

**J:** Activates Delay mode, causing automatic shutdown of the Motor and the Lighting system with a 30' delay. It is disabled by pressing the button or turning the motor OFF. Pressing/touching this button for > 3 sec will Activate/Deactivate the remote control functionality.

**K:** Indication for the location of Infrared remote sensor.

**L:** Press for < 3 sec to turn the lighting system ON & OFF at maximum intensity. Press and hold the button for 2 seconds to turn the Courtesy Lights On (if provided)

**M:** One touch activate Dim Light/Turn Lamp ON, 2nd touch lights OFF (for non-dimming lights)

**N:** Turns the Spot cooling fan and motor on at Speed one & increase the speed.

**O:** Decrease speed & Off the spot cooling fan and motor.

**P:** Motor and Spot cooling fan ON / OFF in Aerostation model.

**Q:** Child lock.

**Note:** N & O functions are applicable for the hood with Spot cooling feature

## IN RE-CIRCULATION MODE:

---

- Check that the activated charcoal filters are properly fitted, so that the vapors and smoke can be effectively absorbed.
- The chimney has to be operated at the lowest speed so that sufficient time is available for the absorption of smoke.
- The activated charcoal filters need periodic replacement and cannot be re-used. The typical life of the activated charcoal filters is 3-5 months, but this may vary depending upon the usage & cooking style / nature of cooking.

## IN DUCTING MODE:

---

- \* Check that the charcoal filters are not attached.
- \* Ensure that the installation is carried out as per general installation guidelines (Ref. Page. No. 11).
- \* Installation must be done by an authorised service representative of Faber.

## USE AND MAINTENANCE

---

For optimum efficiency, ensure that gap between the cooking appliance and the chimney is not less than 65 cm, and not more than 75 cm.

## OPERATIONS

---

Switch control panel - The Chimney can be operated as follows (wherever applicable)

- \* Switch **0** Off
- \* Switch **☸** Illumination
- \* Switch **1** Start / Low speed should be selected when simmering or using only one pan; the noise level is kept to the minimum.
- \* Switch **2** Medium speed should be selected for normal cooking. This ratio between air capacity and noise level.
- \* Switch **3** Top speed should be selected when frying or cooking food with heavy smoke emission, even for a long period.

## MAINTENANCE

Regular maintenance and cleaning will ensure good performance and reliability, while extending the working life of the chimney.

### Baffle Filters

- Have to be cleaned minimum once or twice in 10 to 15 days depending upon usage or more frequently depending on type of cooking.
- These are easily washable with warm water and mild detergent and are dishwasher safe. They can withstand frequent washing cycles.
- Baffle filter can be cleaned as easily as utensils.
- Baffle filters are non-clogging as they use cut & chop technology to separate oil particles from vapours making extraction as effective as possible.

### Charcoal filter

These filters are used in re-circulation mode & are helpful in absorbing cooking odour. The charcoal filter cannot be washed & have to be replaced as soon as they get saturated.

### Air Filter

This filter is used to provide the fresh & clean air during spot cooling operation. The Air Filter Cannot be washed & have to be replaced as soon as they saturated. It is compulsory to use this filter for Spot Cooling feature.

### Cleaning of Hood

- When cleaning the hood unplug the connection of the chimney from the electric supply.
- It is recommended to use a damp cloth and mild liquid household cleaner .
- Never use a wet cloth or sponge or running water.
- Never use thinner or products containing alcohol, as they might damage the exterior paint work.
- Never use abrasive cleaning material, in particular when cleaning stainless steel surfaces (to avoid scratches).

PULL KNOBS



TURN ANTICLOCK



AIR FILTER

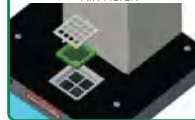

### Benefits of regular maintenance and cleaning.

- Regular cleaning of baffle filter greatly improves the efficiency of the chimney.
- Regular cleaning helps to reduce oil deposition on baffle filters thus avoids the potential danger of electric chimney catching fire.
- Regular cleaning also helps the motor/rotor to remain functional. Initial oil deposits could eventually travel to the motor/rotor, jamming them & making non-functional.
- It is advised to call the authorised service representative regularly to clean the chimney and it's internal assembly\*\*.

## Grease filters

\*\*Prevailing service charges.

### CLEANING METAL SELF- SUPPORTING GREASE FILTERS

- \* The filters must be cleaned every 10-15 days of operation, or more frequently for particularly heavy usage, and can be washed in a dishwasher.
- \* Remove the filters one at a time by pushing them towards the back of the group and pulling down at the same time.
- \* Wash the filters, taking care not to bend them. Allow them to dry before refitting.
- \* When refitting the filters, make sure that the handle is visible on the outside.

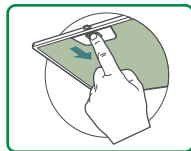

## Anti-odour Filter ( Re Circulation Version)

### CHANGING THE ACTIVATED CHARCOAL FILTER

- \* This cannot be washed or regenerated, and must be changed at least once every 4 months, or more frequently in the case of particularly intensive use.
- \* Remove the Metal grease filters.
- \* Remove the Suction Panel by unfastening the 4 screws at the corners.
- \* Remove the saturated Activated charcoal filter, using the hooks provided.
- \* Fit the new Filter, hooking it into place.
- \* Replace the Panel and the Metal grease filters.

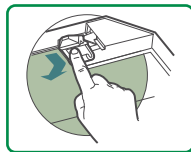

## REMOTE CONTROL ( Optional )

The appliance can be controlled using a remote control powered by a 1.5 V carbon-zinc alkaline batteries of the standard LR03-AAA type (not included).

- \* Do not place the remote control near to heat sources.
- \* Used batteries must be disposed of in the proper manner.

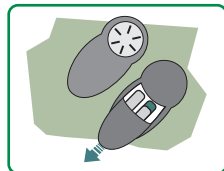

## DISMANTLING/CLEANING SOUNDPROOFING ELEMENTS

- \* Remove the Metal grease filters.
- \* Remove the Activated charcoal filter, using the hooks provided.
- \* Extract the Soundproofing Elements by pressing on them.
- \* Clean them with a damp cloth and replace them, first making sure that they are completely dry.
- \* Replace the Activated charcoal filters.
- \* Replace the Metal grease filters.

**Caution:** Be careful not to damage the Soundproofing Elements.

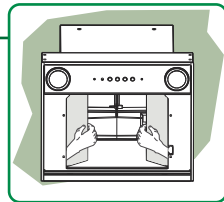

## LIGHTING / LIGHT REPLACEMENT 20 W Halogen light Or LED Filament Lamp

- \* Remove the snap or screw on lamp cover under the support panel.
- \* Remove the Halogen bulb or led filament lamp from the lamp holder by pulling gently.
- \* Replace the lamp with a new one of the same type, making sure that you insert the two pins properly into the housings on the lamp holder.
- \* Fix the lamp cover properly .

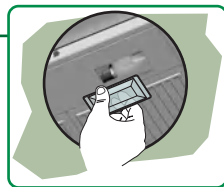

## TROUBLE SHOOTING GUIDE

---

### 1. The chimney does not suck the vaporous / smoke properly:

- Are the Charcoal Filters saturated (In Re-circulation Mode)?
- If Yes, Replace Charcoal Filter. Call Toll free no for replacing charcoal filters.
- Is the outlet of the duct blocked?
- Check and clean the duct.

### 2. The chimney does not start:

- Is there a power failure?
- Is the power supply at the electric supply point proper?
- Has the chimney been "ON" continuously for more than 4 hours, thereby causing the thermal overload protection to trip?
- If this has indeed happened, the chimney will automatically re-start once it has cooled.

## KNOW YOUR KITCHEN CHIMNEY

---

### 1. How does a chimney work?

A chimney is fitted right above the cooking appliance. When switched "ON" it sucks all the oil, smoke, spices etc generated during cooking. The oil gets trapped into modular filters & odour/ smoke is filtered & re-circulated into the room or they are thrown out of room through duct.

### 2. Does a chimney really work? How does it differ from an exhaust fan?

Yes, a chimney is very effective. It not only throws/ purifies the air but it also traps oil & spices. This not only keeps the kitchen air clean it also prevents blackening of walls/ furniture which can't be done by exhaust fan.

### 3. How is it installed?

It can be fitted in ducting or recycling mode. In the ducting mode, heavier particles of oil/grease/spice are trapped in the baffle/mesh filter, and smoke/fumes are ducted out of the house. In case ducting is not feasible, the chimney can also be fitted in a re- cycling mode (except very few models). In this mode, heavier particles of oil/grease/spice are trapped in the baffle / mesh filter and smoke/fumes are filtered through activated charcoal filter. Clean & de-odourised air is then re-circulated into the room.



**4. Who will install the chimney?**

A skilled technician from authorised service center should be called to install the chimney. Kindly contact our Toll Free No.: 1800 209 3484 for installation.

**5. Is ducting compulsory?**

No, but it is always advisable as the efficiency and suction capacity of the chimney increases, and there is no recurring cost of charcoal filters.

**6. Are there separate models for re-cycling and ducting?**

No. Most of the Faber models can be used in both modes of installation.

**7. What should be the size of the duct pipe, length of ducting & the number of bends for effective suction?**

Minimum pipe diameter should be 110 mm for traditional model and 120mm for decorative models. Recommended ducting length should be 8 to 9 feet and maximum two bends.

**8. Can a smaller diameter pipe be fitted?**

No. using a smaller diameter pipe causes a back pressure to act on the motor. The warranty is void in such cases.

**9. Is ducting possible in my house?**

We'll be pleased to send our Representative to ascertain the same.

**10. At what height should the chimney be fitted?**

The chimney should be fitted at a height of not less than 65cms from the burners and ideally not more than 75cms.

**11. Life and cost of charcoal filter?**

Typically, the charcoal filters last around 3-4 months. However, this period may become vary depending on the usage. Cost should be confirmed with the local service center.

**12. How to maintain the chimney?**

The Mesh filters have to be cleaned in warm detergent water every 8-10 days, and the Baffle filters have to be cleaned in warm detergent water every 10-15 days depending on usage. In case of re-cycling the charcoal filters have to be replaced every 3-4 months, depending on the usage.

**13. How do I select the model?**

Our chimneys are categorized into Traditional(Basic or Straight Line). Decorative and Collection, which add to the aesthetics of the kitchen. The suction requirements of

the chimney depend on a lot of parameters like the cooking habits & kitchen size. We would be happy to send our representative to help you choose the right product.

#### **14. What is the suction capacity available ?**

Faber chimneys are available in a range of suction capacities, from 300 m<sup>3</sup>/hr. Our chimneys are categorized into Traditional(Basic or Straight Line),Decorative and collection, which add to the aesthetics of the kitchen. The suction requirements of the chimney depend on a lot of parameters like the cooking habits & kitchen size.

#### **15. Is it true that the chimney makes a lot of noise?**

No. All Faber chimneys generate noise levels tolerable to human ears. typically the noise level are ranging from 40dbA to 67 dbA depending upon the speed of operations and suction capacity of the kitchen chimney.

#### **16. What is the electric consumption?**

It depends on the individual models. Most of the models consume approx. 1 unit for every 3-4 hrs. of operation.

#### **17. What is a Baffle filter? How does it differ from an ordinary(mesh) filter?**

The Faber patented Baffle filter is a Stainless Steel filter with a unique structural design of curves and cup-like strips. This cut & chop technology used in the design ensures grater trapping of oil/grease/spice particles, easier cleaning and lifetime durability. The non-clogging feature ensures the optimum suction of the chimney.

#### **18.What are the sizes available?**

Faber chimneys are available in widths of 60 cm, 75cm, 90cm and 120cm.

#### **19.What are the installation/service charges?**

You can confirm with the local service center or call our **toll free no. 1800 209 3484**.

#### **20.What is the warranty period?**

We have warranty period of one year, five years and Life time warranty depending on the kitchen chimney model.

#### **21. Is there any cleaning contract available?**

Yes it is available. You can confirm with the local service center or call out Toll free no. 1800 209 3484 and ask for "Faber Cleaning Contract (FCC)"

#### **22.What is a Air Filter?**

It is the compact filter which is designed to make clean & fresh air during Spot cooling operation.

The above information may vary from individual and usage of chimney.

## AFTER SALES SERVICE

---

### **Before calling the Toll Free Number to Register the Complaint:**

- \* Check the 'Trouble Shooting Guide' given above to see if you can eliminate the problem yourself.
- \* Re-start the chimney to check if correct operation is restored.

### **On Calling the Toll Free Number:**

Please give the following information

- \* Your complete address with landmark and contact numbers.
- \* Lifetime Warranty Number.
- \* Model of chimney.
- \* Nature of malfunction.
- \* Please make a note of the Call Number allotted to you.
- \* Please handover photocopy of the LTW letter to technician to attend your complaint.

Please do not allow any unauthorized person to service or repair the chimney. This may affect the safety and quality of the product. This will also make the Lifetime Warranty null and void. Please call Faber Care on **1800-209-3484 (Toll Free)**, for any product queries or service escalations.

## FCC POINTS

---

### A. Benefits of the FABER Cleaning Contract:

1. Regular maintenance will increase the performance & life of the product.
2. Risky to get your Faber appliance serviced by unauthorized technician.
3. Periodic cleaning service will be given as per contract package - No need to remember for servicing.
4. Tips for better & effective performance to increase the life of the product shall be given by Faber Authorized personnel.

### B. Benefits of the FABER Sparklez Liquid Cleaner :

1. Specially designer for oily surface cleaning.
2. Anti bacterial nonionic formulation.
3. Regular cleaning of filter will increase the efficiency & hassle free usage.
4. Easy to use, no hot water required just spray & wipe the surface with wet cloth.

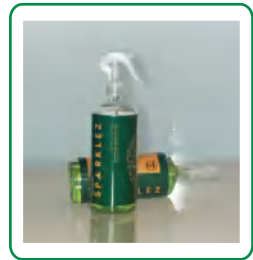

## Service Centers

Toll Free No.1800 209 3484



\*India map is only indicative and not to the scale

---

Before leaving the factory, all appliances are passed through Quality Control in order to give best functional result. Any repairs or adjustment that might be required are to be carried out with utmost care. Hence, we recommend you to contact our All India Toll Free No 1800 209 3484. Always insist on genuine spare parts for efficient working of your appliance.

---

Pictorial illustrations given in booklet are subject to differ with actual product. Information on this manual may contain technical inaccuracies or typographical errors. Information may be changed or updated without notice. Franke Faber India Pvt. Ltd. may also make improvements and/or changes in the products and/or programs described in this information at any time without notice.

---



## FRANKE FABER INDIA PRIVATE LIMITED

Regd. Office / Factory Address: Gat No.: 1086/1/2, Nagar Road, Sanaswadi, Tal Shirur, Pune - 412208, India

Email : [ks-customer care.in@franke.com](mailto:ks-customer care.in@franke.com). Website: [www.faberindia.com](http://www.faberindia.com)

For further information call our Toll Free No.: 1800 209 3484