



AIRDOPES CRUDE

Get ready to immerse yourself in musical bliss with your very own pair of boAt Airdopes Crude. Please consider this manual as your guiding map towards the unparalleled shores of auditory realm. Knowledge of Bluetooth and device connectivity is essential for steering this boat and therefore we strongly recommend thorough reading of this manual. Also, you may refer to the same at times when you face any sort of difficulty.



PACKAGE CONTAINS:

- 1x Pair of TWS Earbuds
- 1x Warranty Card
- 1x Charging Case
- 1x Catalogue
- 1x Type-C Charging Cable
- 1x FAQ Card
- 1x User Manual
- 2x Additional Earmuffs

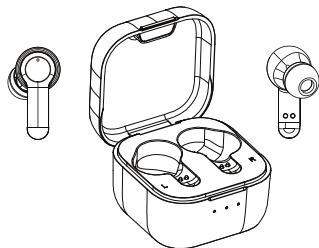

POWER ON (FIRST TIME USER)

Step 1: To switch the earbuds on (Smart Power On) simply open the lid of the charging case (when earbuds are inside). Courtesy our IWP™ (Insta Wake N' Pair) technology, the earbuds power on automatically, get connected and enter the connection mode

OR

Long touch the CTC (Capacitive Touch Control) on both earbuds for 3 seconds to manually power on the earbuds

Step 2: After powering on, the earbuds enter the Connection Mode, indicated by alternate red and blue LED flashes on primary earbud and blue LED flashes once every 5 seconds on the secondary earbud

ENx™ MODE

Our ENx™ tech algorithm cancels out the background noise so that you can be heard crystal clear via voice calls. One need not activate ENx™ as the quad mics are equipped with the same and activated by default.

Deliver your voice without interruptions anywhere - traffic, railway stations, airports, workspace; literally anywhere!

MANUAL POWER OFF

Step 1: Long touch both CTCs for 5 seconds to manually power off the earbuds

Step 2: Once the earbuds get turned off, place them back inside the case and close the lid

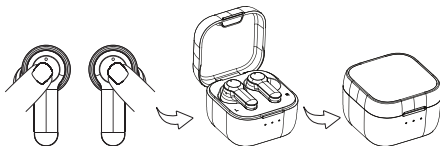

SMART POWER OFF

Step 1: After usage, remove both the earbuds from your ears

Step 2: Place the earbuds back into the charging case in correct orientation and close the lid. The earbuds automatically switch off (and enter charging mode).

VOICE ASSISTANT

Step 1: Long touch the CTC on left earbud for 3 seconds to activate default smart voice assistant

Step 2: The respective voice assistant screen pops up and you may place your commands at ease

Tips: You may try out the following commands,

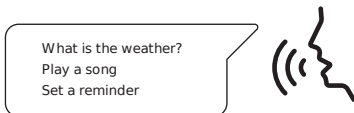

Note: If the voice assistant doesn't get triggered, then the functionality has to be first enabled via your media device settings.

BEAST™ MODE

Long touch the right CTC for 3 seconds to switch to Low Latency mode, also known as the BEAST™ Mode. Once switched on, it gets notified via a sound prompt. Long touch the right CTC for 3 seconds once again, to turn it off and return to Music Mode.

Made for the Gamers - By Gamers, BEAST™ Mode reduces the latency significantly and improves the overall gaming experience.

CONNECTION MODE

Step 3: Turn on the Bluetooth functionality on your phone/media device and scan

Step 4: Search for 'Airdopes Crude' and pair accordingly

Congratulations! Your earbuds are now connected successfully via Bluetooth.

Note:

- Pairing mode lasts for 5 minutes. If the pairing time is missed, then you will need to reconnect the earbuds and follow the above-mentioned procedure
- Airdopes Crude remembers previously connected devices; once switched on, the earbuds automatically reconnect to the previously connected devices in working range



SINGLE EARBUD USAGE

Step 1: Please note that both the earbuds can be used in mono mode. Use Smart / Manual Power On for switching on the desired earbud

Step 2: The selected earbud automatically enters the connection mode indicated by red and blue LED flashes

Step 3: Turn on Bluetooth on your phone/ media device and search for 'Airdopes Crude' to connect

Notes:

- To switch to Stereo mode, simply take out the other earbud from the case. It will automatically power on and pair with the previously selected earbud, hence enabling Stereo usage
- You cannot skip tracks or return to the previous tracks in Mono (single-earbud) mode

FACTORY RESET

Perform the factory reset in case you feel any difficulty while operating your Airdopes.

*NOTE: Before performing reset, clear "Airdopes Crude" from pairing device history by forgetting device

Step 1: Take out the earbuds from the case

Step 2: Long touch both CTCs for 5 seconds one after another, then keep the earbuds inside the case, close the lid and wait for 5 seconds

Step 3: The case LED flashes 5 times to indicate a successful factory reset

Step 4: Take out the earbuds from the case and perform a fresh connection

Congratulations! Your Airdopes Crude has been Reset.

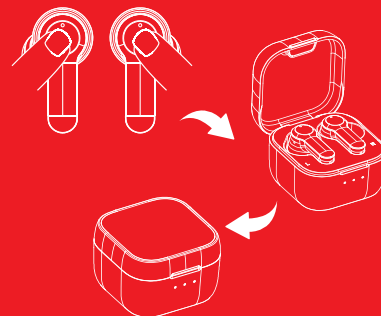

QUICK GUIDE ON FUNCTIONALITIES

- 3 Seconds: Long touch left CTC for 3 seconds to activate voice assistant
- 3 Seconds: Long touch both CTC for 3 seconds to manually power on
- 5 Seconds: Long touch both CTC for 5 seconds to manually power off
- 5 Seconds: Long touch both CTCs for 5 seconds to perform factory reset

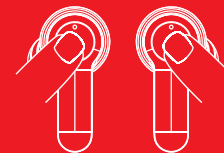

Step 1: Please insert the earbuds back inside the charging case in correct orientation and close the lid

Step 2: In charging status, the Red LED turns on for 2 secs when lid gets opened. LED should be off when lid is closed.

Step 3: Once the earbuds get fully charged, the charging case automatically switches off to save power and the LED turns off

Note:

- When the earbuds' remaining battery is low, RED blink (3 times) when the Case lid gets opened.
- When the earbuds' remaining battery is between 30%-100%, BLUE blink (3 times) when the Case lid gets opened.
- Before using the earbuds for the first time, it is recommended to fully charge the earbuds. Also, please keep the lid of the charging case closed while charging.

CHARGING THE CASE

Step 1: To charge the case, plug one end of the charging cable into the case and the other end into a USB port/adaptor

Step 2: Flashing white LEDs indicate that the charging case is being charged. Once the charging case gets fully charged, the LEDs turn into solid white

Note: The LED lights located on the charging case indicate the battery status of the case.

Remaining Low Case Battery LED Indication

White LED blinks three times to denote low case battery, whenever the case lid gets opened/closed.

Case LED indication when Earbuds are getting charged from the case

This is to indicate TWS is getting charged from the case (when lid gets closed)

- LED1 lights up for LEFT bud
- LED3 lights up for RIGHT bud
- If both are getting charged, they get indicated by LED1& LED3 for 5 secs

- Voice Assistant: Long touch the left CTC for 3 seconds to activate default voice assistant
- Answer: Single tap the CTC on either earbud to answer an incoming call
- Hang Up / Reject Call: Double tap the CTC on either earbud to end / reject call
- Play/Pause Music: Single tap either earbud's CTC to play or pause music
- Next Track: When playing music, double tap the right earbud's CTC to skip to the next song
- Previous Track: When playing music, double tap the left earbud's CTC to return to the previous song

Note: Volume can only be controlled via the media device

SPECIFICATIONS

Headphone Type	TWS
Bluetooth Version	V5.3
Music Playtime	Up to 8HRS per charge; Up to 42HRS additional with Case (at 60% volume)
Standby Time	150Hrs
Transmission Range	10m
Driver Size	10mm*2
Number of Mics	4
ENx™	Yes
BEAST™ Mode	Yes
Latency	Ultra Low; 40ms
Frequency	20HZ-20KHZ
Battery	380mAh (Case); 40mAh*2 (Earbuds)
Charging Time	40Min (Earbuds); 15 hours (Case)
Charging Interface	USB Type C
Water Resistance	IPX4

WARNING

- Please follow the instructions to operate
- Please don't use the earbuds in extreme temperatures
- Please don't use the product near water
- Please keep the product away from heat sources, as the heat may damage it
- Don't jam the ports such as charger port, LED port, etc.
- It is recommended to utilize the product below the maximum volume in order to protect hearing and extend the ear-buds' service life