

**4. Add Camera**

- Open **ezykam+** app, click “+” on the top right corner of the “HOME” page, then select “Specific model to add”.
- Make sure that the Red LED indicator is blinking and voice prompt is audible.

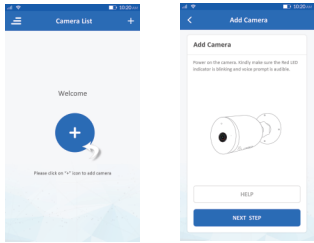

- Enter your “Wi-Fi network and password”, click “CONFIRM”.



**4.0 Add Camera**

- Read the instruction about “Scan the camera QR code” and click “Continue”.
- Scan the QR Code on your phone with camera. Heard a voice prompt, click “Heard the beep”

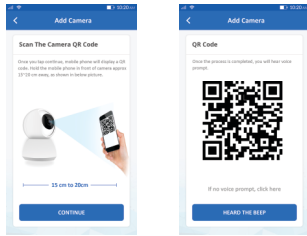

**4.1 Add Camera**

- When the indicator light on the device turn to steady blue light, the network configuration is complete.
- Please refer to the specific APP interface if there are any difference.

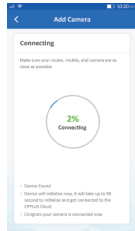

**Frequently Asked Questions**

- 1. Can I share camera with family and friends?**  
Yes, you can share your cameras with family and friends who will have access to view the camera.
- 2. What's the Wireless Range?**  
The range of your home Wi-Fi is heavily dependent on your home router and the conditions of the room. Check with your router specifications for exact range data.
- 3. The camera appears offline or unreachable?**  
Make sure you entered the correct Wi-Fi password during the Wi-Fi setup. Check whether there is any Internet connection problem. If the Wi-Fi signal is too weak, reset your Wi-Fi router and try again.
- 4. Cannot connect to your Wi-Fi network.**  
Make sure you entered the correct Wi-Fi password during the Wi-Fi setup. Check whether there are any Internet connection problems. If the Wi-Fi signal is too weak, reset your Wi-Fi router and try again.
- 5. How many cameras can I control?**  
CP Plus app can control unlimited number of cameras in unlimited amount of locations. Your router may have a limit of how many cameras can be connected to one router.

**Voice control works with Alexa or Google Assistant**

- You can control your camera using just your voice with Alexa or Google Assistant-enabled devices.



**System Requirements**

- Smartphone running iOS® 9.0 or higher or Android™ 5.0 or higher
- Existing Wi-Fi Network with internet connection

**Technical Specifications**

- Resolution: CP-V21 = 1920x1080@15fps, H.264 encoding  
CP-V21A = 1920x1080@20fps, H.264 encoding  
CP-V31A = 2304x1296@20fps, H.265 encoding  
CP-V41A = 2560x1440@20fps, H.265 encoding
- Audio: Internal Speaker and Microphone
- Storage: supports up to 128GB Micro SD card (not included)
- Wi-Fi: IEEE 802.11b/g/n, 2.4GHz (not compatible with 5GHz Wi-Fi networks)



**Quick Operation Guide**  
V21/V21A/V31A/V41A

Thank you for choosing CP PLUS ezykam. Get started using your new devices by downloading ezykam+ app, one convenient app that manages everything straight from your smart phone. Easily connect to your home Wi-Fi and control multiple devices from the touch of your fingertips

**What's in the Box**



ezykam Wi-Fi Camera

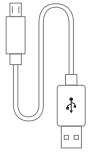

USB Cable



Power Adapter



Quick Operation Guide

**Get Ready**

- Know your Wi-Fi network and password.
- Make sure your mobile device is running iOS® 9.0 or higher or Android™ 5.0 or higher.
- Make sure you're connecting to a 2.4GHz Wi-Fi network (It can't connect to 5GHz networks)

**1. Download the ezykam+ app from App Store or on Google Play.**

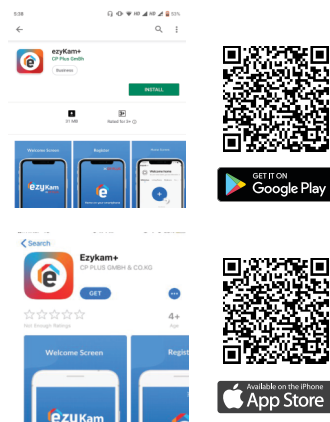

Google, Google Play and Google Home are trademarks of Google LLC.  
Amazon, Alexa and all related logos are trademarks of Amazon.com, Inc. or its affiliates.

**2. Register an account on your ezykam+ app.**

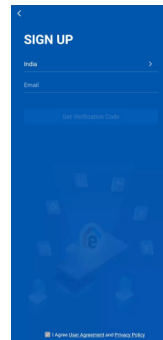

- STEP 1.
- Select the country.
  - Enter the email address.

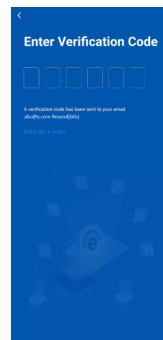

- STEP 2.
- Enter the verification code and create a password

**3. Plug in**

**How do I reset my camera?**

- Use the reset pin to press the Reset Button for several seconds until the camera starts to beep.
- **Optional:** Insert Micro SD card



Thank you for choosing CPPlus ezykam.

For further assistance, you can reach us via [ezycare@cpplusworld.com](mailto:ezycare@cpplusworld.com)

**\*\* Please read the instruction carefully before using the product \*\***