

**morphyrichards**

# 2 Slice Sandwich/Grill Toaster SM3006/SM3006(G)

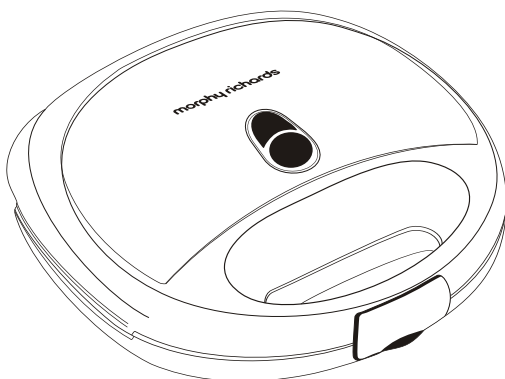

Please read and keep these instructions



getting the best from  
your new sandwich toaster



[www.morphyrichards.co.uk](http://www.morphyrichards.co.uk)  
[www.morphyrichardsindia.com](http://www.morphyrichardsindia.com)

## Important safeguards

1. Read all instructions before using this appliance.
2. In common with most cooking appliances your toaster will get hot during use particularly the toasting plates. After placing your bread on the hot plates, touch only the latch and handle during and immediately after the toasting process.
3. During toasting, steam and hot air will be ejected from the sandwiches. Take extreme care when closing and opening the toaster.
4. When not in use switch off and unplug the mains lead. This is particularly important when cleaning your toaster.
5. Do not immerse the toaster in water or any other liquid. Do not wash your under a running tap and make sure that liquid is not spilt in the toaster or on the mains lead.
6. Do not let the mains lead hang over a table or worktop, touch hot surfaces or become knotted.
7. Keep the toaster away from other hot kitchen appliances - oven, electric rings etc.
8. Do not operate the toaster if it has a damaged mains lead or plug. To avoid the risk of electric shock, do not disassemble the toaster, but telephone Morphy Richards Service Center for advice.
9. When your toaster is not in use switch it off and remove the plug from the socket. Allow your toaster to cool before you move it.
10. Do not use outdoors.
11. Do not use for other than domestic use.

## Worth noting

If your toaster does not work, check the following points:

1. Is the plug in its socket and the switch in the 'on' position?
2. Is the plug itself or the socket faulty - check this by plugging in another appliance.
3. In the unlikely event that the mains lead requires replacement or your toaster needs repairs, then do not attempt these tasks yourself, but telephone Morphy Richards Service Center.

## SAVE THESE INSTRUCTIONS

### Electrical requirements

Check that the voltage on the rating plate of your appliance corresponds with your house electricity supply which must be A.C. (Alternating Current).

If the socket outlets in your home are not suitable for the plug supplied with this appliance, the plug should be removed and the appropriate one fitted.

Note: The plug removed from the mains lead, if severed, must be destroyed as a plug with bared flexible cord is hazardous if engaged into a live socket outlet.

**WARNING: THIS APPLIANCE MUST BE EARTHED.**

## Parts description

- 1 Power lamp
- 2 Ready lamp
- 3 Handle clip
- 4 Baking plate
- 5 Bottom shell
- 6 Top shell

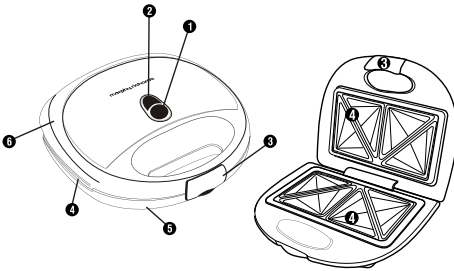

## Using your sandwich/Grill toaster

Before using your toaster for the first time, brush or wipe a small amount of vegetable oil onto the toasting plates.

Open the toaster by undoing the closure clip on the handle and raising the upper half of toaster with the handle. The appliance must be fully closed and fastened for preheating and cooking.

### Prepare your sandwich in advance

For best results lightly butter the bread on the outside; do not cut the bread in half before cooking your sandwich.

1. Plug the toaster into the mains socket and switch on. The red light & green light will glow to indicate that your toaster is on.
2. When the toaster has heated up and is ready to use, the green light will go off.

3. Next, open and place the sandwiches on the hot plates. Remember, the toaster plates are very hot.

When using for the first time you may notice a fine smoke haze being emitted from the unit, this is due to the 'bake in' of some of the components and is not harmful.

4. To close the toaster squeeze the two front handles together, squeezing the bread slices. Fasten the closure clip on the handle and ensure it is closed firmly. Sometimes the green light will go on and off during toasting, this is normal and shows that the controls are working correctly.



5. When removing sandwiches from the toaster never use a metal implement such as a knife or fork, always use a heat proof plastic or wooden spatula. Take extreme care as the toaster body and plates become very hot.

## Cleaning and storage

After use, allow the toaster plates to cool down, then clean them with a damp cloth or kitchen paper roll.

Never immerse the toaster in water or any other liquid.

After the toaster has cooled down, the mains lead can be wound around the storage area on the base and stored vertically to save space.

## Technical Data

Power Supply : AC 230V 50Hz  
Wattage : 700W

*Morphy Richards products are intended for household use only*

*Morphy Richards has a policy of continuous improvement in product quality and design. The Company, therefore, reserves the right to change the specification of its models at any time.*

*Products & parts are indicative only, the actual product may differ.*

**morphy richards**

Morphy Richards Ltd, Mexborough,  
South Yorkshire, England, S64 8AJ