

# KODAK LED TV

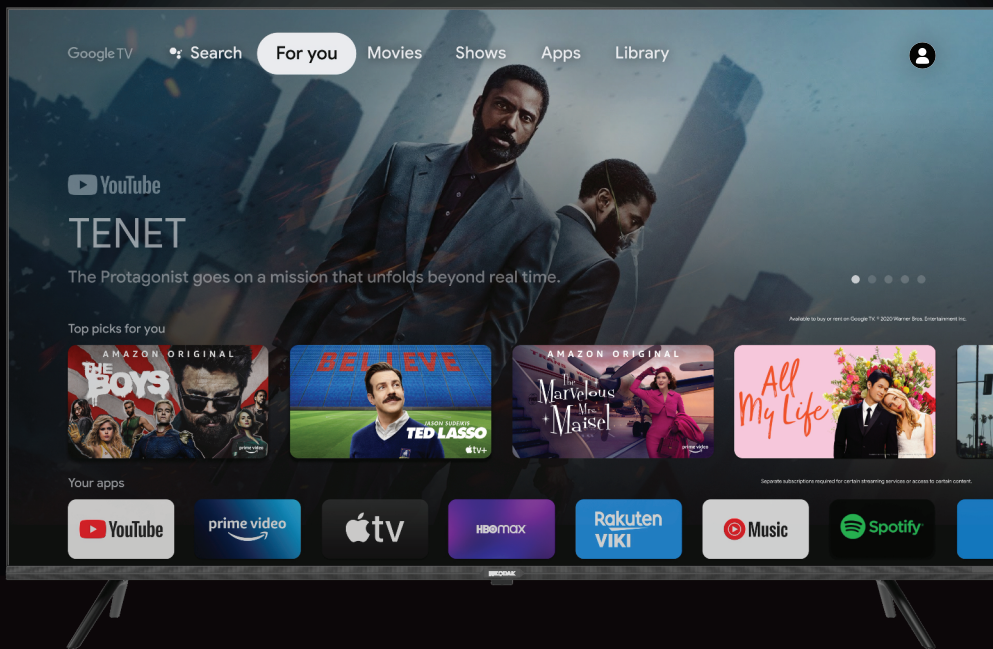

## Quick Start Guide



Please read this manual carefully before installing and operating the TV.  
Keep this manual with you for reference.

# PREPARATION

Note: The pictures are only for reference.

## Unpacking and Installation

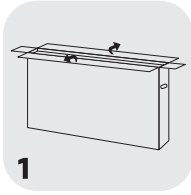

Open the package.

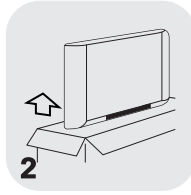

Take out the TV.

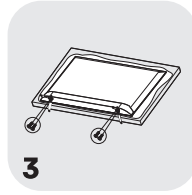

Install the TV stands.

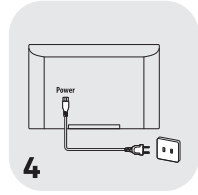

Connect the power cord.

## Standard Accessories

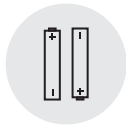

Batteries/2

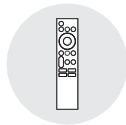

Remote Control

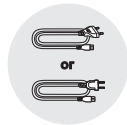

Power Cord

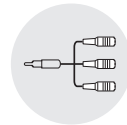

AV Converting  
Cable



Warranty Card



Quick Start  
Guide



Screws/4



Base Stands/2

## Stand Installation

**Step 1:** Take out the TV and carefully put it (screen downward) on a stable and flat table with a soft cloth or cushion under it.

**Step 2:** Please check to make sure there are the same marks (A/B) on the TV back and the stand. This step can be skipped for stands without any marks on it, or those TVs which have only one stand.

**Step 3:** Fix the stands to the TV by using the matching screws provided in the box. The stands may vary depending on the region or model.

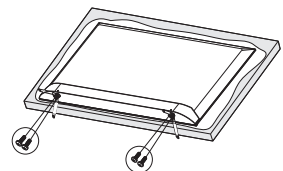
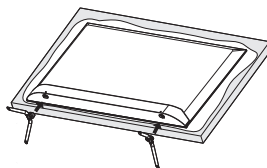
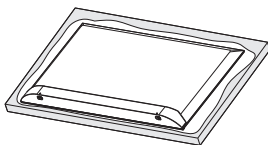

# WARNING AND PRECAUTION

Read all of the instructions before operating the set. Keep these instructions for later use.

## IMPORTANT SAFETY INSTRUCTIONS

- Keep these instructions - The safety and operating instructions should be retained for future reference.
- Read all warnings — All warnings on the appliance and in the operating instructions should be adhered to.
- Follow all instructions — All operating and use instructions should be followed.
- Do not use this apparatus near water - The appliance should not be used near water or moisture — for example, in a wet basement or near a swimming pool, and the like.
- Clean only with dry cloth.
- Do not block any ventilation openings. Install in accordance with the manufacturer's instructions.
- Do not install near any heat sources such as direct sunlight, radiators, heat registers, stoves, or other apparatus (including amplifiers) that produce heat.
- Do not defeat the safety purpose of the polarized or grounding plug. A polarized plug has two blades with one wider than the other. A grounding plug has two blades and a third grounding prong. The wide blade or the third prong is provided for your safety. If the provided plug does not fit into your outlet, consult an electrician for replacement of the obsolete outlet.
- Protect the power cord from being walked on or pinched particularly at the plugs, convenience receptacles, and at the point where they exit from the apparatus.
- Only use attachments/accessories specified by the manufacturer.
-  Use only with the cart, stand, tripod, bracket, or table specified by the manufacturer, or sold with the apparatus. When a cart or rack is used, use caution when moving the cart/apparatus combination to avoid injury from tip-over.
- Unplug the apparatus during lightning storms or when unused for long periods of time.
- Refer all servicing to qualified personnel. Servicing is required when the apparatus has been damaged in any way, such as the power supply cord or plug is damaged, liquid has been spilled or objects have fallen into the apparatus, the apparatus has been exposed to rain or moisture, it does not operate normally, or has been dropped.
- CAUTION: These servicing instructions are for use by qualified service personnel only. To reduce the risk of electric shock, do not perform any servicing other than that contained in the operating instructions unless you are qualified to do so.
- Do not install this equipment in a confined or built-in space such as a bookcase or similar unit, and ensure its contained in well ventilated open space.
- Please refer the information on rear enclosure for electrical and safety information before installing or operating the apparatus.
- To reduce the risk of fire or electric shock, do not expose this apparatus to rain or moisture.
- The apparatus should not be exposed to dripping or splashing and ensure that no objects filled with liquids, such as vases, shall be placed on the apparatus. Do not use the set near a dusty place.

- For the terminals marked with the symbol “⚡” there may be sufficient magnitude to constitute a risk of electric shock. The external wiring connected to the terminals requires installation by an instructed person or the use of ready-made leads or cords.
- To prevent injury, use the stand/wall-mount bracket to securely install this apparatus on the table/wall in accordance with the installation instructions.
- There is danger of explosion if battery is incorrectly replaced. Replace only with the same or the like.
- The battery (batteries or battery pack) shall not be exposed to excessive heat such as sunshine, fire or the like.
- Excessive sound pressure from earphones and headphones can cause hearing loss. Listening to music at high volume levels and for extended durations can damage one’s hearing. In order to reduce the risk of damage to hearing, one should lower the volume to a safe, comfortable level, and reduce the amount of time listening at high levels.
- The appliance coupler is used as a disconnect device, the disconnect device shall remain readily operable.
- When put into use again, please make sure the power cord set has not been damaged. If any damage is found, please look for the service person to replace the power cord set specified by the manufacturer or have the same characteristics as the original one.
- Attention should be drawn to environmental aspects of battery disposal.
- No naked flame sources, such as lighted candles, should be placed on the apparatus. To prevent the spread of fire, keep candles or other open flames away from the apparatus at all times.
- If the apparatus has the symbol [HI] in its rating label and the power cord has two pins, it means that the equipment is a Class II or double insulated electrical appliance. It has been designed in such a way that it does not require a safety connection to electrical earth. (Only for Class II appliance)
- Warning for Apparatus containing COIN / BUTTON CELL BATTERIES (Below instruction only used for the apparatus containing a user-replaceable coin/button cell battery)

**WARNING:**

Do not ingest the battery, its a Chemical Burn Hazard. The remote control supplied with this product contain a coin/button cell battery. If the coin/button cell battery is swallowed, it can cause severe internal burns in just 2 hours and can lead do death. Keep new and used batteries away from children. If the battery compartment does not close securely, stop using the product and keep it away from children. If you think batteries might have been swallowed or placed inside any part of the body, seek immediate medical attention.



**Explanation Regarding the diagram:**

This lightning flash with arrowhead symbol within an equilateral triangle Intended to alert the user to the presence of non-insulated "dangerous voltage" within the product's enclosure that may be of sufficient magnitude to constitute a risk of electric shock

To reduce the risk of electric shock do not remove cover (or back). There are no user serviceable parts inside. Refer to qualified personnel.

● **The following information is included for reference where applicable:**

~	Refer to alternating current (AC).	⏻	Refer to stand-by or power on.
—	Refer to direct current (DC).	I	Refer to power on.
Ⓜ	Refer to ClassII equipment.	⚡	Refer to dangerous voltage.

## WEEE Directive



Correct Disposal of this product. To prevent possible harm to the environment or human health from uncontrolled waste disposal, recycle it responsibly to promote the sustainable reuse of material resources. To return your used device, please use the return and collection MEE systems or contact the retailer where the product was purchased. They can take this product for environmental safe recycling.

## Positioning the TV

- Install Display on solid horizontal surface such as a table or desk. For ventilation, leave a space of at least 10cm free all around the set. To prevent any fault and unsafe situations, please do not place any objects on top of the set. This apparatus can be used in tropical and/or moderate climates.

- Fix the rear of enclosure to wall (only for some countries)
- Warning: Stability Hazard

A television set may fall, causing serious personal injury or death. Many injuries, particularly to children, can be avoided by taking simple precautions such as:

- ALWAYS use cabinets or stands or mounting methods recommended by the manufacturer of the television set.
- ALWAYS use furniture that can safely support the television set.
- ALWAYS ensure the television set is not overhanging the edge of the supporting furniture.
- ALWAYS educate children about the dangers of climbing on furniture to reach the television set or its controls.
- ALWAYS route cords and cables connected to your television so they cannot be tripped over, pulled or grabbed.
- NEVER place a television set in an unstable location.
- NEVER place the television set on tall furniture (for example, cupboards or bookcases) without anchoring both the furniture and the television set to a suitable support.
- NEVER place the television set on cloth or other materials that may be located between the television set and supporting furniture.
- NEVER place items that might tempt children to climb, such as toys and remote controls, on the top of the television or furniture on which the television is placed.
- If the existing television set is being retained and relocated, the same considerations as above should be applied.

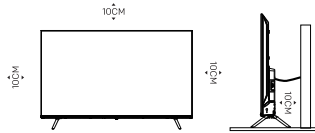

*Note: The picture is only for reference.*

## Mounting on a Wall

- An optional wall mount can be used with your television. Consult with your local dealer to purchase the recommended wall mount bracket. Carefully attach the wall mount bracket at the rear of the TV. Install the wall mount bracket on a solid wall perpendicular to the floor. If you are attaching the TV to other building materials, please contact qualified personnel to install the wall mount. Detailed instructions will be included with the wall mount. Please use a wall mount bracket where the device is adequately secured to the wall with enough space to allow connectivity to external devices.

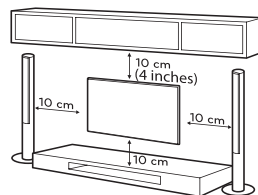

*Note: The picture is only for reference.*

- Disconnect the power before moving or installing the TV. Otherwise, electric shock may occur.
- Remove the stand before installing the TV on a wall mount by performing the stand attachment in reverse.
- If you install the TV on a ceiling or slanted wall, it may fall and result in severe injury. Use an authorized wall mount and contact the local dealer or qualified personnel. Otherwise, it is not covered by the warranty.
- Do not over tighten the screws as this may cause damage to the TV and void your warranty.

- To prevent injury, this apparatus must be securely attached to the wall in accordance with the installation instructions.

Use the screws and wall mounts that meet the following specifications. Any damages or injuries by misuse or using an improper accessory are not covered by the warranty.

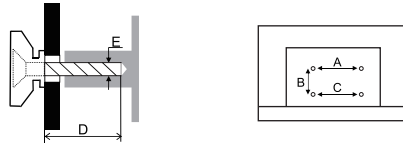

Model Size		50"		55"		65"		
		Top	Down	Top	Down	Top	Down	
Screw	Diameter(mm) "E"	M6	M6	M6	M6	M6	M6	
	Depth(mm) "D"	Max	15	15	15	15	28	28
		Min	10	10	10	10	22	22
	Quantity		2	2	2	2	2	2
A*B*C		200*200*200		200*200*200		400*200*400		

Note:

1. The pictures are only for reference.
2. For TV sets with terminals that face the wall, enough space must be left to use the terminals. A plastic spacer with a screw should be used with the wall mount. The spacer is a small hollow pillar with a height of a minimum of 30mm.

## Precautions For Using Remote Control

- Use the remote control by pointing it towards the remote sensor. Any items between the remote control and the remote sensor will interfere with the normal operation.
- Do not allow remote control to vibrate violently. Also, do not splash liquid on the remote control or put the remote control in a high humidity location.
- Do not place the remote control in direct sunlight which will cause deformation of the unit by heat.
- When the remote sensor is in direct sunlight or strong lighting, the remote control will not work. If so please change the lighting or TV's position, or operate the remote control closer to the remote sensor.
- Before BLUETOOTH searching, please make sure you have turned the external BLUETOOTH devices in the pairing mode. The BLUETOOTH remote control supplied with the TV (may not be available), you can press BACK and HOME buttons together to open its pairing mode. For other BLUETOOTH devices, please read their instruction manuals for opening the pairing mode.

## Precautions For Using Battery

Improper using of the battery will cause leakage. So please follow the instructions below.

1. Please note the batteries' polarity, to avoid short circuit.
2. When the battery's voltage is insufficient it will affect the usage range. You will need to replace the batteries.
3. Do not use different types of batteries (for example, Manganese and Alkaline batteries) together.
4. Do not put the battery into fire, and charge or decompose the battery.
5. Please dispose of batteries in compliance with relevant environmental protection regulations.
6. WARNING: The batteries (battery pack or batteries installed) should not be exposed to excessive heat such as sunshine, fire or the like.

# TERMINAL CONNECTION

Note:

- 1). The pictures are only for reference.
- 2). External equipments and cables shown herein are not supplied with the TV.

## • AV IN

Receive audio and video signals from external AV devices.

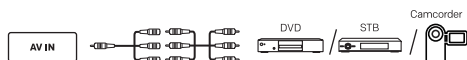

## • ANTENNA IN

Connect a coaxial cable to receive signals from the antenna, cable.



## • USB

Connect a USB storage device.



## • HDMI

Receive HD input signal from external HDMI devices.

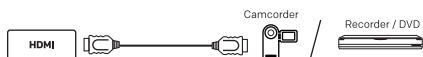

## • DIGITAL AUDIO OUT

Use an optical cable to output your TV's audio signal to a compatible digital audio receiver.



## • LAN

Wired network port.



# REMOTE CONTROL

Note:

1). The picture is only for reference.

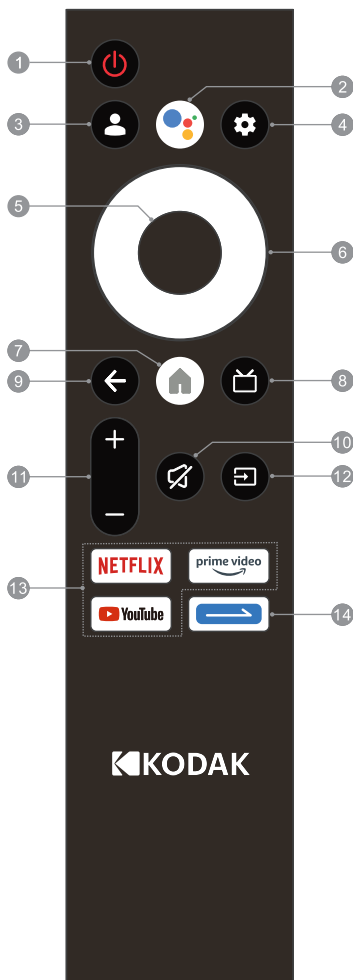

## 1. POWER (⏻)

Turn the TV on or to standby mode.

## 2. MIC (🗣️)

Start using the near field voice function.

- Short press MIC button to wake up the voice assistant.
- Long press MIC button to start receiving your voice command. After your speaking, release MIC button to run voice function

## 3. ACCOUNT (👤)

Sign in with your GOOGLE account to get the entertainment you love.

## 4. Dashboard (⚙️)

Access the dashboard of your GOOGLE TV.

## 5. OK

Confirm, enter or execute the selected item, or show the list of Quick Buttons.

## 6. Navigation Buttons (UP/DOWN/LEFT/RIGHT)

Navigate the menu to select the content you need, or

- Press **LEFT/RIGHT** button to change channels.
- Press **DOWN** button once to access INFO interface.
- Press **DOWN** button twice to access EPG interface in DTV mode

## 7. HOME (🏠)

Access the home screen.

## 8. GUIDE (📺)

Access the Electronic Program Guide in DTV mode.

## 9. BACK (←)

Return to upper-level content, or exit the current screen or operation.

## 10. MUTE (🔇)

Mute or restore the TV sound.

## 11. Volume Up/Down (+/-)

Adjust the sound volume.

## 12. SOURCE (📺)

Access the source menu.

## 13. Application Buttons

Access specific applications quickly and directly.

## 14. Compound Button:

- Short press to set or start the function of shortcut key.
- Long press to open the virtual keyboard including number buttons, color buttons, and so on.



# BASIC OPERATION

## Install Remote Control Batteries

Place two AAA size batteries in the remote control's battery compartment, making sure to match the polarity markings inside the compartment.

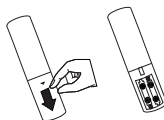

Note: The picture is only for reference.

## TV Control Button

### In standby mode:

Short press TV control button to turn on the TV.

### In working status:

Short press TV control button to call out the following menu on the soft keyboard. Inside it, short press TV control button to move the cursor and select the desired item. Long press TV control button to enter or execute the selected item.



**TV Control Button**

Note: The picture is only for reference.



# TROUBLESHOOTING

Before calling a service technician, please check the information below for the possible cause of your issue and a potential solution.

## General Problem / Solution

- **Remote control does not work**
  - Change the batteries.
  - Check if batteries are installed correctly.
  - Check if main power is connected.
  - Check if there are some items between remote sensor and remote control.
- **Poor Signal**
  - This is usually caused by interference from electronic equipments or radio interference sources.

## Picture & Sound / Solution

- **No picture, no sound**
  1. Check the signal source.
  2. Plug another electrical device into the outlet to check if it is working or turned on.
  3. Check if power plug is in good contact with the outlet.
- **No sound, picture OK**
  1. If no sound, unmute the sound or increase the volume.
  2. Open the sound menu and adjust 'Balance'
- **Abnormal picture**

**For no color or bad picture quality, you may:**

  1. Adjust the color option in menu settings.
  2. Keep the TV at a sufficient distance from other electronic products.
  3. Try another channel. .
- **Bad TV signal (Display mosaic or snowflakes)**
  1. Check the signal cable and adjust the antenna.
  2. Fine tune the channel.
  3. Try another channel.

## Multimedia Player / Solution

- **'This file is invalid' /'Unsupported audio' appears, or audio is normal but video is abnormal, or video is normal but audio is abnormal**
  1. The media file may be damaged, check if the file can be played on the PC.
  2. Check if video and audio codec is supported.

## Network / Solution

- **Network failure**
  1. Check if the router works well.
  2. Make sure the TV has connected to the router successfully.

## Browser / Solution

- **Web page can not be displayed completely**

Some third-party extensions of the current web page may not be supported. Please close the current web page.
- **Browser is forced to be shut down**

The current web page may include too much content which results in insufficient memory and the browser closes.

*Note:*

1. In dry environment due to static electricity, the product may restart and return to the main OSD interface, USB player interface or the previous source mode. It is normal and please continue to operate the TV as you will.

# SPECIFICATION

<b>Working voltage:</b>	100-240V~ 50/60 Hz
<b>Dimensions without stand (W X H X D):</b>	50": 1110 X 649 X 92 mm 55": 1225 X 718 X 93 mm 65":1445 X 838 X98 mm
<b>Net weight without stand:</b>	50": 9.6 kg 55": 11.8 kg 65": 18.2 kg
<b>RF aerial input:</b>	75 ohm unbalanced
<b>Language of OSD:</b>	Multiple options
<b>System:</b>	DTV: DVB - T/T2/C ATV: PAL BG/I/DK
<b>Channel coverage:</b>	DVB-T/T2:174 MHz ~ 230 MHz, 470 MHz ~ 860 MHz DVB-C: 48 MHz~ 859 MHz ATV: 47.25 MHz ~ 865.25 MHz
<b>Environment:</b>	Working temperature: 5°C-40°C Working humidity: 20%-80% Storage temperature: -15°C-45°C Storage humidity: 10%-90%, non-condensing

# LICENSE



Google TV is the name of this device's software experience and a trademark Co Google TV of Google LLC. Google, YouTube, and Chromecast built-in and other related marks are trademarks of Google LLC.



The Adopted Trademarks HDMI, HDMI! High-Definition Multimedia Interface, and the HDMI Logo are trademarks or registered trademarks of HDMI HGIEDEF ATION MURTIMEDIA RITEREAGE Licensing Administrator, Inc. in the United States and other countries.



For DTS patents, ses <http://patents.dts.com>. Manufactured under license from DTS, Inc. (for companies headquartered in the U.S./Japan/Taiwan) or under license from DTS Licensing Limited (for all other companies). DTS, ° DTS Studio Sound, and the DTS logo are registered trademarks or trademarks of DTS, Inc. in the United States and other countries. © 2021 DTS, Inc. ALL RIGHTS RESERVED.



Dolby, Dolby Vision, Dolby Atmos, and the double-D symbol are registered O trademarks of Dolby Laboratories Licensing Corporation. Manufactured under VISION-ATMOS license from Dolby Laboratories. Confidential unpublished works. Copyright © 2012-2022 Dolby Laboratories. All rights reserved.

**Note:**

1. The pictures in this document are only for reference.
2. Appearances and specifications are subject to change without notice.
3. In dry environment due to static electricity, the product may restart and return to the main OSD interface, USB player interface or the previous source mode. It is normal and please continue to operate the TV as you will.

[www.kodaktv.in](http://www.kodaktv.in)

The Kodak trademark, trade dress and logo are used under License from Kodak

© SPPL 2023.

Super Plastronics Private Limited

B-29, 30 & 31 Sector - 81 Phase 2 Noida, 201305

Toll Free - 1800-3000-2288

customercare@kodaktv.in

