

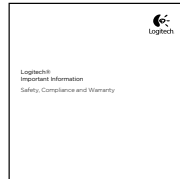

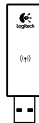

mk220

Getting started with  
Logitech® Wireless Combo MK220

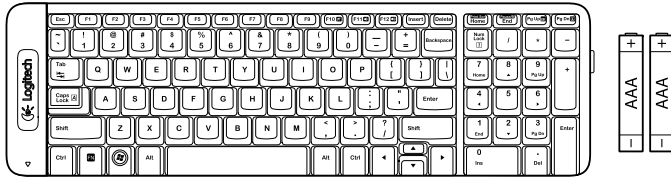



## Contents

English . . . . .	4
繁體中文 . . . . .	7
한국어 . . . . .	10
<b>www.logitech.com/support</b>  . . . . .	13

1

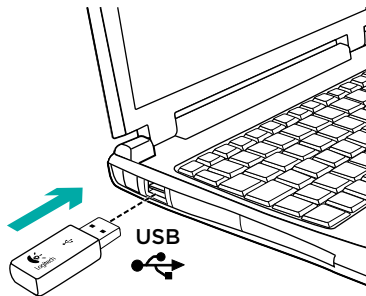

2

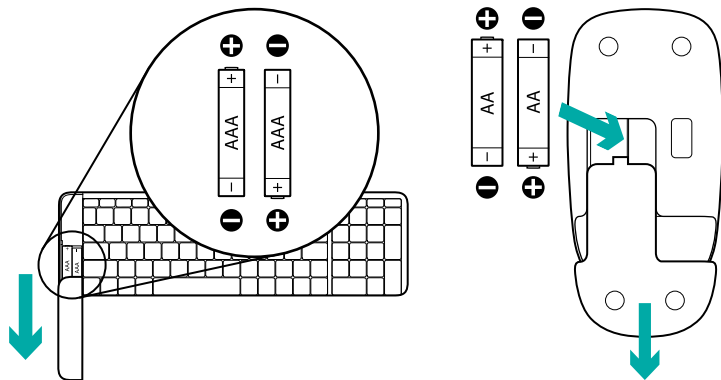

## Keyboard features

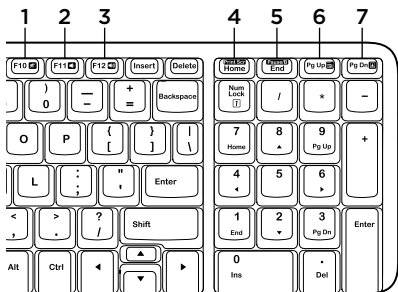

## Hotkeys

1. Mute
2. Volume Down
3. Volume Up
4. Print screen
5. Pause break
6. Context menu
7. Scroll lock

## Mouse features

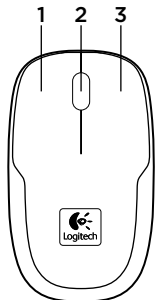

1. Left button
2. Scroll wheel
3. Right button

## Help with setup: keyboard and mouse are not working

- Check the orientation of the batteries inside the keyboard and mouse, or replace the batteries.
- Is the USB receiver securely plugged into a computer USB port? Try moving the USB receiver to a USB port closer to the keyboard and mouse.
- If the USB receiver is plugged into a USB hub, try plugging it directly into your computer.
- Remove any metal object between the receiver and the keyboard/mouse that may interfere with reception. Try using the mouse on a different surface.
- Restart the computer.
- If these suggestions don't work, download the Reconnection Utility from [http://www.logitech.com/connect\\_utility](http://www.logitech.com/connect_utility).

1

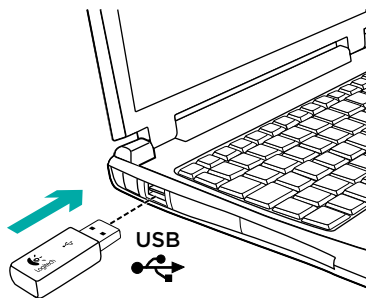

2

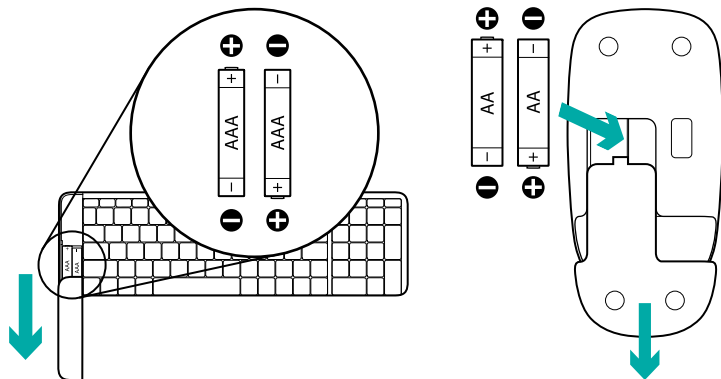

## 鍵盤功能

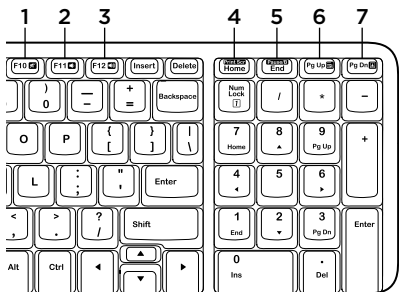

## 熱鍵

1. 靜音
2. 音量減小
3. 音量增大
4. 列印螢幕
5. 暫停/中斷
6. 右鍵快顯功能表
7. 滾動鎖定

## 滑鼠功能

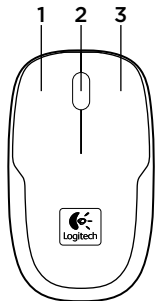

1. 左鍵
2. 滾輪
3. 右鍵



## 安裝說明：鍵盤和滑鼠無法正常運作

- 請檢查鍵盤與滑鼠內部安裝之電池的方向是否有誤，或是更換新電池。
- USB 接收器是否已穩固地插入到 USB 連接埠？嘗試將 USB 接收器移到較接近鍵盤與滑鼠的 USB 連接埠上。
- 若將 USB 接收器插入 USB 集線器，請嘗試將其直接插入電腦。
- 移開所有介於接收器與鍵盤/滑鼠之間，且可能會干擾訊號的金屬物體。請嘗試在不同的表面上使用滑鼠。
- 重新啟動電腦。
- 若上述建議皆無效，請至以下網址下載「重新連線公用程式」(Reconnection Utility)：[http://www.logitech.com/connect\\_utility](http://www.logitech.com/connect_utility)。

1

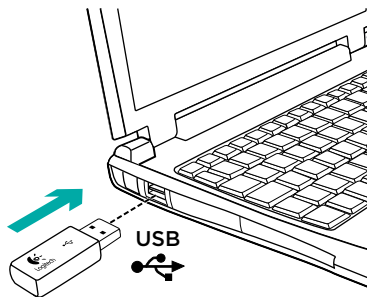

2

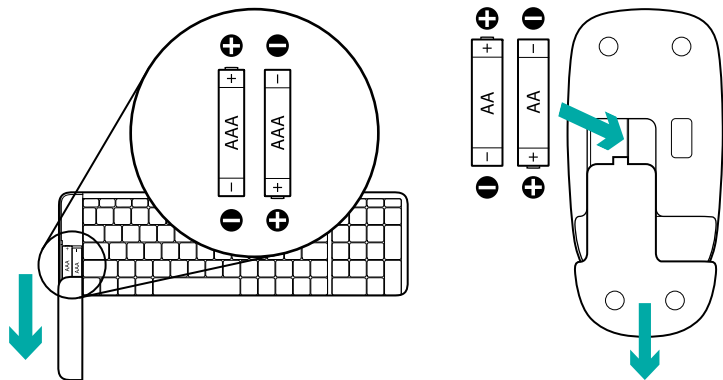

## 키보드 기능

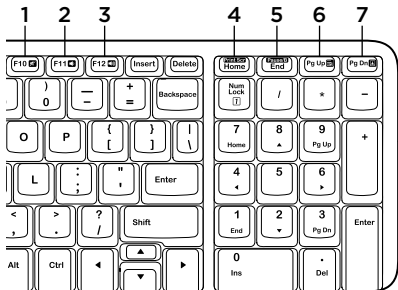

## 단축 키

1. 음소거
2. 볼륨 줄이기
3. 볼륨 높이기
4. 화면 인쇄
5. 일시 중지/중단
6. 상황에 맞는 메뉴
7. 스크롤 잠금

## 마우스 특징

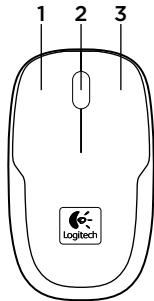

1. 왼쪽 버튼
2. 스크롤 휠
3. 오른쪽 버튼

## 설치 도움말: 키보드 및 마우스가 작동하지 않음

- 키보드 및 마우스 안에 있는 배터리 방향을 확인하거나 배터리를 교체해 보십시오.
- USB 수신기가 컴퓨터 USB 포트에 안정적으로 연결되어 있습니까? USB 수신기를 키보드 및 마우스와 가까운 USB 포트로 옮겨 보십시오.
- USB 수신기가 USB 허브에 연결되어 있으면 컴퓨터에 직접 연결해 보십시오.
- 수신기와 키보드/마우스 사이의 수신을 방해할 수 있는 금속 물체를 제거합니다. 마우스를 다른 표면에 사용해 보십시오.
- 컴퓨터를 다시 시작하십시오.
- 이렇게 해도 문제가 해결되지 않을 경우 [http://www.logitech.com/connect\\_utility](http://www.logitech.com/connect_utility)에서 Reconnection Utility를 다운로드하십시오.

**Logitech Addresses and Phone Numbers**

<i>Region</i>	<i>Sales Office Address</i>	<i>Technical Help</i>
<b>Logitech Far East Ltd.</b> 羅技電子股份有限公司	6F-4, No. 123, Sec. 4, Pa-Teh Road, Taipei, Taiwan 臺北市八德路四段123號6樓之4 ☎ 886-2-2746-6601 ☉ 星期一至五，上午九時至 下午六時正	☎ 0800-012 300 (免付費) ☉ 星期一至五 · 上午九時至下午六時正
<b>Logitech Singapore Pte Ltd.</b>	1 Maritime Square #09-31/32 HarbourFront Centre (Lobby A) Singapore 099253 ☎ 65-6270 5515 ☉ Monday - Friday, 9am - 6pm	☎ 800-60-11-372 (Toll free for Singapore Only) ☎ 1800-88-0719 (Toll free for Malaysia Only) +(60) 3-2054-1886 (for Thailand, Indonesia, Indochina) ☉ Monday - Friday, 9am - 6pm
<b>Logitech Australia Computer Peripherals Pty Ltd.</b>	Level 2, 608-610 Liverpool Road, South Strathfield NSW 2136 Australia ☎ 61-2-9764 8300 ☉ Monday - Friday, 9am - 5pm (AEST)	☎ Australia: 1800-025-544 (Toll Free) ☉ Monday - Friday, 9am - 8pm (AEST) ☎ New Zealand: 0800-447-361 (Toll Free) ☉ Monday - Friday, 11am - 7pm (Auckland Time)
<b>Logitech Electronic India PVT Ltd</b>	MMTC House, Suite 603, 6th Floor C-22, Bandra Kurla Complex, Bandra East Mumbai 400 051, India ☎ 91-22-2657 1160 ☉ Monday - Friday, 9.30am - 6.30pm (IST)	☎ 000 800 600 1133 (Toll free) ☉ Monday - Friday, 9.30am - 6.30pm (IST)
<b>Logitech Asia Pacific Ltd</b>	Hong Kong Sales & Marketing 18/F, Cambridge House, Taikoo Place, 979 King's Road, Quarry Bay, Hong Kong. ☎ 852-2821-5900 ☉ Monday - Friday, 9am - 6pm	☎ 800-966-992 (Toll free) ☉ Monday - Friday, 9am - 6pm
<b>로지텍 코리아</b>	서울시 영등포구 여의도동 12-12 CMM 빌딩 708B	☎ 00798-601-8207 (수신자 부담) ☉ 월-금, 9:30 AM to 5:30 PM







[www.logitech.com](http://www.logitech.com)

© 2011 Logitech. All rights reserved. Logitech, the Logitech logo, and other Logitech marks are owned by Logitech and may be registered. All other trademarks are the property of their respective owners. Logitech assumes no responsibility for any errors that may appear in this manual. Information contained herein is subject to change without notice.

621-000074.002