

Dual Connect

Dual Channel
Bluetooth
Keyboard



Button

OFF/ON



Switch: Slide the switch to power on/off the device.

Fn+C

Press fn+c for 2 to 3 seconds to make device turn the match mode on.

CH1 ↔ CH2



Slide the button to change the channels.

LED



Caps lock light



Connection light: when the device powers on, the light flashes quickly, press fn + c button for 2 to 3 seconds, the light flashes slowly to connect.



Charging light: the device needs to be charged when the light flashes and turns red. During charging, the light shows red. When the red light turns off the device is fully charged.

Product Appearance And Multimedia Function Keys Introduction

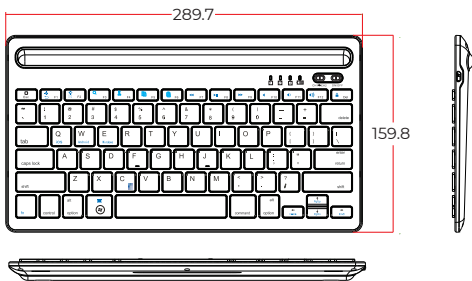

Windows System

Esc	Browser home page	⏪	Last song	✂	Cut
	Windows menu	▶	Play/Pause		Copy
	Search	▶▶	Next song		Paste
	Not applicable	⏸	Mute		Not applicable
	Not applicable	🔊	Volume down	Fn	Second function key
	Not applicable	🔊	Volume up		Lock screen

Android System

	Home page		Mute	Fn+End	Takes cursor at bottom
	Not applicable		Volume down	Fn+PgUp	Takes cursor to top
	Search		Volume up	Fn+PgDn	Takes cursor to next
	Home page		Cut	Ctrl+C	Copy
	Not applicable		Copy	Ctrl+X	Copy
	E-mail		Paste	Ctrl+V	Paste
	Last song		Not applicable	Ctrl+Z	Repeat
	Play/Pause		Second function key		Lock screen
	Next song		takes cursor to top		

ios System

	Home page		Mute	Fn+Home	Takes cursor to top
	Not applicable		Volume down	Fn+End	Takes cursor at bottom
	Search		Volume up	Fn+PgUp	Takes cursor to top
	Not applicable		Opens the soft keyboard	Fn+PgDn	Takes cursor to next
	Brightness decrease		Cut	Comd+A	Select all
	Brightness increase		Copy	Comd+C	Copy
	Last song		Paste	Comd+V	Paste
	Play/Pause		Not applicable	Comd+X	Cut
	Next song		Lock screen	Fn	Second function key

Bluetooth Keyboard Connection

Windows, Android, and iOS three in one system

1. Unlock the tablet, enter into "Start" interface
2. Click "Setting" and then choose "Change the setting"
3. Click "Wireless", turn on the Bluetooth
4. Click "Device", choose to add the devices
5. Turn on the Bluetooth keyboard, the blue light will twinkle quickly. Press Fn + C for 2 to 3 seconds, so the keyboard will search the device
6. The tablet will show BT 3.0 Keyboard, click it to pair
7. The blue light will turn off, if paired successfully. Password is not needed while pairing.

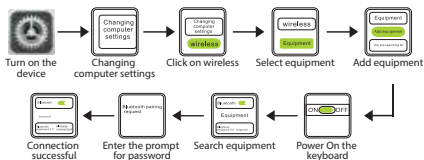

Tips

1. If you want the Bluetooth keyboard to connect with a Smartphone, laptop or desk computer, they should have an inbuilt Bluetooth.
2. When you turn on the Bluetooth keyboard for the second time, it connects automatically.
3. The letter '?' should be the same color as Fn, when you want to get Fn + ? function.

Channel switch function

The Bluetooth keyboard has two channels, it works on two devices at the same time, just by switching the channel.

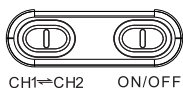

1. During first connection, the button should be at CH1 position, connect with your first device, then slide the button at the CH2 position, connect with your second device.
2. If you just need use your first device, keep the button at the position of CH1; if you need to use your second device, just switch the button to CH2 position.

Tips

1. When the keyboard restarts, no need to press any keys on Android or Windows devices. Just wait for 3 to 5 seconds, it will automatically get connected. iOS devices may take little longer to connect.
2. The keyboard is a three-in-one system with two channels. The connection time is different according to the brand of tablet, smartphone, computers and their bluetooth version.

Compatibility

1. Android 3.0 or above
2. iOS 4.0 or above
3. windows XP, Window 7 or above

Sleep mode

The device will enter sleeping mode if not used for 10 minutes. When in sleep mode, press any key and wait for 3 seconds to wake up the screen.

Charging

When the indicator light changes to red & starts flashes, it needs charging.

1. Plug in the keyboard to the charging port
2. Plug USB into the adapter or the USB port of a computer
3. The red light will indicate product charging. The light will turn off when the product will be fully charged.



Description and specification

1. Working distance: 8 to 10 meters
2. Bluetooth version: Bluetooth 3.0
3. Working time: More than 40 hours
4. Stand by time: Around 6 months
5. Charging time: 2 to 3 hours
6. Weight: 675 grams
7. Dimension: 289.7 x 159.8 x 16 m

Safety instruction

- ⚠ Warning: Negligence in following the manual may cause fire, damage to device or electric shock. Keep the product:
 - ✗ Far away from sharp tools
 - 🔥 Far away from microwave
 - ✗ From squeezing
 - ✗ From curving
 - ⚠ Far away from oil, chemical material or organic solvent

MAINTENANCE INSTRUCTION

1. If device not use for long time, better turn off the keyboard in order to make the battery last long.
2. For batteries to last long, charge the keyboard when the indicator light is twinkling.
3. If you charge the keyboard while using, you must use original cable otherwise it may not function properly.



DualConnect

Dual channel bluetooth wireless keyboard

Imported & Distributed by: iGear Tech Pvt. Ltd.

Brand: iGear

Model No.: iG-BK100

Warranty: 1year

Regd. Office: 204, Sai Corporate Park, Laxmi Nagar, Off Link Road,
Goregaon West, Mumbai - 400104.

Customer Care no.: 1800 22 8495 (Between 10 am-5 pm, Mon-Fri)

Email: sales@igear.asia