

Kuvings

WHOLE SLOW JUICER

KUVINGS COLD PRESS WHOLE SLOW JUICER MANUAL

- Read this manual carefully to understand operation of your Cold Press Juicer
- You can visit our website www.kuvingsindia.in
- For any questions, call us at 1800-102-2239



 www.kuvingsindia.in

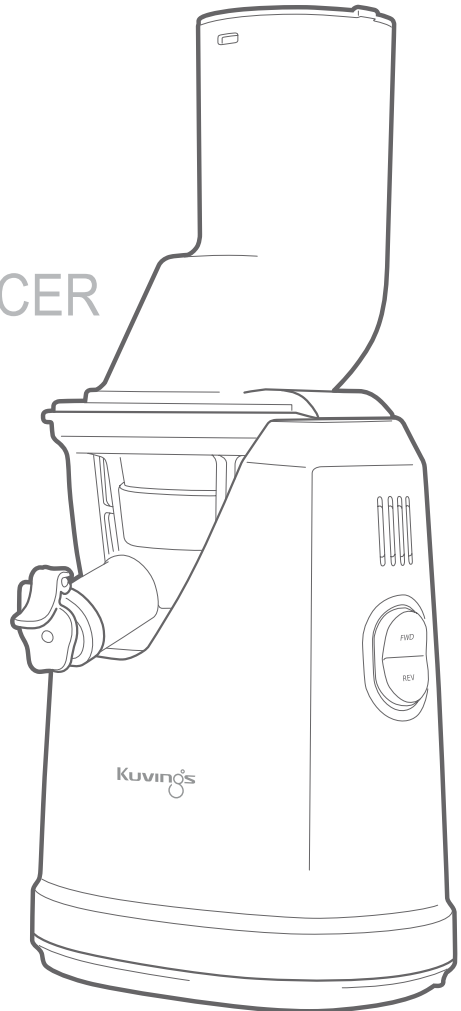

 +91 8928866736

 info@kuvingsindia.in

 1800-102-2239

SPECIFICATIONS

Product	Cold Press Juicer
Model	B1700 Dark Silver/Red/Pearl White(Limited Edition)
Voltage	AC220-240V, 50/60Hz
Power Consumption	240W
Maximum Use	30 minutes
Weight	10.3 kg (Gross)
Dimension	229 x 210 x 450 (mm)
Motor Type	100% Copper Wound Brushless AC Motor

IMPORTANT SAFEGUARDS

When using electrical appliances, basic safety precautions should always be followed including the following:

1. Read all instructions.
2. To protect against risk of electrical shock do not put motor or base of unit in water or other liquid.
3. Keep away from children.
4. Unplug from outlet when not in use, before putting on or taking off parts, and before cleaning.
5. Avoid contacting moving parts.
6. If the supply cord is damaged, it must be replaced by the manufacturer, its service agent or similarly qualified persons in order to avoid a hazard.
7. The use of attachments not recommended or sold by the manufacturer may cause fire, electric shock or injury.
8. Do not use outdoors.
9. Do not let cord hang over edge of table or counter.

10. Always make sure juicer cover is clamped securely in place before motor is turned on. Do not unfasten clamps while juicer is in operation.
11. Be sure to turn switch to OFF position after each use of your juicer. Make sure the motor stops completely before disassembling.
12. Do not put your fingers or other objects into the juicer opening while it is in operation. If food becomes lodged in opening, use food pusher or another piece of fruit or vegetable to push it down. When this method is not possible turn the motor off and disassemble juicer to remove the remaining food.
13. Do not use the appliance if the rotating sieve is damaged.
14. When a separable pulp container is provided, do not operate without the pulp container in place.
15. Please do not alter the appliance in anyway.
16. Do not use the appliance for anything other than it's intended purpose as described in the manual.
17. The appliance should be used for limited period of time.
18. This appliance cannot be used by children and persons with reduced physical, sensory or mental capabilities or lack of experience and knowledge. Children shall not play with the appliance. Cleaning and user maintenance shall not be made by children.
19. This appliance is not intended for use by persons(including children) with reduced physical, sensory or mental capabilities, or lack of experience and knowledge.

SAVE THESE INSTRUCTIONS

- This appliance is for household use only. Please carefully follow the instructions in the manual.
(The appliance cannot be covered under the manufacture warranty if the product is abnormally or commercially used.)
- Save the instruction manual for future reference
- If the appliance is given away as a gift, please include the manual with the product.



SAFETY WARNING

The following precaution is provided to ensure the safety of the user. Please carefully read through the precautions and exercise a degree of care when using the appliance.

 **Warning** : Warns risk of death or severe injuries.

 **Caution** : Warns risk of injuries or appliance damage.

 Prohibited

 Follow instruction

 Unplug from the outlet

 Do not disassemble

 Must take action

 Be cautious of electric shock

 Do not plug multiple power cords on a single outlet during operation.
→ It may cause an explosion or fire.

 Do not touch the power cord with wet hands.
→ It may cause electrical shock.

 Do not leave the appliance unattended. Unplug the power cord from the outlet when not in use.









 Use a dry towel to clean the power cord if it is dirty or wet.
→ It may cause electrical shock or fire.

 Do not drop the appliance nor inflict strong force to the appliance.
→ It may damage or break the appliance.

 Do not unplug by pulling off the power cord cable.
→ It may damage the power cord and cause electrical shock.

 Do not put your finger or other objects into the feeding tube while it is in operation.
→ It may cause injury.



-  Do not put the parts in the dishwasher or extremely hot water.
→ The parts may wear faster.
-  Do not repair, disassemble the body, or customize the appliance.
→ The appliance may not operate properly causing fire, electrical shock, or injury.
-  Do not use the appliance on an uneven surface.
→ It may cause a malfunction if the appliance tips over.
-  Keep away from children and store the appliance in a safe place.
→ It may cause injury.
-  Please do not store or operate the appliance nearby heating appliance.
→ The appliance may become discolored or deformed.
-  Do not use any hazardous chemicals to clean the appliance or spray flammable sprays near the appliance.
→ It may change the color of the appliance or could result in a fire.
-  To protect the power cord, please do not aggressively bend or put heavy object on top of the power cord.
→ It may cause short circuit or even fire.
-  Operating the juicer without ingredients can cause damage to the screw.
-  For cleaning parts that come in contact with food, please follow the instruction on pages 18-20.

PARTS

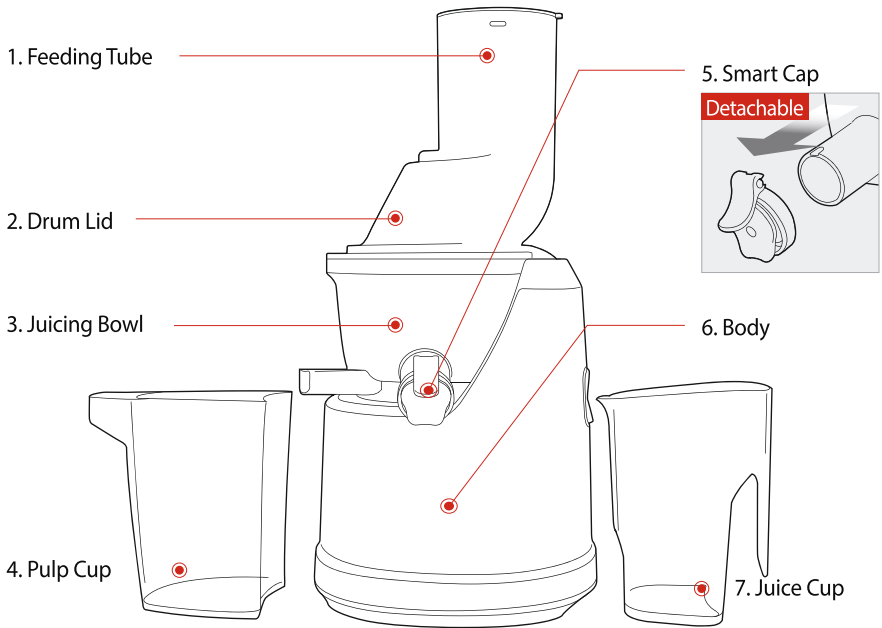

8. Rotation Wiper

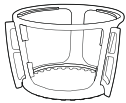

9. Strainer



10. Juicing Screw



11. Pusher

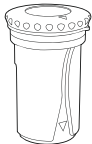

12. Cleaning Brush



13. Rotating Brush



* The products illustrated/photographed in this booklet may vary slightly from the actual product.

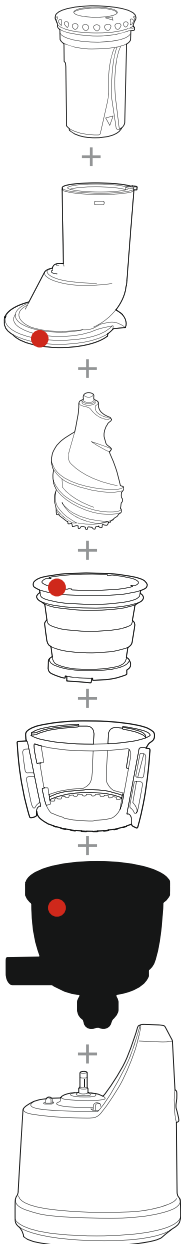

Pusher

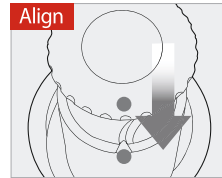

Align the dots ● and slide the pusher in.

STEP 1

Top-set Assembly

Align the red dots ● on each part and assemble in the order shown. Once assembled, turn the drum lid clockwise to close.

STEP 2

Top-set and Body Assembly

Place the drum lid on the juicing bowl. Align the down arrow ▼ on the drum lid with the ▽ OPEN mark on the body and turn to the ▲ CLOSE position.

HOW TO ASSEMBLE

STEP 1 Top-set Assembly

Check Before Operating

- Wash the parts before first use.
- Ensure that the compression silicone and silicone ring are assembled properly.

- 1** Firmly insert the compression silicone into the slot below the pulp spout.

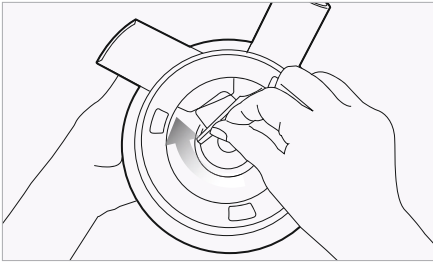

Note | The Juicer may leak if not assembled properly.

- 2** Assemble the strainer into the rotation wiper then place this assembly in to the juicing bowl ensuring the red dot on the strainer is aligned with the red dot on the juicing bowl.

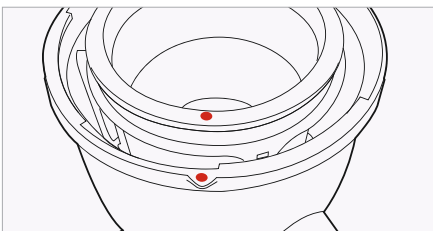
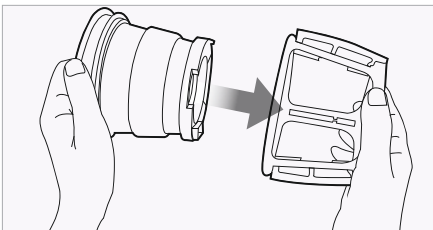

- 3** Place the juicing screw into the strainer. Turn and press down on it until it clicks into place.

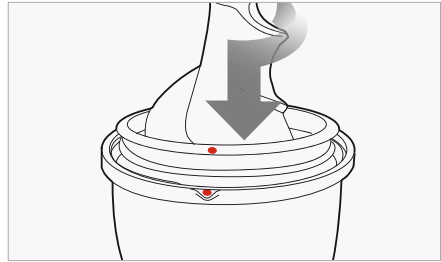

Note | The juicing screw needs to be locked in place in order to close the drum lid.

- 4** Place the drum lid on to the juicing bowl aligning the red dot on the drum lid with the red dot on the juicing bowl. Turn clockwise to close, aligning the red dot on the drum lid with the close mark.

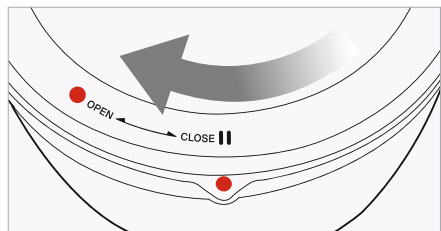
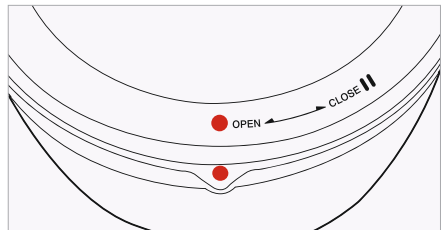

STEP 2 Top-set and Body Assembly

TIP For easy assembly hold the drum lid by grabbing the feeding tube and turn clockwise as shown in the illustration.

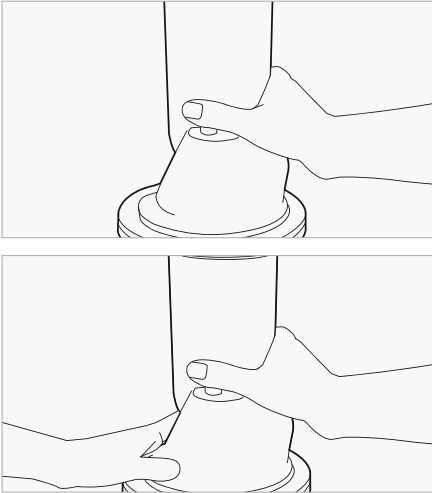

5 Place the drum lid on the juicing bowl. Align the down arrow ▼ on the drum lid with the ◻ OPEN mark on the body and turn to the ▲ CLOSE position.

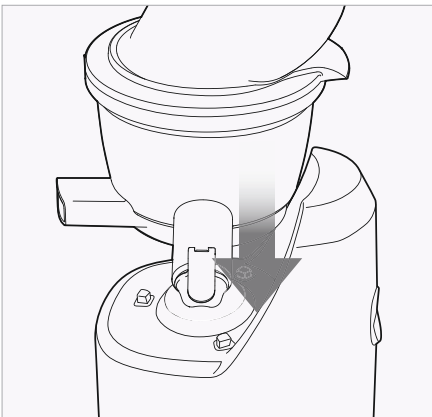

6 Open/Close mark on the top-set.

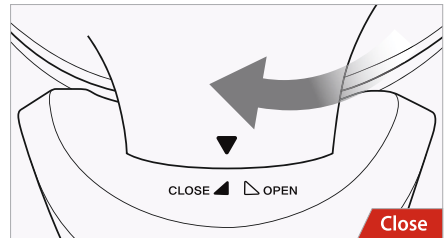
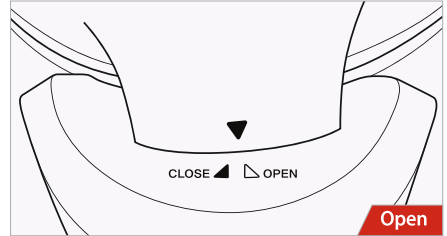

Note | The juicer will not operate if the down arrow ▼ on the drum lid is not completely aligned with the CLOSE mark on the body.

7 Place the pulp cup under the pulp spout and place the juice cup under the juice spout as shown in the illustration.



HOW TO OPERATE

STEP 1 After preparing the ingredients, plug the power cord into a wall outlet.

- Note |
- Do not touch the power cord with wet hands. It may cause electrical shock, short-circuit, or fire.
 - Ensure the power cord is plugged into a power outlet.

STEP 2 Press the FORWARD button to operate.

- Note |
- Forward: Pulls down and slowly masticates the ingredients.
 - Reverse: Pushes the ingredients back up to dislodge them.

If the ingredients become jammed in the screw and the drum lid does not open, press the OFF button. Then press and hold the REVERSE button until the ingredients become dislodged. Repeat REVERSE - OFF - FORWARD as often as needed to achieve the desired result.

If the juicer stops during operation:

Switch the button to OFF position then press and hold the REVERSE button until the ingredients become dislodged.

Repeat REVERSE - OFF - FORWARD as needed.

FORWARD : Pulls down the food
OFF : Stops the operation
REVERSE : Pushes the food back up



- Note |
- REVERSE: Pushes the ingredients back up to dislodge them. The REVERSE button only works while holding down the switch.
 - Switch OFF ensuring that the juicer comes to a complete stop. Then press REVERSE. Hold the REVERSE button for 2-3 seconds and release. Repeat as needed. Let the juicer stop completely before using the REVERSE button to prevent malfunction.
 - If the juicer does not work after these steps, disassemble and clean the parts before operating the juicer again.

STEP 3 Insert the prepared ingredients into the feeding tube, one piece at a time.

- Note** |
- Fibrous leafy vegetables (celery, kale, etc.):
 - » Separate each stem. Cut the outer stems that are thick and tough to 2 inches long or less.
 - » Bundle up the leafy vegetables as inserting into the juicer. Alternate between leafy parts and stems.
 - Before extracting, remove hard seeds or pits in ingredients.
 - When juicing frozen fruits with small seeds, ensure that even the seeds are completely thawed.
 - Insert the ingredients one piece at a time.

- Tip** |
- Align the dots ● and slide the pusher in.
 - After inserting ingredients, use the pusher when it is necessary. Too much use of the pusher may affect the juice quality.
 - » Intermittently use the pusher for soft ingredients like tomatoes and apples. Constant use of pusher for soft ingredients may affect the juice quality.

STEP 4 Use the smart cap to make mixed juices, stop juice from dripping, or rinse between different juices.

- Tip** |
- Juicing with the smart cap closed creates various mixed juice creations when different fruits and vegetables, milk, banana, beans etc. are selected.
 - After juicing, close the smart cap to stop the juice from dripping, especially when disassembling the juicing bowl off the body.
 - When making different juices quickly rinse away any leftover flavors by running a glass of water in the juicer with the smart cap closed.

- Note** |
- Leave the smart cap open when juicing ingredients that create excessive foam during extraction, (e.g. apples, celery).
 - Pay close attention when operating with the smart cap closed. Juice may overflow if the juice collected in the juicing bowl exceeds its capacity marked on the bowl.

STEP 5 After juice and pulp are completely extracted, switch the unit OFF.





- Note** |
- If the remaining ingredients in the juicing bowl have not been extracted completely, the drum lid may not open easily. After each extraction, run the juicer for an additional 30 seconds to let the juicer extract the remaining pulp.
 - When the drum lid is stuck, press the REVERSE - OFF - FORWARD button in this order; switching back and forth 2 or 3 times to dislodge the ingredients. Then place hands on top of the drum lid and firmly press down while simultaneously turning the drum lid counter clockwise to open.
 - » Depending on the ingredients, pour water down the feeding tube to rinse out the interior of the juicing bowl and then attempt to remove the drum lid.

TIPS ON OPERATION

- 1. Operating the juicer without ingredients can cause damage to the screw.**
- 2. Do not continuously operate the juicer for more than 30 minutes.**
This can damage the motor from overheating. After continuous use, let the juicer rest for 30 minutes to cool down before starting another session.
- 3. Do not put hand, utensil, tong, or other objects into the feeding tube other than the provided pusher.**
- 4. During operation, do not put spoon, spatula or other objects into the juice spout of the juicing bowl.**
If other object is put into the juice spout during operation, such materials can get stuck and damage the juicer parts.
- 5. Do not put dried whole grains, fruits with hard seeds or ice.**
These may damage the juicer parts (e.g. juicing bowl, juicing screw, and strainer).
 - Beans or grains can be used if soaked overnight or boiled.
 - Fruits with pits and hard seeds (e.g. nectarines, peaches, mangoes and cherries) must be pitted before juicing.
 - **When using frozen fruits with small seeds such as grapes, completely thaw before inserting them into the juicer.**
 - Use of ice in the juicer will decrease the product durability over time.
- 6. Do not use ingredients containing excessive amounts of vegetable oil or animal fat. Do not use the juicer to extract vegetable oil from ingredients.**
If vegetable/animal oil gets on the juicing screw, it may reduce performance and even damage the part.
- 7. Do not reinsert the extracted pulp into the juicer. This can cause the juicer to stop or cause the drum lid not to open.**
- 8. After juicing ingredients with seeds like grapes, thoroughly clean all the crevices on the bottom of the juicing screw.**

Juicer damage due to owner negligence or from not following the instructions in the owner’s manual will void the warranty service.

DO NOT put the following ingredients into the juicer:

Hard seeds		Peach, nectarines, apricot, plum, mango, etc. Remove hard seeds from the ingredients before juicing.
Hard or inedible skins		Pineapple, melon, mango, orange, etc. Peel the skins from the ingredients before juicing.
Frozen fruits or ice		Frozen strawberry, blueberry, raspberry, etc. Completely thaw frozen fruits before juicing. Do not use ice.
Vegetable/ animal oil		Sesame seed, butter, margarine, etc. Do not extract ingredients containing vegetable or animal oil. This can reduce performance and even damage the juicer.
Others		Coconut, sugarcane, whole grains, etc. Do not extract ingredients with no water content.

Experience the best quality juice by understanding each ingredient’s characteristics and knowing the optimal way of handling the ingredients.

The Slow Juicer is an innovative product that uses a patented slow-speed masticating technology to efficiently extract the juice from ingredients. The juicer is designed to obtain the best result from ingredients with firm composition and with high water content. For best result, each ingredient should be prepared and extracted depending on its characteristics and properties.



INGREDIENTS PREPARATION

Before Operating:

- Before Operating: If the juicer is jammed or if the drum lid does not open, press the REVERSE button and hold until it becomes dislodged. Repeat REVERSE-OFF-FORWARD as needed.
- Continue operating the juicer until all the ingredients in the juicing bowl are extracted. The drum lid may not open easily if there is a lot of pulp remaining in the juicer.
- Every ingredient yields different amounts of juice.

Juice Yield:

- For the optimal extraction and maximum juice yield, cut the ingredients following the guidelines given in this section.
- **Insert ingredients slowly monitoring how the ingredients are extracted.** The juice yield may vary depending on the juicing speed.

Soft fruits and vegetables (e.g. oranges, tomatoes):

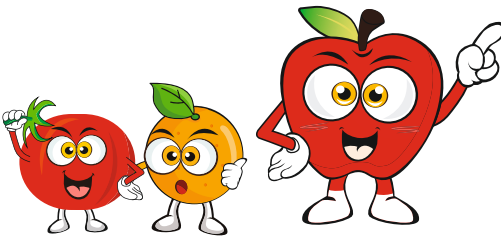

1-4 wedges

- Peel the skin off oranges, and for tomatoes and apples, take out the stem.
- If the ingredients are larger than the feeding tube, cut the ingredients into pieces that will fit into the feeding tube.
- Fruits with seeds must be pitted before extraction. Cut to 1-4 wedges then slowly insert the ingredients down the feeding tube.

PREPARATION TIPS:

- Cut 1-4 wedges.

EXTRACTION TIPS:

- Slowly insert the ingredients one piece at a time.
- Use the pusher to push the ingredients down the feeding tube. (The pusher also helps prevent juice from spraying out of the feeding tube when extracting ingredients with high water content)
- **Leave the smart cap open when juicing ingredients that create excessive foam during extraction.** (Foam can accumulate if operated with the smart cap closed.)
- It is recommended that the extracted juice be consumed within 48 hours after extracting. Depending on the density of the ingredients the extracted juice can gradually show layers over time.
- If there is an excessive amount of foam, use a mesh strainer to separate it from the juice.
- When an ingredient is being masticated by the juicing screw, the squeezed ingredient may splash juice through the feeding tube. Use the pusher to block out the juice splash when juicing.

How to Use the Smart Cap:

- Juicing with the smart cap closed allows mixed juice creations with different fruits, vegetables and liquids.
- After juicing, close the smart cap to block excess juice from dripping, especially when disassembling the juicing bowl off the body.
- When making different juices quickly rinse away any leftover flavors by running a glass of water in the juicer with the smart cap closed.
- **Leave the smart cap open when juicing ingredients that create excessive foam during extraction (e.g. apples, celery).**
- Pay close attention when operating the juicer with the smart cap closed. Juice may overflow if the juice collected in the juicing bowl exceeds its capacity marked on the juicing bowl.

Adjusting the amount of pulp in the juice:

- Depending on the ingredient, you may get extra pulp in the juice when juicing continuously.
- To reduce the amount of pulp, disassemble the top-set and wash frequently.

Hard fruits and vegetables (e.g. carrots, potato, beets & spinach):

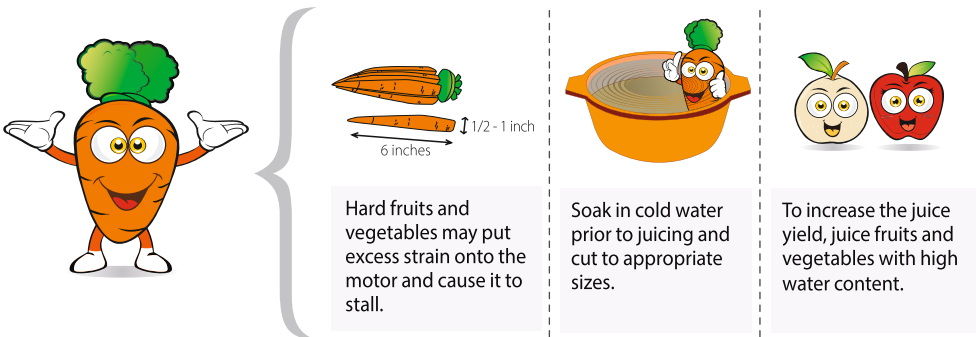

Hard fruits and vegetables may put excess strain onto the motor and cause it to stall.

Soak in cold water prior to juicing and cut to appropriate sizes.

To increase the juice yield, juice fruits and vegetables with high water content.

PREPARATION TIPS:

- Slice the ingredients 1 inch thick or cut 1 inch wide and 2-6 inches long.
- Soak hard ingredient like carrots and ginger in cold water prior to juicing.

EXTRACTION TIPS:

- Slowly insert the ingredients one at a time.
- **Pace the juicing speed ensuring each ingredient is thoroughly extracted.**
- To maximize the juice yield, juice with ingredients with high water content.

INGREDIENTS PREPARATION

Ingredients with small seeds (e.g. raspberry, pomegranate, grape):

Slowly insert ingredients with small seeds to prevent the seeds from clogging the strainer.

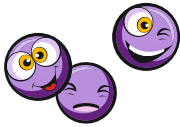

Insert ingredients slowly to minimize the amount of leftover seeds in the strainer.

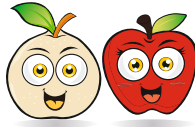

For best result, juice with ingredients with higher amount of fluid.
(e.g. apple, pear)



PREPARATION TIPS:

- When juicing frozen ingredients(e.g. raspberry, strawberry), make sure they are completely thawed.
- Thoroughly rinse ingredients like grapes. Take the grapes off and discard the stem.
- For pomegranate, discard the skin and juice only the inner part.

EXTRACTION TIPS:

- Depending on the size of the grape, insert 3~5 grapes at a time while monitoring the extraction result.
- Thaw frozen ingredients like pomegranate and raspberry then insert about 1 tablespoon (5g) at a time.
- Frozen ingredients usually lose significant amount of fluid from thawing. When juicing, mix milk or yogurt to balance the fluid lost.

⚠ Caution | If the lid does not open due to excessive amount of small seeds left in the juicing bowl, continuously run the juicer for 30 second to extract any leftover seeds. If the lid is still stuck, **repeat REVERSE - OFF- FORWARD** until the ingredients become dislodged. Then twist the lid to open while pushing downwards on the lid with palms(depending on the ingredient, pour some water down the feeding tube for quick rinsing to help dislodging).

Fibrous and/or tough leafy ingredients (e.g. celery, kale, pineapple):

Fibrous ingredients like celery and kale should be cut into small lengths before juicing.

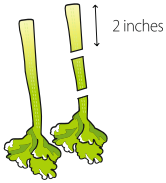

When juicing leafy ingredients like celery and kale, do not collect more than 500g per session. For best result, disassemble and wash the top-set before juicing again.



If leafy ingredients wrap around the juicing screw, open the lid and remove the fibers before continue juicing.

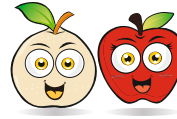

It's best to juice with ingredients with higher amount of fluid, like apples or carrots.

Carrots, apples : fibrous ingredients = 9:1
[recommended ratio]



PREPARATION TIPS:

- Soak fibrous ingredients in cold water for about 30 minutes before cutting them.
- Separate each stem. Cut the outer stems that are thick and tough to **2 inches long or less**.

EXTRACTION TIPS:

- One at a time, slowly insert the prepared ingredients.
- Insert more ingredients after the previously inserted ingredients have been completely extracted.
 - ① Roll leaves in spiral as inserting into the juicer.
 - ② Insert the leafy part of the ingredients first then alternate between leafy parts and stems.
 - ③ For ingredients like wheatgrass, grab a handful and insert in a bundle.

- ! Caution** |
- **The fibers from tough ingredients like celery** can wrap around the juicing screw and affect juicer's performance. Cut the stems that are thick and tough to **2 inches long or less**.
 - Foam can build up from juicing fibrous ingredients. Use strainer to remove the foam before serving.
 - **For ingredients like pineapple**, slice off the rind of the pineapple and cut around the fibrous core. Cut the flesh of the pineapple to smaller pieces.
 - Recommended amount of juicing per session is 500g. When juicing more than 500g, wash the top-set before continue juicing.

HOW TO DISASSEMBLE AND CLEAN

- 1 Switch OFF and unplug the power cord from the wall outlet.

- Note |
- Extract all the remaining pulp in the juicing bowl before stopping the juicer.
 - For easier clean up, operate the juicer for an additional 30 seconds after the juice is extracted.
 - When the drum lid is stuck, press the REVERSE - OFF - FORWARD button in this order, switching back and forth 2 to 3 times to dislodge. Then place both hands on the drum lid and firmly press down while simultaneously turning the drum lid to open.
* Fill the juicing bowl with water and run the juicer before opening the drum lid. It may help to open the drum lid when stuck.

- 2 Turn the drum lid counter clockwise to open.

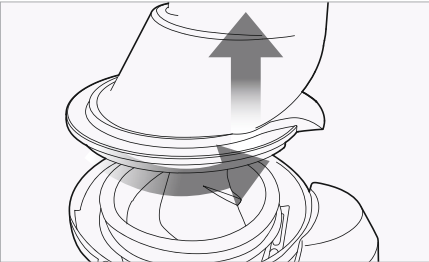

- Note |
- When moving the appliance, do not lift by grabbing the feeding tube. Always lift the appliance by grabbing the body or handle.

- 3 Turn the top-set counter clockwise and lift off the body.

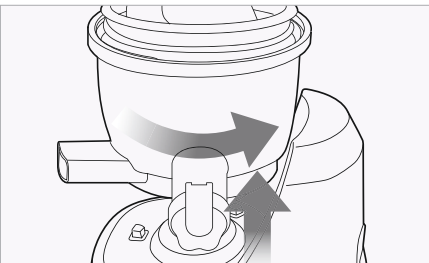

- 4 Remove the juicing screw, strainer and rotation wiper unit from the juicing bowl. Clean with provided brush.

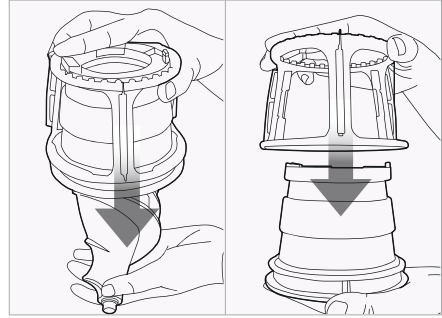

- Note |
- Immediately clean the juicer after each use. If remaining residue in the juicer dries up, it can make disassembling and cleanup difficult. The excess build up can cause poor performance in future uses.
 - For easier disassembly, place the topset in the sink and run the water through from the top of the top-set.
 - Thoroughly dry the bottom of the juicing screw.

- 5 Place the juicing bowl under running water and unplug the compression silicone to clean the pulp spout.

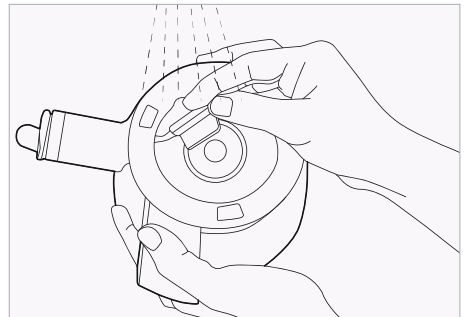

- Tip |
- Soak the Juicing bowl in a solution of warm water with baking soda or little bit of bleach to clean the excess build up.

- 6** Under running water, clean the outside of the juicing screw with a dish scrub. Use the tip of the cleaning brush to push out any residue in the crevices on the bottom of the juicing screw.

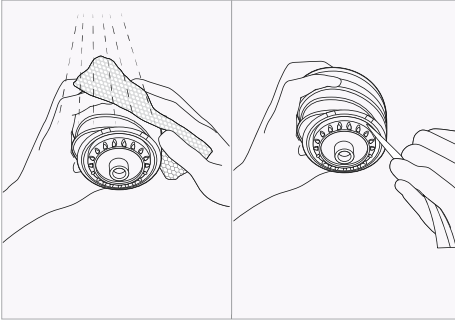

- Tip** | • Thoroughly clean the juicing screw ensuring that the juicing screw is clean without any residue.
• Completely dry before using.

- Note** | • After juicing ingredients with seeds, make sure to thoroughly clean the bottom crevice of the juicing screw. (If this area isn't properly cleaned, it can cause the part to be damaged.)

- 7** Clean the body with a soft damp towel and dry.



- Note** | • If the towel is dripping wet, make sure to squeeze out the excess liquid before using it on the juicer.

Quick Rinsing

- 1** With the smart cap closed, fill the juicing bowl with water and turn on the juicer.

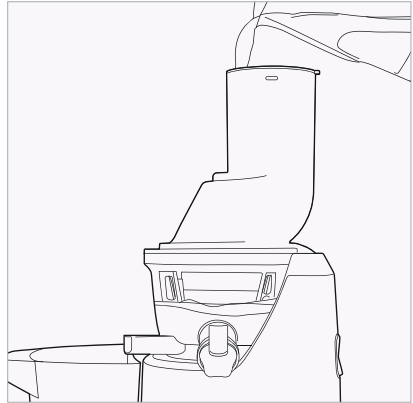

- 2** Let it run for a moment. Open the smart cap and let the water run out of the juicing bowl.



- Tip** | • It is not necessary to completely clean the juicer in between making multiple juices during a single juicing session.
• When finished with juicing, always disassemble and clean thoroughly between juicing sessions to prevent residue buildup.

HOW TO CLEAN SILICONE PARTS

Tip | Clean the rotation wiper under running water. Thoroughly dry after cleaning. Before assembling the top-set, ensure that the compression silicone and silicone ring are firmly inserted.

Note | If the compression silicone and silicone ring are not firmly inserted, juice may leak from the bottom of the juicing bowl.

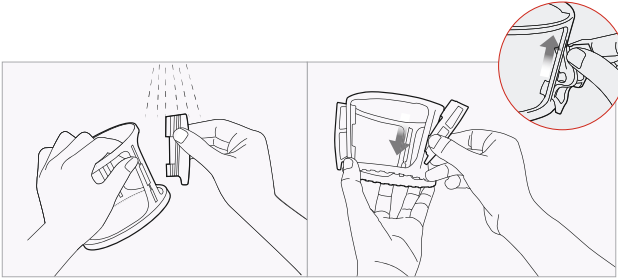

Silicone Brush

Pull out the silicone brush from the rotation wiper to clean. After cleaning, insert into the slot with the tail pointing down as shown in the illustration.

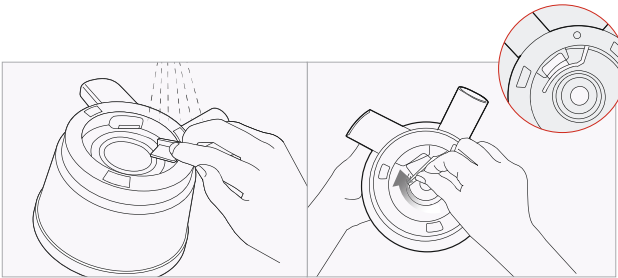

Compression Silicone

Unplug to clean. After cleaning firmly insert into the slot below the pulp spout.

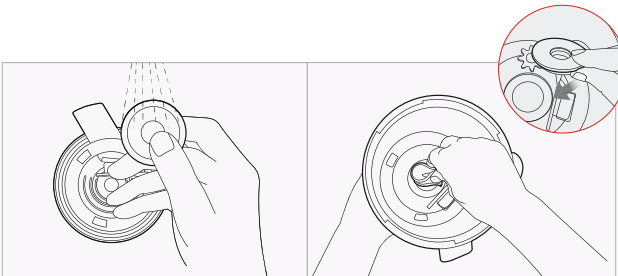

Silicone Ring

Remove the silicone ring from strainer to clean. After cleaning, push in the silicone ring.

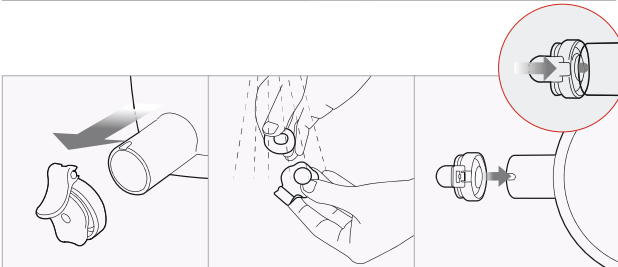

Smart Cap

Remove from the juice spout to clean. After cleaning, attach the smart cap to the smart cap silicone on the juice spout.

*The products illustrated/photographed in this booklet may vary slightly from the actual product.

Tip | The cleaning tool makes clean-up quick and easy.
Completely dry after cleaning.

Note | Use the included cleaning brush to remove hard to reach bits after using the cleaning tool.

1 Hold the cleaning tool with one hand and insert the strainer into the cleaning tool.

Note | Insert the strainer until you hear a click.

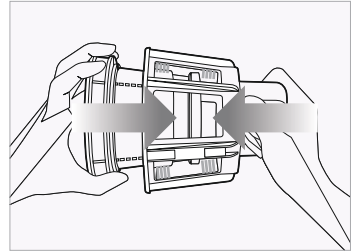

2 Under running water, rotate the cleaning tool and the strainer in opposite directions to clean.

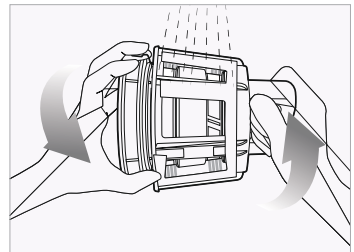

3 Thoroughly rinse the inside and outside of the strainer under running water.

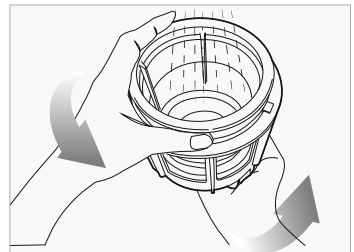

4 After cleaning, remove the strainer from the cleaning tool. Dry before storing.

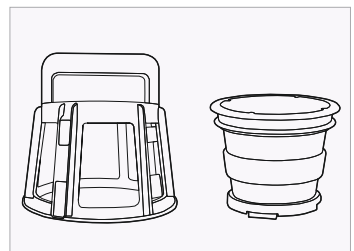

TROUBLESHOOTING Q&A

■ When there is no power to the juicer:

- Check if the power cord is properly plugged in.
- Check if the drum lid and the juicing bowl are properly assembled.
- Check if the top-set and the body are properly assembled.
- **Juicer will not operate if parts are not assembled properly.**

■ Low juice yield:

- Different ingredients hold different amounts of fluid that will yield different amounts of juice.
- If the ingredients are not fresh, they may contain reduced amounts of fluid, which will yield less juice.
- Check if the compression silicone is firmly inserted.
- If the ingredient itself has low water content, it may help to soak it in water before juicing.
- If juicing ingredients with small seeds, after a few servings, it may reduce the juice yield. For best result, disassemble and wash the top-set in between juicing.
- **If there is seed residue on the bottom of the strainer, this can affect juicer performance and the overall juice yield.**

■ There is too much pulp in the juice:

- When continuously juicing, and depending on the ingredient, the juice may contain a lot of fine pulp.
- To reduce the fine pulp, clean the top-set frequently and extract the pulp.
- Use a mesh strainer and put the juice through it to collect the unwanted pulp.
- If the strainer and the screw are damaged and affecting the juicer's performance, it is recommended the parts be replaced.
***The lifetime of each part may vary depending on length and method of use and ingredients extracted.**
- If too many ingredients are inserted at the same time, it may cause the juicer to stop frequently. This can lead to pulpy juice. Insert the ingredients slowly and few at a time.

■ The drum lid will not close:

- Make sure the juicing screw is pushed all the way in to the strainer in order for the drum lid to close properly.
- **If the juicing screw is not properly in position, the drum lid may not close.**

■ Odd noise from the juicer:

- Check if the parts are assembled correctly. Try reassembling the parts and listen for the odd noise.
- Do not start the juicer unless there are ingredients and/or liquid in it.
- **Operating the juicer without ingredients can cause damage to the screw.**
- If the juicer is operated without ingredients or liquid, the noise level can increase and also can lead to damage.
- The friction noise from the juicing screw and the strainer will disappear when ingredients are inserted into the juicer.
- If the noise occurs when ingredients are inserted into the juicer, check the size of the ingredients. Do not insert anything over 1 inch in thickness.
- Depending on the type of ingredients, the dimensions can be smaller.
- **The noise can occur if the juicer is operated on an uneven or slanted surface. Place the juicer on a horizontally flat surface when operating.**

■ The extracted pulp is very moist:

- During the very beginning of extraction, the pulp can be more moist.
- Depending on the ingredient's condition, the extracted pulp can be affected; especially when the ingredient is not fresh, the juice can be extracted with the pulp.

■ During operation, the juicing bowl shakes.

- The juicing screw and the strainer are set up to crush and squeeze the ingredients. It is normal for the juicing screw and the strainer to vibrate.
- If the ingredient contains strong fiber, the vibration from the top-set may be stronger.

■ **During juicing, the juicer stopped:**

- Check the power cord and make sure it is plugged in correctly.
- Check that all the parts are correctly assembled.
- If too many ingredients are inserted at one time, this can cause the juicer to stop.
- When the juicer stops because there are too many ingredients inserted in it, press the REVERSE - OFF - FORWARD button in this order, switching back and forth 2 to 3 times.
- **The reverse setting will push the ingredients up, and the forward setting will pull the ingredients down.**
- If the juicer stops due to the overload protection, let the juicer cool for 30 minutes to 2 hours before juicing again.
- If there are hard seeds within the ingredients, remove them before juicing. Hard seeds can damage the juicer.

■ **Layers of separation in the juice:**

- Depending on the density of the ingredients, the extracted juice may show layers of different juices. It is different from separation due to oxidation caused by juicing with a high-speed juicer.

■ **The drum lid is stuck:**

- After juicing, let the juicer operate for another 30 seconds to extract the remaining pulp.
- If there is too much pulp in the top-set, this can cause the drum lid to not open. In this situation, press the REVERSE OFF - FORWARD button in this order, switching back and forth 2 to 3 times.
- **Pour water down the feeding tube to rinse out the insides and then try opening the drum lid.**

■ **Juice dripping down the body of the base:**

- If the compression silicone on the bottom of the juicing bowl is not plugged in correctly, the juice may seep out on to the juicer base. Before assembling the parts, check and make sure the compression silicone is plugged in correctly.

■ **Is it possible to juice ingredients with tough fiber?**

- Ingredients like celery or ginger contain long fibers that may wrap around the juicing screw and affect the juicer's performance. When juicing fibrous ingredients, do not collect more than 1 lb. of juice. After collecting this quantity or less, clean the top-set completely before juicing again.

■ **Discoloration of the plastic parts:**

- After juicing, if the juicer is not cleaned right away, the remaining pulp inside the top-set can dry up which can make disassembling and cleaning hard. This can also affect the juicer's performance and color.
- Ingredients that are rich in carotenoids such as carrots and spinach may dye plastic parts. When the parts are dyed with carotenoids, rub vegetable oil in to the dyed areas and use mild detergent to clean.
- **Vegetable oil should only be used during clean-up for parts that are discolored. Do not use vegetable oil on the juicing screw or the strainer. If vegetable oil or oil from animal fat gets on the juicing screw or the strainer, this can affect the juicer's performance and may result in damaged parts.**
- The silicone pieces on the top-set can be detached to be thoroughly cleaned.

■ **Using for purposes other than juicing:**

- This juicer is designed to juice ingredients like fruits and vegetables.
- Do not use the juicer for extracting vegetable oil.
- Do not juice ingredients with high contents of vegetable/ animal oil.
- If vegetable/animal oil gets on the juicing screw or the strainer, this can affect the performance of the juicer and could result in damaged parts.



Kuvings India Community

PAN INDIA PRESENCE OF **Kuvings**



@kuvingsindiaofficial

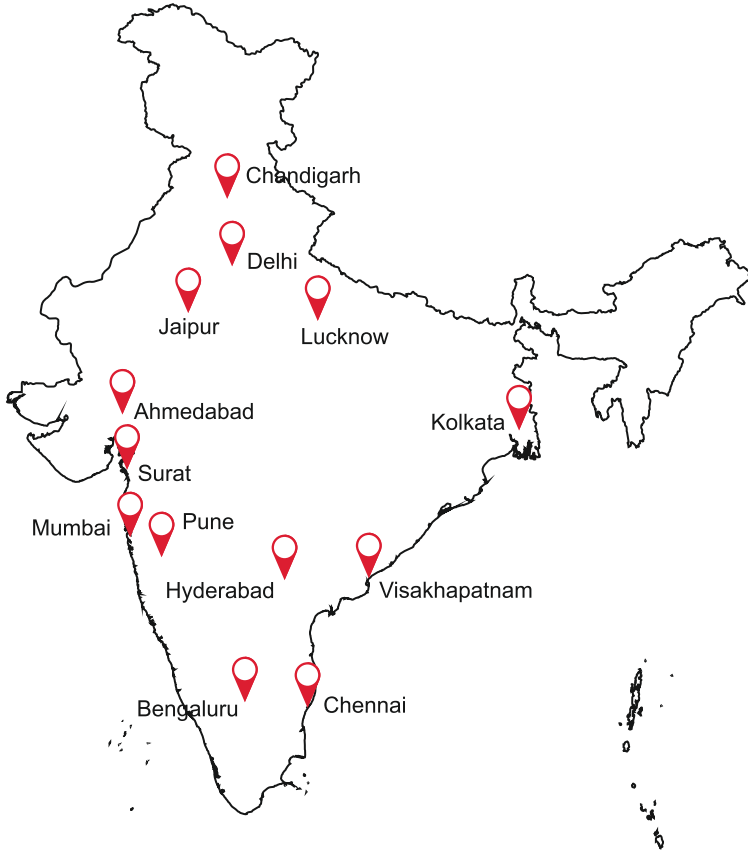

Call us on our toll free number 1800-102-2239 to register warranty and get 2 years extended warranty on motor



Motor



Motor



Other Parts

Headquarters: 280, Nowonro, Buk-gu, Daegu, 702-053, South Korea | Tel 82-53-665-5035, 82-53-665-5036

India Office: Unit No. 701-B, B Wing, One BKC, Bandra Kurla Complex, Bandra (East), Mumbai - 400051

Tel 1800-102-2239 | Website www.kuvingsindia.in | Email info@kuvingsindia.in

+91 8928866736