



# FOOD PROCESSOR

FP 3810



Instruction Manual



## CONGRATULATIONS!

You are now the proud owner of Usha Food Processor.

Innovatively designed, using only the highest quality material and components, your

Usha Food Processor is designed for years of trouble free performance.

Please read this Instruction Manual carefully before using and keep it cautiously after reading for future reference.

For detailed demonstration ,kindly scan the QR code or visit us on [WWW.USHACOOK.COM](http://WWW.USHACOOK.COM)



Best Wishes

# CONTENTS

## **KNOW YOUR USHA FOOD PROCESSOR**

Parts Description ..... 4-5

## **SAFETY PRECAUTION**

Safety Precautions ..... 6

## **ASSEMBLING THE FOOD PROCESSOR**

Food Processor Bowl Assembly..... 7-8

## **OPERATING YOUR USHA FOOD PROCESSOR**

Installation ..... 8-16

Technical Specifications ..... 16

## **CLEANING AND MAINTENANCE**

Maintenance ..... 17

Trouble Shooting ..... 17

Warranty Card ..... 18

Notes ..... 19

## SECTION 1

## KNOW YOUR USHA FOOD PROCESSOR:

01



MAIN UNIT

02



SPEED SELECTOR  
KNOB

03



PROCESSING BOWL\*

04



DETACHABLE DRIVING  
SHAFT/SPINDLE

05



TOP LID

06



PUSHER

07



ATTA KNEADING  
BLADE

08



CHOPPER

09



FINE SHREDDER  
/SLICER

10



COARSE  
SHREDDER/SLICER

11



FINGER CHIPS  
DISC

12



SPATULA

13



BLENDER JAR

14



BLENDER JAR  
COVER

15



WHISKER

16



MULTIPURPOSE JAR  
& LID

17



CHUTNEY JAR  
& LID

18



CITRUS JUICER

19



CITRUS CONE

20



CENTRIFUGAL  
JUICER

21



JUICER BOWL\*

22



JUICER LID

23



JUICER PUSHER

\* Juicer Bowl & Processing Bowl are common

## SECTION 2 SAFETY PRECAUTION

### WHEN USING ELECTRICAL APPLIANCES, BASIC SAFETY PRECAUTION MUST ALWAYS BE FOLLOWED:

1. Carefully read all instructions before operating and save for future reference.
2. This appliance is for normal household use only.
3. This appliance is not intended for use by persons (including children) with reduced physical, sensory or mental capabilities, or lack of experience and knowledge, unless they have been given supervision or instruction concerning use of the appliance by a person responsible for their safety.
4. Young children must be supervised to ensure that they do not play with the appliance.
5. If the supply cord is damaged, it must be replaced before further use by the manufacturer, its service agent or similarly qualified persons in order to avoid a hazard.
6. This appliance includes a safety switch which prevents operation unless the accessories are securely installed.
7. The temperature of accessible surfaces may be high when the appliance is operating.
8. To protect against risk of electric shock, fire or personal injury, do not immerse power cord, plug or motor base in water or any form of liquid.
9. Unplug when it is not in use and before cleaning.
10. Do not immerse Motor Base in water, neither rinse it under tap water.
11. Do not push food with fingers, or other objects (like knives), always use the enclosed pusher for feeding food.
12. Be extremely careful when handling blades and inserts, especially while assembling and disassembling, and cleaning after use. Blades are very sharp.
13. Do not let power cord hang over the edge of a table or counter, or touch any hot surface
14. Do not place the appliance near a gas outlet, electric burner, or heated oven.
15. Please wait till all the components stop running before unplugging the power cord and taking off the processing bowl.
16. Ensure the capacities shown in the Specifications section are not exceeded.
17. Always use a reliable earthed power supply to operate the appliance.
18. The appliances are not intended to be operated by means of an external timer or separate remote-control system.

## SECTION 3 ASSEMBLING THE FOOD PROCESSOR

**BEFORE USING YOUR FOOD PROCESSOR FOR THE FIRST TIME, WASH ALL PARTS AND ACCESSORIES EITHER BY HAND OR IN THE DISHWASHER (SEE “CLEANING THE FOOD PROCESSOR” SECTION).**

### FOOD PROCESSOR BOWL ASSEMBLY (NO 3)

1. Place the Food Processor on a dry, level countertop with the controls facing forward. Do not plug in the Food Processor until it is completely assembled.
2. Position the processing bowl(3) onto motor base, turn clockwise to make it fixed firmly.
3. Fit the detachable drive shaft onto the rotor inside the bowl – push down lightly to ensure the drive shaft is fully engaged.
4. Take the blade you want. For example, when using the chopper blade(8) or dough blade(7), just seat it in detachable driving shaft(4).

**NOTE: WHEN USING FINE SLICING/SHREDDING, COARSE SLICING/SHREDDING OR FINGER CHIPS, THEN SEAT THE BLADE DISC(9, 10, 11) IN DETACHABLE DRIVING SHAFT/SPINDLE(4). ATTENTION; ONLY ONE BLADE CAN BE USED EVERY TIME.**

5. Put the food into the processing bowl(3) and then close the top lid(5) while using the chopper blade(8) or kneading blade(7). When using slicing, shredding or grating disc, make sure to lock the top lid(5) first, ingredients should be filled through feed chute after the machine is ready.

6. Lock the top lid(5), the safety lock is active now.

**NOTE: THE SWITCH SHOULD BE IN 0 SPEED; CONNECT THE PLUG WITH SOCKET, USING PULSE FUNCTION TO CONFIRM WHETHER THE MACHINE IS ASSEMBLED WELL. IF THERE IS ANYTHING ABNORMAL, UNPLUG THE MACHINE AND RE-ASSEMBLE IT AS ABOVE.**

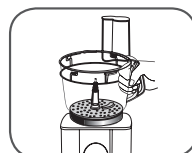
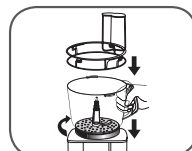
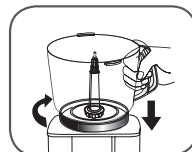
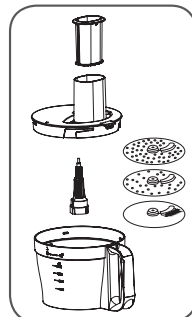

## SECTION 4 OPERATING YOUR USHA FOOD PROCESSOR

### Before First use:

Before using your Food Processor for the first time, wash all parts and accessories either by hand or in the dishwasher (see "Cleaning the Food Processor" section).

**NOTE: THIS APPLIANCE IS EQUIPPED WITH A PROTECTIVE DEVICE AGAINST HIGH TEMPERATURE. IF THE TEMPERATURE BECOMES TOO HIGH, THE UNIT WILL TURN OFF AUTOMATICALLY AND RESUME OPERATION AFTER THE MOTOR HAS COOLED DOWN SUFFICIENTLY (AFTER ABOUT 30 MINUTES).**

### ATTA KNEADING BLADE ASSEMBLY AND APPLICATION (NO 7)

- Place the Spindle inside the processing bowl.
- Select the Kneading Blade and put it into the centre of the bowl and on the spindle. Latch the lid and the bowl onto the processor, enabling the machine to operate.

### Suggested quantity for kneading dough application

#### Indicative volume per one batch :

Ingredient	Volume
Flour & soft cheese	≤400g

### Tips and warning:

The ratio of flour to water while doughing is 1:0.6, means 100g flour needs 60g water to make best effect; The standard of processing time is within 30sec, that's because the flour will become sticky and stick to the blade adapter if the time lasts too long. Then it will make the machine shake, and work abnormally.

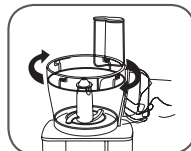
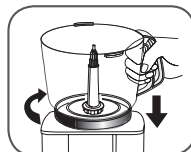



## CHOPPER ASSEMBLY AND APPLICATION (NO 8)

- Place the Spindle inside the processing bowl.
- Select the Chopping Blade and put it into the food processor. Latch the lid and the bowl onto the processor, enabling the machine to operate.
- Standard processing time may vary from 20sec to 30sec

### Suggested quantity for chopping blade application

#### Indicative volume per one batch :

Ingredient	Volume
Chocolate	≤200g
Cheese	≤350g
Meat	≤800g
Vegetable & Spice	100~150g
Fruit	300~500g
Onion	≤800g

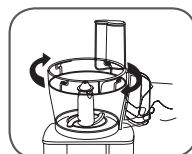
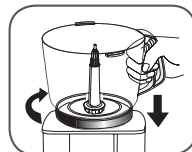

## FINE SLICING/SHREDDING AND COARSE SLICING/SHREDDING DISC ASSEMBLY AND APPLICATION (NO 9-10)

Choose the blade disc according to ingredients and the shape you want. Put the blade disc, then seat it in the Spindle(4), close the processing top lid(6), making sure the safety switch is switched on.



FINE BLADE



COARSE BLADE

### Notes (Slicing and Shredding Disc):

- Once the processing is done, carefully take out all the attachments, and detach the bowl by turning anti clockwise.

**NOTE : PLEASE INSERT THE INGREDIENTS SMOOTHLY INSIDE THE FEEDING TUBE. IT'S BETTER TO CHOP LARGE SHAPE INGREDIENTS INTO SMALLER ONE TO FIT THE FEED CHUTE SIZE. LOWER SPEED IS RECOMMENDED WHILE SLICING SOFT INGREDIENTS TO PREVENT IT FROM BECOMING PASTY.**

Standard processing time is 1 minute.

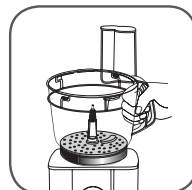
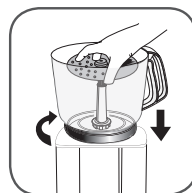

### FINGER CHIPS DISC ASSEMBLY AND APPLICATION (NO 11)

1. Place the spindle on motor base.
2. Select the Finger chips slicing disc and seat it in the spindle.
3. Close the processing top lid, making sure the safety switch is switched on.

### Notes (Finger Chips Disc):

- Once the processing is done, carefully take out all the attachments, and detach the bowl by turning anti clockwise.

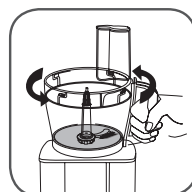

## CITRUS JUICER ASSEMBLY AND APPLICATION (NO 18)

1. Position spindle on motor base.
2. Position processing bowl into the spindle and turn clockwise to seat firmly on motor base.
3. Place citrus juicing plate on the bowl and turn 30 degrees clockwise.

### Notes (Citrus Juicer):

1. Lower speed should be chosen for citrus juicer
2. Once the processing is done, carefully take out all the attachments, and detach the bowl by turning anti clockwise.

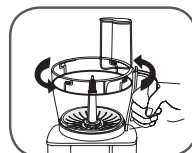
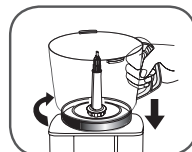

## WHISKER DISC ASSEMBLY AND APPLICATION (NO 15)

1. Position spindle on motor base.
2. Position processing bowl into the spindle and turn clockwise to seat firmly on motor base.
3. Turn the Emulsifying/Whisker disc to the right position.
4. Cover the lid, turn clockwise until cover locks on bowl.
5. Place pusher into feeding chute.

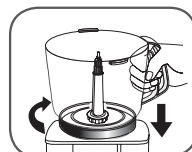
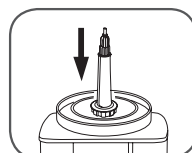

### Notes (Whisker Disc):

1. Once the processing is done, carefully take out all the attachments, and detach the bowl by turning anti clockwise.

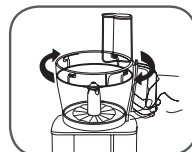
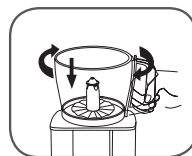

### CENTRIFUGAL JUICE EXTRACTOR ASSEMBLY AND APPLICATION (NO 20-23)

Set the juicer attachment as the pictures above show.

1. Position the motor base on a dry and flat board.
2. Turn the juicer base clockwise, make the juicer fix in the motor base firmly.
3. Set the juice beaker , juice mesh, juicer .
4. Buckle up the safety lock, the juice attachment is ready. The appliance only works when it has been set up correctly.
5. Please check that switch should be in "0" speed, plug in and use pulse 1-2 times as pre-blending. For abnormal situation, pull off the plug, re-install the machine following the steps above.
6. You can choose the suitable speed according to the hardness of the fruit, choose low speed for soft fruit and vegetable (like watermelon or cucumber), choose high speed for hard fruit and vegetable (like apple and carrot), the performance would be better. Set up the machine and choose the right speed, put the beaker under the juice spout, put the prepared fruit and vegetable into the feeding mouth and use the pusher to push down gently.

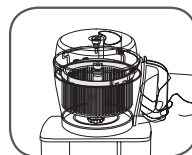
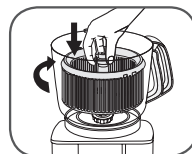
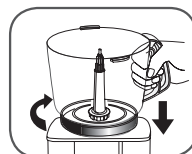
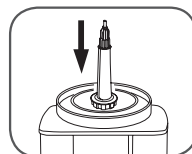

7. After juicing turn the switch to "0" speed, turn off the power, wait until the juice mesh stops working, turn to the opposite direction and take the machine apart for cleaning.

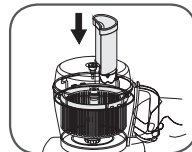
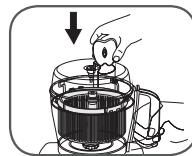

#### NOTE:

- A. Do not put your finger or other object into the feeding mouth while the machine is operating.
- B. For better performance, do not push too hard.
- C. Turn off the machine first if you want to clean the juicer.
- D. Do not use the machine constantly for more than 1 minute.
- E. Clean the juicer in time, otherwise it may cause blockage or the motor will stop working.
- F. After using, clean the juice mesh carefully (you can use professional brush to clean). Otherwise it may affect next time usage.

#### About choosing fruit and vegetable

- A. Use fresh fruit and vegetable because they are juicy, such as apple, carrot, pineapple, orange, watermelon, cucumber, celery, etc.
- B. Fruit and vegetable which are too soft or contain too much starch are not suitable for juicing, such as banana, papaya, figs, mango, etc.
- C. Most of the fruits and vegetables can be put into the juicer directly, no need to peel or remove the seed, except those with thick skin such as orange or pineapple. The seeds of orange should be removed too, because they will cause bitter taste to the juice.
- D. This machine is quite suitable for making apple juice, but the performance depends on the types of apple, so choose carefully when buying them. Fresh apple juice can easily turn brown, you can add a few drops of lemon juice to make it better.
- E. Drink the juice as soon as possible, the taste and nutrition could be affected after exposed to the air for some time.

## BLENDER JAR ASSEMBLY AND APPLICATION (NO 13-14)

1. Place the spindle on motor base.
2. Position the blender jar into the spindle and turn clockwise to seat firmly on the motor base.
3. Put the ingredients in the blender jar and place the lid on the jar along with the lid cap.
4. The switch should be in "0" speed, plug in and use pulse 2-3 times as pre-blending. Then choose "1" or "2" speed for processing.
5. During the operation, you can take out the small lid on blender jar cover and add water or any other ingredients you want through the feeding hole.

### Notes (Blender Jar)

DO NOT open the blender jar cover(14) for adding ingredients during operation! Always add in some water when using the blender for ice crushing.

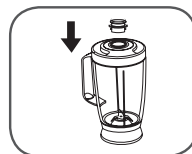
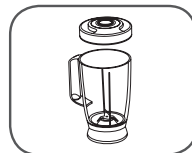
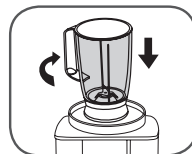

## MULTIPURPOSE JAR ASSEMBLY AND APPLICATION (NO 16)

1. Place the spindle on motor base.
2. Put the ingredients in the multipurpose jar and place the lid on the jar.
3. Put the SS jar onto motor base vertically, and then rotate the jar clockwise to fix it.

### Notes (Multipurpose jar)

1. Take ingredients and put them into the jar, working capacity on suggestion: less than 2/3 of the full capacity.
2. Use Pulse 2 or 3 times at first, then choose the related speed to start the unit with running time 1 minute then rotate back to speed OFF in 3 minutes.



3. Disconnect the plug then clean and dry the blender jar after using.
4. Once the processing is done, carefully take out all the attachments, and detach the jar by turning anti clockwise.
5. Remove the jar cover. Pour the ingredients into cup.

Food and ingredients recommend: rice, coffee beans, soya bean, peanut, herb.

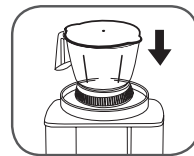

### CHUTNEY JAR ASSEMBLY AND APPLICATION (NO 17)

1. Place the spindle on motor base.
2. Put the ingredients in the chutney jar and place the lid on the jar, working capacity on suggestion: less then 120g
3. Use Pulse 2 or 3 times at first, then choose the related speed to start the unit with running time 1 minute then rotate back to speed OFF in 3 minutes.
4. Disconnect the plug then clean and dry the chutney jar after using.
5. Once the processing is done, carefully take out all the attachments, and detach the jar by turning anti clockwise.
6. Remove the jar cover. Pour the ingredients into cup.

Food and ingredients suggested: Ginger, chili, garlic, Coconut.



### Tips during Usage

- To avoid damage to the blade or motor, do not process food that is so hard or firmly frozen that it cannot be pierced with the tip of a sharp knife. If a piece of hard food, such as a carrot, becomes wedged or stuck on the blade, stop the processor and remove the blade. Gently remove food from the blade.
- To capitalize on the speed of the processor, drop ingredients to be chopped through the feed tube while the processor is running.
- Different foods require varying degrees of pressure for best shredding and slicing results. In general, use light pressure for soft, delicate foods (strawberries, tomatoes,

etc.), moderate pressure for medium foods (zucchini, potatoes, etc.), and firmer pressure for harder foods (carrots, apples, hard cheeses, partially frozen meats, etc.).

- Sometimes slender foods, such as carrots or celery, fall over in the feed tube, resulting in an uneven slice. To minimize this, cut food in several pieces and pack the feed tube with the food.
- When preparing a cake or cookie batter or quick bread, use the multipurpose blade to cream fat and sugar first. Add dry ingredients last. Place nuts and fruit on top of flour mixture to prevent overchopping. Process nuts and fruits, using short pulses, until blended with other ingredients. Do not overprocess.
- When shredded or sliced food piles up on one side of the bowl, stop the processor and redistribute the food using a spatula.
- A few larger pieces of food may remain on top of the disc after slicing or shredding. If desired, cut these by hand and add to mixture
- Use a spatula or other kitchen utensil to remove ingredients from the processing bowl.
- Organize processing tasks to minimize bowl cleanup. Process dry or firm ingredients before liquid ingredients.
- To clean ingredients from the multipurpose blade easily, just empty the work bowl, replace the lid, and pulse 1 to 2 seconds to spin the blade clean.
- After removing the work bowl cover, place it upside down on the counter. This will help keep the counter clean.

## **TECHNICAL SPECIFICATION**

Model: FP 3810

Voltage: 230V~50/60 Hz

Rated power: 1000W

Motor Type : Universal

Speed Control Switch : Rotary Type , 2 speed + pulse

Blender jar capacity: 1.5L

Processing bowl working capacity: 2.4L

\*Due to continuous effort for product upgradation, specifications are subject to change without prior notice.



## SECTION 5 **CLEANING AND MAINTENANCE**

1. Please unplug the power cord to protect from electric shock while cleaning the machine, do not immerse motor base and power cord in water.
2. All removable accessories can be cleaned in water except motor base, dry the wet parts after cleaning.
3. For easy cleaning, you can put in some warm water and detergent and let it run for a while when cleaning blender jar.
4. Always place the machine in dry and cool place.
5. DO NOT use hard(solid) detergent to avoid scratch on product.
6. DO NOT operate the appliance for more than 1 minute at a stretch.
7. ONE minute ON and THREE minutes OFF, max. 5 circles, then turn off the machine and let it cool down to room temperature.

## **TROUBLE SHOOTING**

<b>Problem</b>	<b>Solution</b>
Machine doesn't work.	Make sure that the bowl and lid are properly aligned and locked in place.
	Make sure power plug is plugged in properly.
	Check if the mains have tripped, or if there is a power outage.
Machine stops running suddenly.	Processing bowl may loosen during vigorous processing. Please re-install the bowl cover.
Motor is running, while components do not run.	Make sure the driving shaft is installed correctly.
Food Processor not shredding or slicing properly:	Make sure the raised-blade side of the disc is positioned face up on the common adapter.
	If using the adjustable slicing blade, make sure it is set to the correct thickness.
	Make sure ingredients are suitable for slicing or shredding. See "Tips for Great Results" section.

## WARRANTY CARD

This appliance is warranted for 2 years on product against all manufacturing defects from the date of sale.

In the event of any complaint, please contact at Usha Care Toll Free No. 1800 1033 111.

### THE WARRANTY IS VALID ONLY WHEN:

1. The appliance has been installed, used and maintained in accordance with the instruction manual.
2. The warranty card and cash memo duly signed by the authorized dealer are presented with the complaint.
3. The appliance has not been opened or tampered with, by any unauthorized person.

### THIS WARRANTY DOES NOT APPLY FOR:

1. Damages due to chipping, peeling, plating and denting.
2. Breakage or damage to components made out of Bakelite, Urea, ABS, SAN and such plastic materials, rubber parts and cord.
3. Normal wear and tear of parts.
4. Damage resulting from accidents, mishandling or negligence on part of the customer.

Liability for consequential loss or damage is neither accepted nor implied.

S.NO:

CASH MEMO:

DATE:

DEALER'S NAME AND ADDRESS:

<hr/> <hr/> <hr/>
-------------------

OWNER'S NAME & ADDRESS:

<hr/> <hr/> <hr/>
-------------------

## NOTES

[illegible]

To explore our range of  
product and recipe log  
on to [www.usha.com](http://www.usha.com)  
[www.ushacook.com](http://www.ushacook.com)

**USHA**  
COOK

**USHA care**<sup>TM</sup>

Toll free

**1800-1033-111**

[usha\\_care@ushainternational.com](mailto:usha_care@ushainternational.com)

---

## USHA INTERNATIONAL LTD.

---

Plot No. 15, Institutional Area, Sector 32, Gurugram - 122 001, Haryana Tel : +91-124-4583100,  
Fax : +91-124-4583200, E-mail : [corporate@ushainternational.com](mailto:corporate@ushainternational.com)  
Regd. Office : Surya Kiran Building, 19 K. G. Marg, Delhi-110 001 CIN-U74210DL1935PLC007123  
Tel : +91 11 23318114 Fax : +91 11 23318118

---



® Registered Trademark and Copyright of USHA INTERNATIONAL LTD.



® Registered Trademark of USHA INTERNATIONAL LTD.