

AAVANTE BAR 1650D



RAISE THE BAR



**2.1CH Dolby
sound bar**



 **Dolby** Audio

USER MANUAL



AAVANTE BAR 1650D **2.1CH Dolby sound bar**

A compact yet powerful Bluetooth sound-bar with sleek looks and excellent audio response.

4 inbuilt speakers with 1 wired subwoofer provide clarity across a broad frequency range, with crisp highs and deep bass. An integral USB port enables playback of MP3/WAV files directly from compatible media, with further flexible input options including Aux, optical, Coaxial, HDMI(ARC) and Bluetooth.

A convenient and cost-effective TV audio upgrade that doesn't compromise on performance.

PACKAGE CONTAINS:

- 1N Aavante Bar 1650D
- 1N User Manual
- 1N Aux in Cable
- 1N Warranty Card
- 1N Remote
- 1N Screws for wall mount
- 1N Power Cable
- 1N Catalogue



- Slender and stylish design
- 4 inbuilt speakers for crisp, clear sound with deep bass
- Inbuilt 2.1 channel amplifier with 3 EQ presets
- Versatile input options to support a range of devices
- USB port for MP3 and WAV media playback
- Keyhole slots for wall mounting
- Remote control and Aux cable included

SAFETY PRECAUTIONS

1. Don't put this product under high temperature wet environment and it will be worse when it is in the rain or crash strongly.
2. To reduce the risk of electronic shock or fire, do not remove the cabinet cover simply contact a service professional.
3. In the rear occurrence of malfunction, do not attempt to repair the unit on your own. Contact a certified service professional for a proper diagnosis and repair.
4. If fragments or liquids fall into device box, please cut off the power right away. And it can be used only after professional staff checks it.
5. Don't install the unit in or near a place where it may come in contact with rain, moisture or other liquids.

TECHNICAL SPECIFICATIONS AND FEATURES

Output Power RMS	120W
Speaker drivers	4 x 2.25" 15W units + 1 x 6.5" 60W subwoofer units
Frequency	45Hz-20KHz
SNR	>=80dB
Bluetooth version	5.0+EDR
Bluetooth range	Up to 10m
Connections	HDMI(ARC) ,Optical, Coaxial ,AUX in,USB 2.0
Power supply	Soundbar: AC In 110-240V,50/60Hz Subwoofer: AC In 110-240V,50Hz/60Hz
Dimensions	Soundbar 940x75x80mm Subwoofer 305x145x425mm





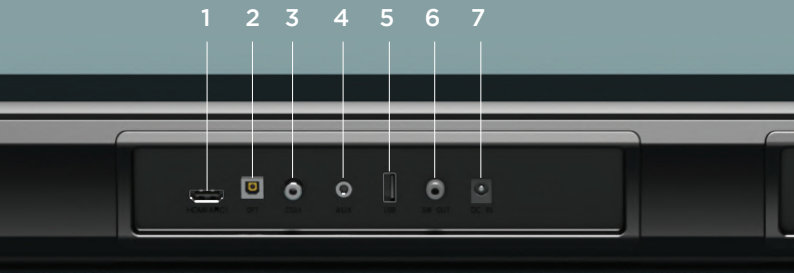

CONNECTIONS



- 1.HDMI(ARC): Use to connect compatible devices using a HDMI cable (not provided).
2. OPTICAL IN: Use to connect compatible devices using an optical cable (not provided).
- 3.COAXIAL IN: Use to connect compatible devices using a coaxial cable (not provided).
4. AUX IN: Use to connect compatible devices using the 3.5mm – 3.5mm stereo jack cable (provided).
5. USB IN: Use to connect a flash drive for direct MP3/WAV playback (FAT32 format and 32GB max).
- 6.SW OUT: Use to connect subwoofer.
- 7.AC IN: Use to connect the AC power supply.

REMOTE CONTROL

Button	Function
	Power on/off
	Mute or recover the volume
Treble+	Increase the Treble
Treble-	Decrease the Treble
Bass+	Increase the Bass
Bass-	Decrease the Bass
+	Volume turning up
-	Volume turning down
	Previous track
	Pause/Play
	Next track
Mode	Shifting between BT/USB/ AUX/OPT/COAX/HDMI(ARC)
BT	Shifting into BT Mode
USB	Shifting into USB Mode
AUX	Shifting into AUX Mode
COAX	Shifting into Coaxial in Mode
HDMI	Shifting into HDMI(ARC) Mode
EQ	Shifting to different EQ
3D	3D Surround on/off
	USB Repeat modes

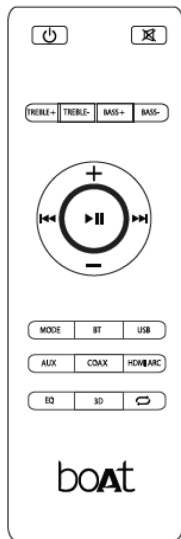

LED DISPLAY

1. Red LED: Standby mode
2. bt: Bluetooth mode
3. USB: USB media mode
4. AUX: Auxiliary input mode
5. OPT:Optical mode
6. COA:Coaxial mode
7. ARC:HDMI(ARC)mode

INPUT FUNCTIONS

- **Power on/off:** Press the Power on/off button on the remote control or soundbar control panel to turn the unit on and off.
- **HDMI(ARC):** Connect an HDMI ARC compatible device to the HDMI(ARC) port on the soundbar using a HDMI cable (not supplied). Select HDMI(ARC) mode either by pressing the HDMI(ARC) button on your remote control or repeatedly pressing the MODE button on the soundbar control panel until ARC is displayed on the LED display. Ensure HDMI ARC is selected as the TV's audio output, then adjust the volume of soundbar using the Volume up and Volume down buttons on the remote control or soundbar control panel.
- **AUX in:** Connect a compatible device using the 3.5mm – 3.5mm stereo jack cable. Select AUX mode either by pressing the AUX button on your remote control or repeatedly pressing the MODE button on the soundbar control panel until AUX is displayed on the LED display. Ensure the connected device is producing an audio signal, then adjust the volume of soundbar using the Volume up and Volume down buttons on the remote control or soundbar control panel.

- **Optical in:** Connect a compatible device to the OPTICAL input on the soundbar using a digital optical cable (not supplied). Select OPT mode either by pressing the MODE button on your remote control or soundbar control panel repeatedly until OPT is displayed on the LED display. Ensure Optical SPDIF is selected as the TV's audio output, then adjust the volume of the soundbar using the Volume up and Volume down buttons on the remote control or soundbar control panel.

- **Coaxial in:** Connect a compatible device to the COAXIAL input on the soundbar using a digital coaxial cable (not supplied). Select COAX mode either by pressing the COAX button on your remote control or repeatedly pressing the MODE button on the soundbar control panel until COA is displayed on the LED display. Ensure Coaxial is selected as the TV's audio output, then adjust the volume of the soundbar using the Volume up and Volume down buttons on the remote control or soundbar control panel.

- **Bluetooth:** Press the BT button on the remote control or repeatedly pressing the MODE button on the soundbar control panel until bt is shown on the LED display. The LED display will flash to indicate that the soundbar is in Bluetooth pairing mode. Ensure that the device you wish to connect is also in pairing mode and search for Aavante Bar 1650D in its device list. When the two devices are paired, the LED display on the soundbar will stop flashing and remain constant. (The soundbar will now automatically re-pair with this device whenever it is within range and has Bluetooth turned on.)

- **USB media mode:** The soundbar is compatible with USB flash drives of up to 32GB in size and can play MP3 and WAV audio files directly. Simply insert a compatible drive into the USB port on the back of the soundbar and the unit will automatically switch to USB mode and play the first compatible track. USB repeat mode (also accessed via the remote control) enables single track repeat (ONE), all track repeat (ALL) The media player also has a memory function that will recall and continue from the last-played point when a USB flash drive that has previously been used with the soundbar is reinserted.

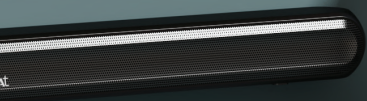
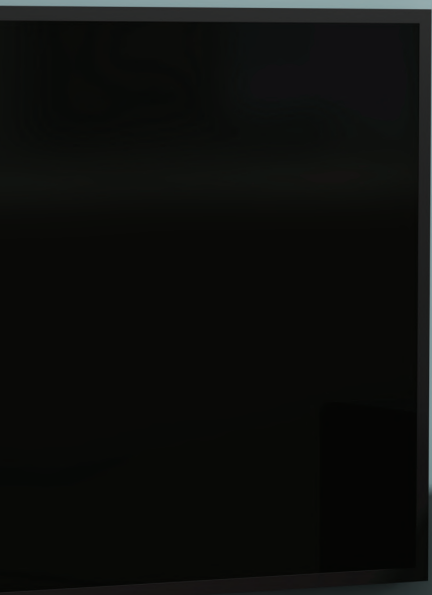

Note:

Adjust the TV to PCM audio output format, when your TV is playing non-Dolby video; otherwise, adjust it back to original audio format, when playing Dolby Digital video.

- **Equalizer modes:** The soundbar has 3 equalizer presets, tailored to complement various styles of music. Press the EQ button on the remote to choose between Music (EQ1), Movie (EQ2), News (EQ3).
- **Wall mounting:** The soundbar has two keyhole slots on the back to enable wall mounting, using the fixings provided or a compatible soundbar bracket (not supplied)

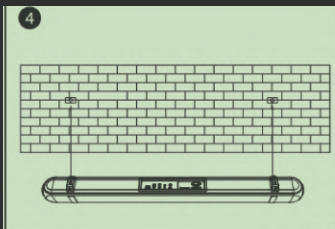
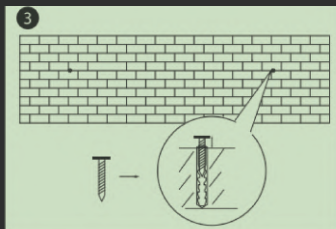
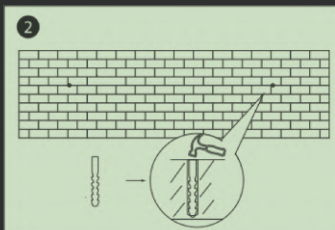
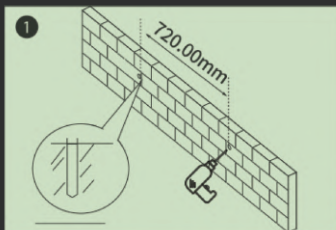

AAVANTE BAR 1650D

RAISE THE BAR



 Dolby Audio