

PHILIPS

Soundbar

7000 Series

TAB7807

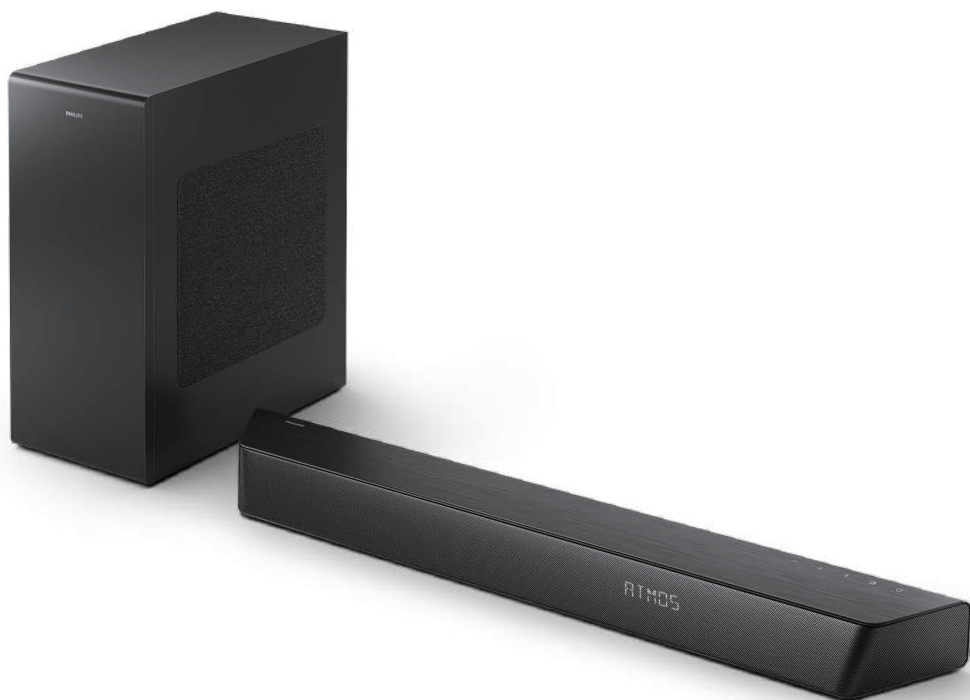

User manual

Register your product and get support at
www.philips.com/support

Contents

1	Important safety instructions	3	5	Product specifications	20
	Safety	3			
	Care for your product	4			
	Care of the environment	4			
	Declaration of conformity	5			
	Help and support	5			
	FCC information	6			
2	Your Soundbar	7	6	Troubleshooting	21
	What's in the box	7		Trademarks:	22
	Soundbar	7			
	Connectors	8			
	Wireless subwoofer	8			
	Remote control	9			
	Prepare the remote control	9			
	Placement	10			
	Wall mount	11			
3	Connect	12			
	Dolby Atmos®	12			
	Connect to HDMI socket	12			
	Connect to Optical socket	13			
	Connect to Audio in socket	13			
	Connect to power	14			
	Pair up with the subwoofer	14			
4	Use your soundbar	15			
	Turn on and off	15			
	Select modes	15			
	Adjust the volume	15			
	Dolby sound mode	16			
	Setup menu	16			
	Factory reset	17			
	Play from Bluetooth devices	18			
	Listen to an external device	19			
	Play audio through USB	19			

1 Important safety instructions

Read and understand all instructions before you use your product. If damage is caused by failure to follow instructions, the warranty does not apply.

Safety

Know these safety symbols



This is **CLASS II** apparatus with **double insulation**, and **no protective earth** provided.



AC voltage



Follow the instructions in the user manual!



WARNING!
Warning: Risk of electric shock!



The exclamation mark is intended to alert the user to the presence of important operating instructions.

Risk of electric shock or fire!

- Before you make or change any connections, make sure that all devices are disconnected from the power outlet.
- Never expose the product and accessories to rain or water. Never place liquid containers, such as vases, near the product. If liquids are spilt on

or into the product, disconnect it from the power outlet immediately. Contact Consumer Care to have the product checked before use.

- Never place the product and accessories near naked flames or other heat sources, including direct sunlight.
- Never insert objects into the ventilation slots or other openings on the product.
- Where the mains plug or an appliance coupler is used as the disconnect device, the disconnect device shall remain readily operable.
- Battery (battery pack or batteries installed) shall not be exposed to excessive heat such as sunshine, fire or the like.
- Disconnect the product from the power outlet before lightning storms.
- When you disconnect the power cord, always pull the plug, never the cable.
- Use the product in tropical and/or moderate climates.

Risk of short circuit or fire!

- For identification and supply ratings, see the type plate at the back or bottom of the product.
- Before you connect the product to the power outlet, ensure that the power voltage matches the value printed on the back or bottom of the product. Never connect the product to the power outlet if the voltage is different.

Risk of injury or damage to this product!

- For wall mounting, this product must be securely attached to the wall in accordance with the installation instructions. Use only the supplied wall mount bracket (if available). Improper wall mounting may result in accident, injury or damage. If you have any query, contact Consumer Care in your country.

- Never place the product or any objects on power cords or on other electrical equipment.
- If the product is transported in temperatures below 5°C, unpack the product and wait until its temperature matches room temperature before connecting it to the power outlet.
- Parts of this product can be made of glass. Handle with care to avoid injury and damage.

Risk of overheating!

- Never install this product in a confined space. Always leave a space of at least four inches around the product for ventilation. Ensure curtains or other objects never cover the ventilation slots on the product.

Risk of contamination!

- Do not mix batteries (old and new or carbon and alkaline, etc.).
- CAUTION: Danger of explosion if batteries are incorrectly replaced. Replace only with the same or equivalent type.
- Remove batteries if they are exhausted or if the remote control is not to be used for a long time.
- Batteries contain chemical substances, they should be disposed of properly.



Note

- The rating label is pasted on the bottom or back of the equipment.

Care for your product

Use only microfiber cloth to clean the product.

Care of the environment

Disposal of your old product and battery



Your product is designed and manufactured with high quality materials and components, which can be recycled and reused.



This symbol on a product means that the product is covered by European Directive 2012/19/EU.



This symbol means that the product contains batteries covered by European Directive 2013/56/EU which cannot be disposed of with normal household waste.

Inform yourself about the local separate collection system for electrical and electronic products and batteries. Follow local rules and never dispose of the product and batteries with normal household waste. Correct disposal of old products and batteries helps prevent negative consequences for the environment and human health.

Removing the disposable batteries

To remove the disposable batteries, see battery installation section.

Declaration of conformity

This product complies with the radio interference requirements of the European community.

Hereby, MMD Hong Kong Holding Limited declares that the product is in compliance with the essential requirements and other relevant provisions of RED Directive 2014/53/EU and UK Radio Equipment Regulations SI 2017 No 1206. You can find the Declaration of Conformity on www.philips.com/support.

Help and support

For extensive online support, visit www.philips.com/support to:

- download the user manual and the quick start guide
- watch video tutorials (available only for selected models)
- find answers to frequently answered questions (FAQs)
- email us a question
- chat with our support representative.

Follow the instructions on the website to select your language, and then enter your product model number.

Alternatively, you can contact Consumer Care in your country. Before you contact, note down the model number and serial number of your product. You can find this information on the back or bottom of your product.

FCC information

NOTE: This equipment has been tested and found to comply with the limits for a Class B digital device, pursuant to Part 15 of the FCC Rules. These limits are designed to provide reasonable protection against harmful interference in a residential installation. This equipment generates, uses and can radiate radio frequency energy and, if not installed and used in accordance with the instructions, may cause harmful interference to radio communications. However, there is no guarantee that interference will not occur in a particular installation. If this equipment does cause harmful interference to radio or television reception, which can be determined by turning the equipment off and on, the user is encouraged to try to correct the interference by one or more of the following measures:

- Reorient or relocate the receiving antenna.
- Increase the separation between the equipment and receiver.
- Connect the equipment into an outlet on a circuit different from that to which the receiver is connected.
- Consult the dealer or an experienced radio / TV technician for help.

FCC&IC Warning:

- This equipment should be installed and operated with minimum distance 20cm between the radiator & your body.
- Changes or modifications to this unit not expressly approved by the party responsible for compliance could void the user's authority to operate the equipment.

FCC & IC Attention

- Cet appareil est conforme à FCC et IC l'exposition aux rayonnements limites fixées pour un environnement non contrôlé. Cet appareil doit être installé et utilisé avec une distance minimale de 20 cm entre le radiateur

et votre corps. Cet transmetteur ne doit pas être co-situé ou opérant en liaison avec toute autre antenne ou transmetteur.

- Des câbles blindés doivent être utilisés avec cet appareil pour assurer la conformité avec les limites de la classe B de la FCC. fonctionnement de l'appareil.

IC-Canada: CAN ICES-003(B)/NMB-003(B)

This device contains licence-exempt transmitter(s) / receiver(s) that comply with Innovation, Science and Economic Development Canada's licence-exempt RSS(s). Operation is subject to the following two conditions:

- 1 This device may not cause interference.
- 2 This device must accept any interference, including interference that may cause undesired operation of the device.

Avis d'Industrie Canada: CAN ICES-003(B)/NMB-003(B)

L'émetteur/récepteur exempt de licence contenu dans le présent appareil est conforme aux CNR d'Innovation, Sciences et Développement économique Canada applicables aux appareils radio exempts de licence. L'exploitation est autorisée aux deux conditions suivantes :

- 1 L'appareil ne doit pas produire de brouillage;
- 2 L'appareil doit accepter tout brouillage radioélectrique subi, même si le brouillage est susceptible d'en compromettre le fonctionnement.

2 Your Soundbar

Congratulations on your purchase, and welcome to Philips! To fully benefit from the support that Philips offers, register your soundbar at www.philips.com/support.

What's in the box

Check and identify the items in the package:

- Soundbar x 1
- Remote control x 1
(AAA batteries x 2)
- Wireless subwoofer x 1
- Power cord (Bar and subwoofer)* x 2
- Wall mount kit x 1
(Brackets x2 / Bracket screws x2 / Wall mounting screws x2 / Wall anchors x2)
- Quick start guide / Warranty card / Safety sheet x 1

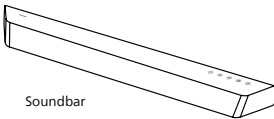

Soundbar

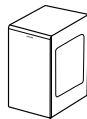

Wireless subwoofer

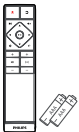

Remote control
(AAA batteries x 2)



EU & UK only
Power cord *

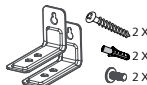

Wall mount kit
(brackets x2 / bracket screws x2 / wall mounting screws x2 / wall anchors x2)

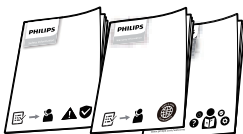

Quick start guide
Warranty card / Safety sheet

- Power cord quantity and plug type vary by regions.
- Images, illustrations and drawings shown on this User Manual are for reference only, actual product may vary in appearance.

Soundbar

This section includes an overview of the soundbar.

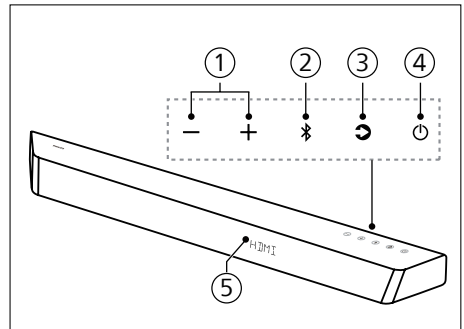

- ① **+ / - (Volume) button**
Increase/decrease the volume.
- ② **Bluetooth button**
 - Press to select the Bluetooth mode.
 - Press and hold to disconnect all devices and enter the Bluetooth pairing mode.
- ③ **Source button**
 - Press to select an input source for soundbar.
- ④ **Standby-On button**
 - Switch the soundbar On or to standby.
 - Long press for 20 seconds in power on state to enable or disable Auto-Standby (15 minutes Auto-Standby).
- ⑤ **Remote control sensor / Display panel**

Connectors

This section includes an overview of the connectors available on your soundbar.

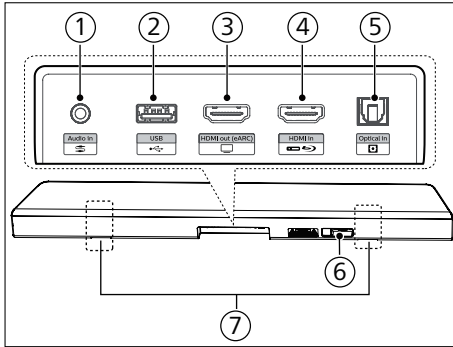

- ① **Audio in**
Audio input from, for example, an MP3 player (3.5mm jack).
- ② **USB**
 - Connect to a USB storage device for audio media play.
 - Upgrade software of this product.
- ③ **HDMI out (eARC) socket**
The port supports the eARC/ARC HDMI feature, connect to the HDMI (eARC/ARC) input on the TV.
- ④ **HDMI in socket**
Connect to the HDMI source devices, such as a DVD player, Blu-ray Disc™ player, or gaming console.
- ⑤ **Optical in socket**
Connect to an optical audio output on the TV or a digital device.
- ⑥ **AC in ~ socket**
Connect to the power supply.
- ⑦ **Wall bracket slot**

Wireless subwoofer

This section includes an overview of the wireless subwoofer.

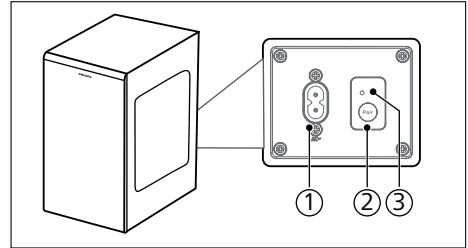

- ① **AC~ socket**
Connect to the power supply.
- ② **Pair button**
Press and hold to enter the pairing mode for the subwoofer.
- ③ **Subwoofer indicator**
Determine the status based on the wireless subwoofer indicator.

LED State	Status
Fast blink	Subwoofer in pairing mode
Constant on	Connected / Pairing successful
Slow blink	Pairing failed

Remote control

This section includes an overview of the remote control.

- ① **⏻ (Standby-On) button**
 - Switch the soundbar On or to standby.
 - Long press for 20 seconds in power on state to enable or disable APD (15 minutes Auto-Standby)
- ② **📶 (Source)**
 - Press to select an input source for soundbar.
 - Press and hold to disconnect all devices and enter the Bluetooth pairing mode.
- ③ **🎧 (Dolby Atmos)**
Virtual Surround decoder on/off.
- ④ **🔇 (Mute)**
Mute or restore volume.
- ⑤ **Navigation buttons**
 - ◀ / ▶ (Left/Right)
 - Skip to the previous or next track in USB/BT mode.
 - Navigate Left/Right in menu structure.
 - ▲ / ▼ (Up/Down)
 - Navigate up/down in menu structure.
 - ▶ || (Center)
 - Start, pause or resume play in USB/ BT mode.
- ⑥ **⚙️ (MENU)**
Enter setup menu.
- ⑦ **← (Back)**
 - Return to the previous menu.
 - Exit menu.
- ⑧ **🔊 +/- (System's volume)**
Increase / decrease the system's volume.

- ⑨ **🔊 +/- (Subwoofer's Volume)**
Increase / decrease the subwoofer's volume.

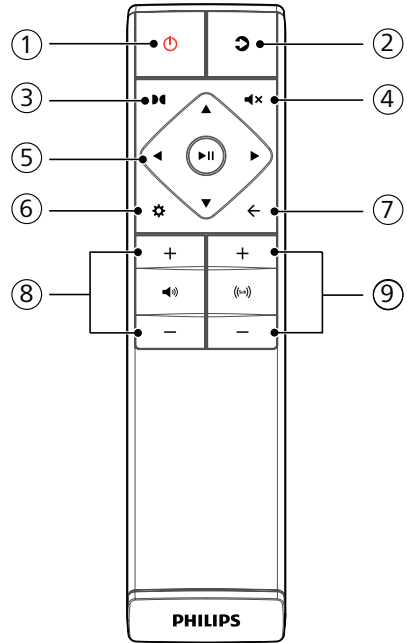

Prepare the remote control

- The provided remote control allows the unit to be operated from a distance.
- Even if the remote control is operated within the effective range 19.7 feet (6m), remote control operation may be impossible if there are any obstacles between the unit and the remote control.
- If the remote control is operated near other products which generate infrared rays, or if other remote control devices using infra-red rays are used near the unit, it may operate incorrectly. Conversely, the other products may operate incorrectly.

Replace the remote control battery

Slide to remove the battery compartment cover, insert 2 AAA batteries (1.5V) with correct polarity, then slide the battery compartment cover back into position.

- Make sure the (+) and (-) ends of the batteries match the (+) and (-) ends indicated in the battery compartment.

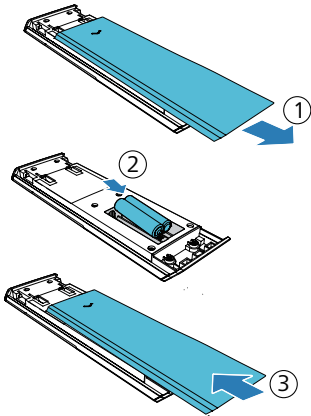

Precautions concerning batteries

- Be sure to insert the batteries with correct positive “⊕” and negative “⊖” polarities.
- Use batteries of the same type. Never use different types of batteries together.
- Either rechargeable or non-rechargeable batteries can be used. Refer to the precautions on their labels.
- Be aware of your fingernails when removing the battery cover and the battery.
- Do not drop the remote control.
- Do not allow anything to impact the remote control.
- Do not spill water or any liquid on the remote control.

- Do not place the remote control on a wet object.
- Do not place the remote control under direct sunlight or near sources of excessive heat.
- Remove the battery from the remote control when not in use for a long period of time, as corrosion or battery leakage may occur and result in physical injury, and/or property damage, and/or fire.
- Do not use any batteries other than those specified.
- Do not mix new batteries with old ones.
- Never recharge a battery unless it is confirmed to be a rechargeable type.

Placement

Place the subwoofer at least 1 meter (3 feet) away from your soundbar, and 10 centimeters away from the wall.

For best results, place your subwoofer as shown below.

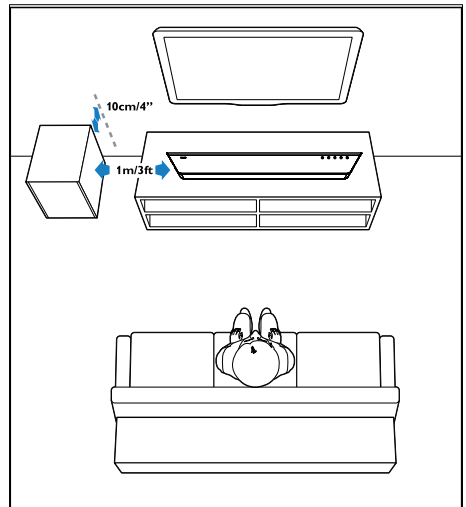

Wall mount

Note

- Improper wall mounting may result in accident, injury or damage. If you have any query, contact Consumer Care in your country.
- Before wall mounting, make sure the wall can support the weight of your soundbar.
- Before wall mounting, you need not remove the rubber feet at the bottom of the soundbar, otherwise the rubber feet cannot be fixed back.
- Depending on the type of wall mounting, make sure that you use screws of a suitable length and diameter.
- Please check whether the USB port on the back of the soundbar is connected to a USB device. If it is found that the connected USB device affects the wall-mount, you need to use another USB device of the appropriate size.

Screw length/diameter

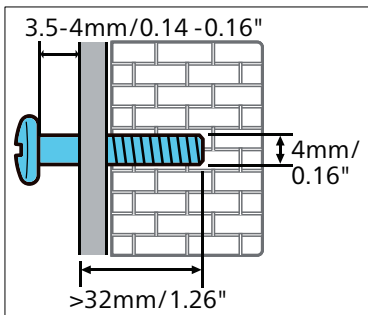

Suggested wall mounting height

You are recommended to install the TV first before wall mounting the soundbar. With a TV preinstalled, wall mount the soundbar 50mm/2.0" in distance from the bottom of the TV.

WARNING!

- To prevent injury, this apparatus must be securely attached to the floor/wall in accordance with the installation instructions.
- Suggested wall mounting height: ≤ 1.5 meters.

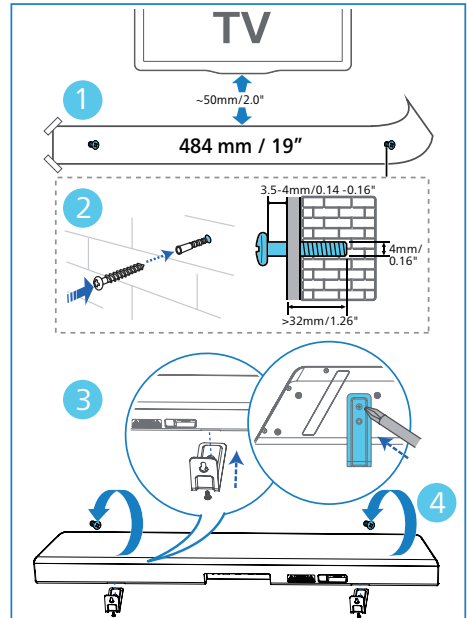

- 1 Drill 2 parallel holes (diameter 3-8mm each according to wall type) on the wall.
 - ↳ The distance between the holes are: **484 mm / 19"**
 - ↳ You can use the wall mount template provided for helping the drilling holes position on the wall.
- 2 Secure the dowels and screws in the holes.
 - ↳ Be sure to leave a **3.5-4mm** gap between the wall and the screw's head.
- 3 Attach the wall brackets (x2) into the back of the soundbar.
- 4 Hang the soundbar on the fastening screws.

3 Connect

This section helps you connect your soundbar to a TV and other devices, and then set it up.

Note

- For identification and supply ratings, see the type plate at the back or bottom of the product.
- Before you make or change any connections, make sure that all devices are disconnected from the power outlet.

Dolby Atmos®

Dolby Atmos gives you immersive listening experience by delivering sound in three dimensional space, and all the richness, clarity, and power of Dolby sound.

For more information, please visit dolby.com/technologies/dolby-atmos

For use Dolby Atmos®

Dolby Atmos® is available in HDMI mode. For the details of the connection, please refer to “HDMI Connection”.

- 1 To use Dolby Atmos® in HDMI in/ HDMI eARC/ARC mode, your TV has to support Dolby Atmos®.
- 2 Make sure that “No Encoding” is selected for bitstream in the digital audio output of the connected external device (e.g. Blu-ray DVD player, TV etc.).
- 3 While entering Dolby Atmos / Dolby Digital / PCM format, the soundbar will show DOLBY ATMOS / DOLBY AUDIO / PCM / DOLBY SURROUND.

Note

- The full Dolby Atmos experience is only available when the soundbar is connected to the source via a HDMI 2.0 cable.
- The soundbar will still function when connected via other methods (such as a Digital Optical cable) but they are unable to support all of the Dolby features. Given this, our recommendation is to connect via HDMI, in order to ensure full Dolby support.

Connect to HDMI socket

Some 4K HDR TVs require the HDMI input or picture settings to be set for HDR content reception. For further setup details on HDR display, please refer to the instruction manual of your TV.

Option 1:

HDMI eARC (Enhance Audio Return Channel)

Your soundbar supports HDMI with eARC/ARC (Enhance Audio Return Channel). If your TV is HDMI eARC/ARC compliant, you can hear the TV audio through your soundbar by using a single HDMI cable.

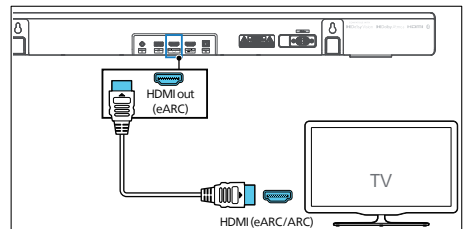

- 1 On your TV, turn on HDMI-CEC operations. For details, see the TV user manual.
 - The **HDMI ARC** connector on the TV might be labeled differently. For details, see the TV user manual.

- Using a High Speed HDMI cable, connect the **HDMI out (eARC/ARC)** connector on your soundbar to the **HDMI ARC** connector on the TV.

Note

- Your TV must support the HDMI-CEC and ARC function. HDMI-CEC and ARC must be set to On.
- The setting method of HDMI-CEC and ARC may differ depending on the TV. For details about ARC function, please refer to your TV user manual.
- Make sure to use the HDMI cables can support the ARC function.

Option 2: Standard HDMI

If your TV is not HDMI ARC-compliant, connect your soundbar to the TV through a standard HDMI connection.

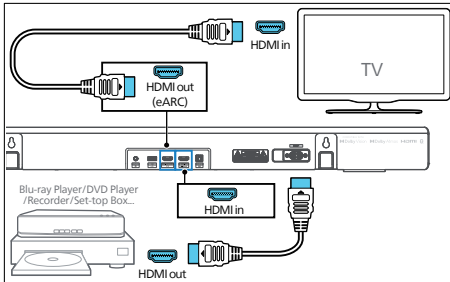

- Use an HDMI cable to connect the soundbar's **HDMI in** socket to your external devices (e.g. games consoles, DVD players and Blu-ray).
- Use an HDMI cable to connect the soundbar's **HDMI out (eARC)** socket to the TV's **HDMI in** socket.

Connect to Optical socket

- Using an optical cable, connect the **Optical** connector on your soundbar to the **Optical out** connector on the TV or other device.

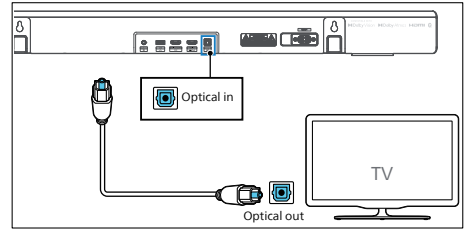

- The digital optical connector might be labeled **Spdif** or **Spdif out**.

Connect to Audio in socket

a. Use 3.5mm audio cable

- Use a 3.5mm to 3.5mm audio cable to connect the TV's headphone socket to the **Audio in** socket on the soundbar.

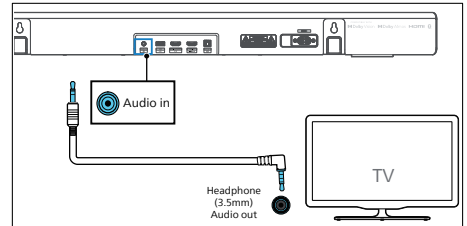

a. Use 3.5mm-RCA audio cable

- Use a RCA to 3.5mm audio cable to connect the TV's audio output sockets to the **Audio in** socket on the soundbar.

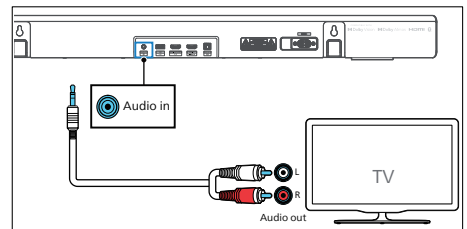

Connect to power

- Before connecting the AC power cord, ensure you have completed all other connections.
 - Risk of product damage! Ensure that the power supply voltage corresponds to the voltage printed on the back or the underside of the unit.
- 1 Connect the mains cable to the **AC~** socket of the soundbar and then into a mains socket.
 - 2 Connect the mains cable to the **AC~** socket of the subwoofer and then into a mains socket.

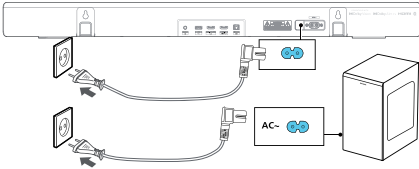

* Power cord quantity and plug type vary by regions.

Pair up with the subwoofer

Automatic pairing

Plug the soundbar and the subwoofer into the mains sockets and then press **⏻** on the unit or remote control to switch the unit to **ON** mode. The subwoofer and soundbar will automatically pair.

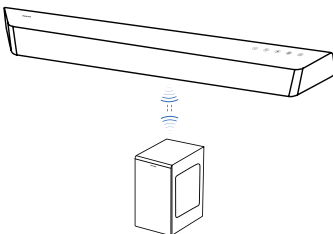

↳ Determine the status based on the wireless subwoofer indicator.

LED State	Status
Fast blink	Subwoofer in pairing mode
Constant on	Connected / Pairing successful
Slow blink	Pairing failed

Tips

- Do not press **Pair** button on the rear of the subwoofer, except for manual pairing.

Manual pairing

If no audio from the wireless subwoofer can be heard, manually pair up the subwoofer.

- 1 Unplug both the subwoofer from the mains sockets again, then plug them in again after 3 minutes.
- 2 Press and hold the **Pair** button on the rear of the subwoofer for 3 seconds.
↳ The indicator on the subwoofer will rapidly blink.
- 3 Then press **⏻** on the soundbar or remote control to switch the soundbar ON.
↳ The indicator on the subwoofer will become solid when successful.
- 4 If the indicator still keeps blinking, repeat step 1-3.

Tips

- The subwoofer should be within 6 m of the soundbar in an open area (the closer the better).
- Remove any objects between the subwoofer and the soundbar.
- If the wireless connection fails again, check if there is a conflict or strong interference (e. g. interference from an electronic device) around the location. Remove these conflicts or strong interferences and repeat the above procedures.

4 Use your soundbar

This section helps you use the soundbar to play audio from connected devices.

Before you start

- Make the necessary connections described in the quick start guide and the user manual.
- Switch the soundbar to the correct source for other devices.

Turn on and off

- When you first connect the soundbar to the main socket, the unit will be in standby mode.
- Press the ψ button on the soundbar or on the remote control to switch the soundbar on or to standby.
- Disconnect the mains plug from the mains socket if you want to switch the soundbar off completely.

Select modes

Press the \odot button repeatedly on the soundbar or on the remote control to select the **USB**, **Audio in**, **Optical**, **HDMI eARC/ARC**, **HDMI in**, **BT (Bluetooth)** mode.

- ↳ The selected mode will show on the display.

Display	Status
USB	USB
AUX	Audio in
BT NO BT	Bluetooth <ul style="list-style-type: none">• Connected• Connection
OPT	Optical
E-ARC ARC	HDMI eARC HDMI ARC
HDMI	HDMI IN

Adjust the volume

Adjust the system's volume

Press the $+/-$ buttons on the soundbar or press $\llbracket \text{V} \rrbracket$ $+/-$ (Volume) buttons on the remote control to increase or decrease the system's volume level.

- To mute sound, press $\llbracket \text{M} \rrbracket$ (Mute) button on the remote control.
- To restore the sound, press $\llbracket \text{M} \rrbracket$ (Mute) again or press $+/-$ (Volume).

Adjust the subwoofer's volume

Press $\llbracket \text{SW} \rrbracket$ $+/-$ (subwoofer volume) buttons on the remote control to increase or decrease the subwoofer's volume level.

Dolby sound mode

Experience an immersive audio experience with Dolby sound modes.



- 1 Press  button on the remote control to turn Dolby mode on or off.
 - **On:** Create a Dolby listening experience. (**Upmix:** Take full advantage of all speakers).
 - **Off:** Use default channel listening. (**Standard:** Speakers output follow the default channel.)





Note

- For non-HDMI connections (such as use of USB, Bluetooth, OPTICAL or AUDIO IN), only limited height surround effects are generated.

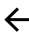
Setup menu

The unit allows you to configure advanced settings to provide you with an even better experience.

Button	Function
	Enter settings menu
	Navigate up/down in menu structure.
	Previous/next selection
	Exit setting menu

- 1 Press the  (MENU) button on the remote control to open the menu.
 - 2 Select the content with  (Down / Up) on the remote control.
 - 3 Change the initial values for each of the settings with the cursors  (Left / Right).
- To return to the previous screen/ exit the settings, press  (Back).

Display	Description
EQ	Select equalizer (EQ) effect
BAS X X	Adjust the bass level
TRB X X	Adjust the treble level
AV SYNC	Set the Audio Delay
CTR X X	Adjust the center channel volume
DISP	Display off setting
BT PAIR	Start Bluetooth pairing (Only in BT mode)
APD	Auto-standby ON/OFF
DISP X X	Set display brightness

EQ

Select predefined sound modes to suit your video and music: MOVIE, MUSIC, VOICE, STADIUM.

- **MOVIE:** Create a surround listening experience. Ideal for watching movies.
- **MUSIC:** Create 3.1-channel or multi-channel stereo sound. Ideal for listening to music.
- **VOICE:** Create sound effect which makes human voice more clear and outstanding for listening.
- **STADIUM:** Create an atmosphere as if watching a sports game in a stadium.
 - ↳ By default, the EQ is set to MOVIE.

Bass/Treble

Change the low frequency (bass) and high frequency (treble) settings of this product.

- **BAS -5 ... BAS +5**
- **TRB -5 ... TRB +5**
- ↳ By default, the Bass/Treble is set to 0.

AV SYNC

Set the Audio Delay.

Video image processing, sometimes longer than the time required to process the audio signal. This is called “delayed.” Audio Delay feature is designed to remedy this delay.

- **AV 00. AV 10 ... AV200**
 - ↳ By default, the audio delay is set to 00.

CTR (Center)

Adjust the center channel volume

- **CTR-5 ... CTR+5**
 - ↳ By default, the center channel volume is set to 0.

DISP (Display off)

The display to be turned off after idling (no user action) for **3** seconds, and shall be remembered and recalled at the next power up.

- **ON:** Display off after idling (no user action) for **3** seconds.
- **OFF:** Display won't turn off.
- ↳ By default, the display is set to ON.

BT PAIR

Enter the Bluetooth pairing mode.

- If you want to connect your soundbar with another Bluetooth device, you can activation the pairing in the menu (**BT PAIR**) to disconnect all devices and enter the Bluetooth pairing mode.
 - ↳ Press  > select “**BT PAIR**” > Then press **▶** (Enter) to confirm the Bluetooth pairing mode.
- Follow step 2-3 in “**Play from Bluetooth devices**” above to pair your Bluetooth device.

Note

- The “**BT PAIR**” menu will only be displayed when the current signal source is in “**BT**” mode

APD (Auto Standby)

The soundbar automatically turns to Standby mode after about **15** minutes if the TV or the external soundbar is disconnected (or USB, BT function bit playback pause), or switched off.

- **ON:** Auto-Standby ON.
- **OFF:** Auto-Standby OFF.
- ↳ By default, Auto-Standby is set to ON.

DIM

Set display brightness.

- **HIGH, MID, LOW**
 - ↳ By default, the dimmer is set to MID.

Factory reset

Reset device to default setting.

- Turn on the soundbar, press and hold the **+** and **-** buttons at the same time for 8 seconds.
 - ↳ Display shows “**RESET**” for 5 seconds.
 - ↳ While system reboots, display shows “**REBOOT**”.

Play from Bluetooth devices

Through Bluetooth, connect the soundbar with your Bluetooth device (such as an iPad, iPhone, iPod touch, Android phone, or laptop), and then you can listen to the audio files stored on the device through your soundbar speakers.

- 1 Press the **⌘ (Bluetooth)** button on the soundbar to switch the soundbar to Bluetooth mode.
 - ↳ **NO BT** is displayed on the display panel.
- 2 On the Bluetooth device, switch on Bluetooth, search for and select **Philips TAB7807** to start connection (see the user manual of the Bluetooth device on how to enable Bluetooth).
- 3 Wait until you hear the voice prompt from the soundbar.
 - ↳ If the successfully connected, **BT** is displayed on the display panel.
- 4 Select and play audio files or music on your Bluetooth device.
 - During play, if a call comes in, music play pauses. Play resumes when the call ends.
 - If your Bluetooth device supports AVRCP profile, on the remote control you can press **◀ / ▶** to skip to a track, or press **▶ ||** to pause/ resume play.

To disconnect and pair a new Bluetooth device

- 1 In Bluetooth mode, Press **⚙** > select **"BT PAIR"** > Then press **▶** (Enter) to disconnect all devices and enter the Bluetooth pairing mode.
 - Alternatively directly press and hold **⌘** button on the soundbar to disconnect all devices and enter the Bluetooth pairing mode.
 - ↳ The soundbar voice prompt and the display will show **"PAIRING"**.
- 2 Follow step 2-3 in **"Play from Bluetooth devices"** above to pair your Bluetooth device.

Note

- In an open space without obstructions. The maximum operational range between the soundbar and a Bluetooth device is approximately 10 meters (30 feet).
- Compatibility with all Bluetooth devices is not guaranteed.
- The music streaming may be interrupted by obstacles between the device and soundbar, such as wall, metallic casing that covers the device, or other devices nearby that operate in the same frequency.

Listen to an external device

Ensure that the soundbar is connected to the TV or audio device.

- 1 Press the  button repeatedly on the soundbar or on the remote control to select the **Audio in, Optical, HDMI eARC/ARC, HDMI in** mode.
- 2 Operate your audio device directly for playback features.
- 3 Press the **+/-** (Volume) buttons to adjust the volume to your desired level.
↳ When selecting a different audio format, the soundbar will display the following as follows:

Audio (abbreviation)	Display
LPCM 2ch	PCM
LPCM 5.1ch	PCM
LPCM 7.1ch	PCM
Dolby Digital	Dolby AUDIO
Dolby TrueHD	Dolby AUDIO
Dolby Digital Plus	Dolby AUDIO
Dolby Atmos - Dolby TrueHD	Dolby Atmos
Dolby Atmos - Dolby Digital Plus	Dolby Atmos

Note

- The soundbar may not be able to decode all digital audio formats from the input source. In this case, the system will mute. This is NOT a defect. Ensure that the audio setting of the input source (e.g. TV, game console, DVD player, etc.) is set to **PCM** or **Dolby Digital** (Refer to the user manual of the input source device for its audio setting details) with HDMI in / HDMI ARC / Optical input.

Play audio through USB

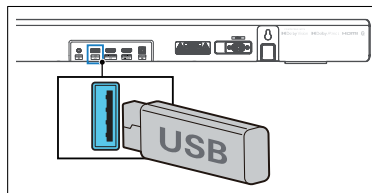

Enjoy audio on a USB storage device, such as an MP3 player and USB flash memory, etc.

- 1 Insert the USB device.



- 2 Press the  button repeatedly on the soundbar or on the remote control to select the **USB** mode.
↳ **USB** is displayed on the display panel.
- 3 During playback:

Button Action

	Start, pause or resume play.
	Skip to the previous or next track.

Note

- This product may not be compatible with certain types of USB storage devices.
- If you use a USB extension cable, USB hub, or USB multifunctional card reader, the USB storage device may not be recognized.
- Do not remove the USB storage device while reading files.
- The system can support USB devices with up to 128 GB of memory.
- This system can play MP3 / WAV / FLAC.
- Support a USB port: 5V --- 500mA.

5 Product specifications

Note

- Specifications and design are subject to change without notice.

Bluetooth / Wireless

Bluetooth profiles	A2DP, AVRCP
Bluetooth version	V 5.1
Bluetooth frequency range / Transmitter power (EIRP)	2402 ~ 2480MHz < 10dBm
2.4G wireless frequency range / Transmitter power (EIRP)	2402 ~ 2480MHz < 10dBm

Amplifier Section

Total	RMS 310W @THD<=10%; Max. 620W
-------	----------------------------------

Soundbar

Power supply	100-240V~ 50/60Hz
Power consumption	40 W
Standby consumption	< 0.5 W
Frequency response	140Hz - 20kHz
Speakers impedance	8Ω x 6
Dimension (WxHxD)	800 x 65 x 106 mm
Weight	2.5 kg
Operating temperature	0°C - 45°C

Subwoofer

Power supply	100-240V~ 50/60 Hz
Power consumption	45 W
Standby consumption	< 0.5 W
Frequency response	35 Hz - 140 Hz
Impedance	3 Ω
Dimensions (W x H x D)	190 x 410 x 309 mm
Weight	6.0 kg
Operating temperature	0°C - 45°C

USB

USB direct version	2.0 Full Speed
USB	5V --- 500mA

Remote control

Distance/Angle	6m/30°
Battery type	AAA (1.5V X 2)

Supported audio formats

HDMI in	LPCM 2ch, LPCM 5.1ch, LPCM 7.1ch, Dolby Digital, Dolby Digital plus, Dolby True HD, Dolby MAT, Dolby Atmos - Dolby Digital Plus, Dolby Atmos - TrueHD, Dolby Atmos - Dolby MAT.
HDMI eARC	LPCM 2ch, LPCM 5.1ch, LPCM 7.1ch, Dolby Digital, Dolby Digital plus, Dolby True HD, Dolby MAT, Dolby Atmos - Dolby Digital Plus, Dolby Atmos - TrueHD, Dolby Atmos - Dolby MAT.
HDMI ARC	LPCM 2ch, LPCM 5.1ch, Dolby Digital, Dolby Digital plus, Dolby Atmos - Dolby Digital Plus
Optical	LPCM 2ch, LPCM 5.1ch, Dolby Digital
Bluetooth	SBC
USB	MP3 / WAV / FLAC

6 Troubleshooting



Warning

- Risk of electric shock. Never remove the casing of the product.

To keep the warranty valid, never try to repair the product yourself.

If you have problems using this product, check the following points before you request service. If you still have a problem, get support at www.philips.com/support.

Main unit

The buttons on the main unit do not work.

- Disconnect from the power supply for a few minutes, then connect again.

No power

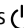
- Ensure that the AC cord is properly connected.
- Ensure that there is power at the AC outlet.
- Press  button on the remote control or soundbar to turn the soundbar on.

Sound

No sound from the soundbar speaker.

- Connect the audio cable from your soundbar to your TV or other devices. However, you do not need a separate audio connection when:
 - the soundbar and TV are connected through HDMI ARC connection, or
 - a device is connected to the HDMI in connector on your soundbar.
- On the remote control, select the correct audio input.
- Make sure that the soundbar is not muted.
- Reset this product to its factory settings (see 'Factory reset').

Distorted sound or echo.

- If you play audio from TV through this product, make sure that the TV is muted.

Audio and video are not synchronized.

- Press  enter setting menu, select 'AV SYNC' to synchronize the audio with the video.

No sound from the wireless subwoofer.

- Manually connect the subwoofer to the main unit.
- Increase the volume. Press + (Volume Up) on the remote control or on the soundbar.
- When using either of the digital input, if there is no audio:
 - Try setting the TV output to PCM or
 - Connect directly to your Blu-ray/ other sources.
 - Some TVs do not pass through digital audio.
- Your TV may be set to variable audio output. Confirm that the audio output setting is set to FIXED or STANDARD, not VARIABLE. Refer to your TV's user manual for more detailed information.
- If using Bluetooth, ensure that the volume on your source device is turned up and that the device is not muted.
- When the playback freezes and there is no sound in Wi-Fi mode, please check whether your home network is normal.

Bluetooth

A device cannot connect with the soundbar.

- The device does not support the compatible profiles required for the soundbar.
- You have not enabled the Bluetooth function of the device. See the user manual of the device on how to enable the function.

- The device is not correctly connected. Connect the device correctly.
- The soundbar is already connected with another Bluetooth device. Disconnect the connected device, and then try again.

Quality of audio play from a connected Bluetooth device is poor.

- The Bluetooth reception is poor. Move the device closer to the soundbar, or remove any obstacle between the device and the soundbar.

I can't find the Bluetooth name of this unit on my Bluetooth device.

- Ensure the Bluetooth function is activated on your Bluetooth device.
- Re-pair the unit with your Bluetooth device.

Dolby Atmos

Cannot achieve outstanding Dolby Atmos effects.

- For non-HDMI connections (such as use of USB, Bluetooth, Optical or AUDIO IN), limited height surround effects are generated. See the section of 'Dolby Atmos' about how to achieve best Dolby Atmos effects.

Remote control does not work

- Before you press any playback control button, first select the correct source.
- Reduce the distance between the remote control and the unit.
- Insert the battery with its polarities (+/-) aligned as indicated.
- Replace the battery.
- Aim the remote control directly at the sensor on the front of the unit.

The subwoofer is idle or the indicator of subwoofer does not light up

- Unplug power cord from the mains socket, and plug it in again after 3 minutes to reset the subwoofer.

Trademarks:



The terms HDMI, HDMI High-Definition Multimedia Interface, and the HDMI Logo are trademarks or registered trademarks of HDMI Licensing Administrator, Inc.

COMPATIBLE WITH



Dolby, Dolby Vision, Dolby Atmos, and the double-D symbol are registered trademarks of Dolby Laboratories Licensing Corporation. Manufactured under license from Dolby Laboratories. Confidential unpublished works. Copyright © 2012–2021 Dolby Laboratories. All rights reserved.



The Bluetooth® word mark and logos are registered trademarks owned by Bluetooth SIG, Inc. and any use of such marks by MMD Hong Kong Holding Limited is under license. Other trademarks and trade names are those of their respective owners.



Roku, the Roku logo, Roku TV, Roku TV Ready, and the Roku TV Ready logo are trademarks and/or registered trademarks of Roku, Inc. This product is Roku TV Ready-supported in the United States, Canada, United Kingdom, Mexico and Brazil. Countries are subject to change. For the most current list of countries in which this product is Roku TV Ready-supported, please email rokutvready@roku.com.



Specifications are subject to change without notice. Please visit www.Philips.com/support for the latest updates and documents.

Philips and the Philips Shield Emblem are registered trademarks of Koninklijke Philips N.V. and are used under license.

This product has been manufactured by and is sold under the responsibility of MMD Hong Kong Holding Limited, or one of its affiliates, and MMD Hong Kong Holding Limited, is the warrantor in relation to this product.

