



**We love that you are rocking JLab!
We take pride in our products and fully stand behind them.**

JLAB®
JBUDS AIR
|
EARBUDS



YOUR WARRANTY

All warranty claims are subject to JLab authorization and at our sole discretion. Retain your proof of purchase to ensure warranty coverage.



CONTACT US

Reach out to us at support@jlab.com or visit jlab.com/contact

REGISTER TODAY

jlab.com/register

[Product updates](#) | [How-to tips](#)
[FAQs & more](#)

FIRST TIME SETUP

1 AUTO-CONNECTING EARBUDS

Press and hold **both touch sensors 3+ seconds** to power ON. One earbud **turns solid white** and the other earbud **blinks blue/white** indicating ready to pair to your device.

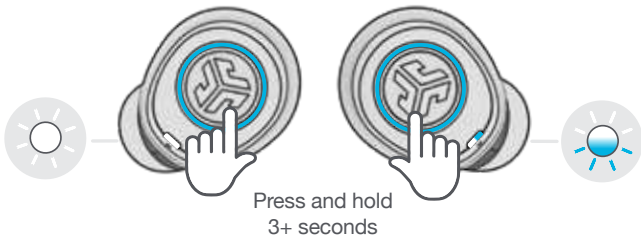

2 CONNECTING TO BLUETOOTH

Select “JLab JBuds Air” in your device settings. Voice prompt “Bluetooth connected” followed by **solid white lights** will indicate you are connected.



ADDING NEW / ADDITIONAL BLUETOOTH DEVICES:

Turn OFF Bluetooth from any previously connected device. **Turn ON Bluetooth** from new device. Take earbuds out of the case. Earbuds will automatically enter Bluetooth Pairing. Select “JLab JBuds Air” in new device settings to connect.



BUTTON FUNCTIONS

LEFT
EARBUD

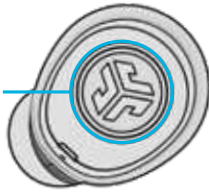

RIGHT
EARBUD

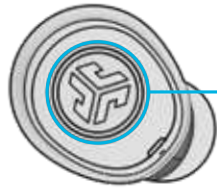

VOLUME DOWN: Single tap
SIRI (iOS) or "OK GOOGLE" (ANDROID): Double tap

ANSWER: Single tap

HANGUP: Double tap

REJECT INCOMING CALLS:
Press & hold 1+ sec

TRACK BACK: Press & hold 1+ sec

TURN ON: Press & hold 3+ sec

CHANGE EQ: Triple tap
(JBuds Air will cycle 3 EQ settings)

VOLUME UP: Single tap

ANSWER: Single tap

HANGUP: Double tap

REJECT INCOMING CALLS:

Press & hold 1+ sec

PLAY / PAUSE: Double tap

TRACK FORWARD: Press & hold 1+ sec

TURN ON: Press & hold 3+ sec

CHANGE EQ: Triple tap
(JBuds Air will cycle 3 EQ settings)

VOICE PROMPTS

"Ready to Pair": JBuds Air are ready to pair to Bluetooth device

"Bluetooth Connected":
Earbud is connected to device

"Battery Full": 100-75%

"Battery Medium": 75-20%

"Low Battery": Less than 25%
When power decreases to 10%,
"Low Battery" will play

TURN OFF EARBUDS WITHOUT CHARGING CASE:

Enter your Bluetooth device settings and disconnect the JBuds Air. Earbuds will power OFF after 3 minutes.

CUSTOM EQ³ SOUND MODES

Tap either the right or left earbud 3 times for different EQ settings (JBuds Air will cycle 3 EQ settings).



JLab SIGNATURE
JLab C3™ signature
sound with amplified
bass and vocals



BALANCED
Even sound with
no additional
enhancements



BASS BOOST
Amplified bass
and sub-bass

CHARGING EARBUDS

1

Match the corresponding L and R letters on the charging case for proper charging. The earbuds will auto power OFF and start charging.

Blue lights will indicate earbuds are charging and will turn OFF when fully charged.

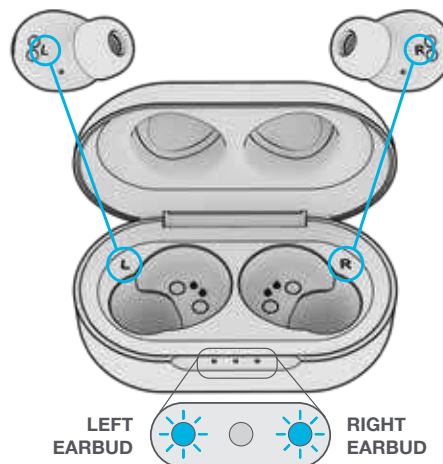

2

Earbuds will auto power ON and reconnect to your device when taken out of the case.

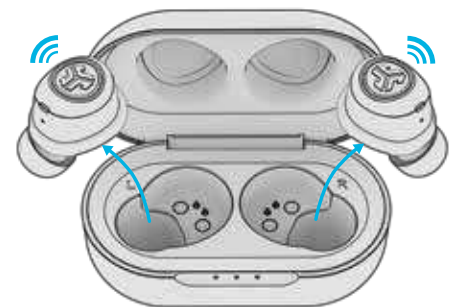

CHARGING CASE

Connect the JBuds Air to computer or USB 5V 1A (or less) output device.

LEDs **pulse white** when charging and **turn solid white** when fully charged.

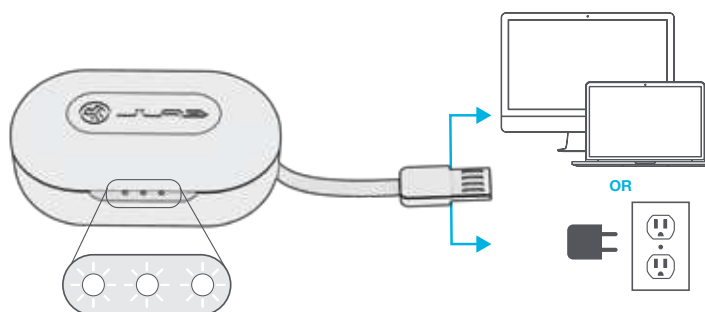

FITTING

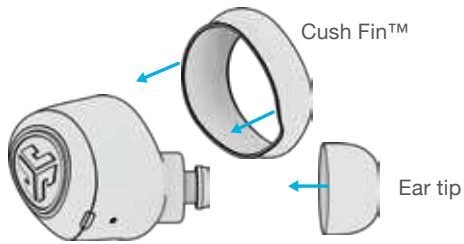

Try all the optional Cush Fins and ear tips for best fit and proper seal.

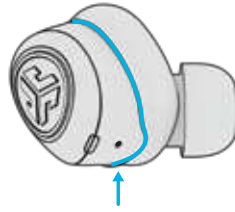

The Cush Fin should be aligned by positioning the contour around the microphone hole.

TROUBLESHOOTING

NO AUDIO IN ONE EARBUD (MANUAL RESET)

- 1 Enter your Bluetooth device settings and forget the JBuds Air.

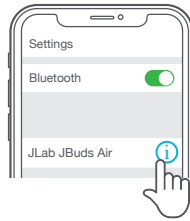

- 2 Open the charging case door and leave both earbuds inside. Starting with ONE earbud, **quickly press the button 7x times**. Light will **blink blue 4x times**. Leave the earbuds in the charging case.



- 3 Repeat with the other earbud. **Quickly press the button 7x times**. Light will **blink blue 4x times**.



- 4 Take both earbuds out of the charging case. Wait for one of the earbuds to turn **solid white** and one to **blink blue/white**. You are now ready to pair to your Bluetooth device.

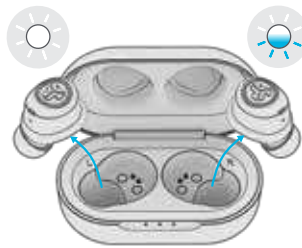

TROUBLESHOOTING

BLUETOOTH DEVICE DOES NOT CONNECT / RECONNECT

- 1 Enter your Bluetooth device settings and forget the JBuds Air.

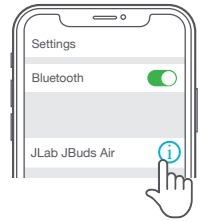

- 2 On your device, turn OFF then ON Bluetooth.

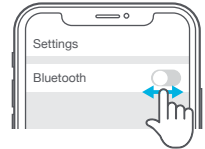

- 3 Open the charging case and wait for one earbud to turn **solid white** and one to **blink blue/white**.

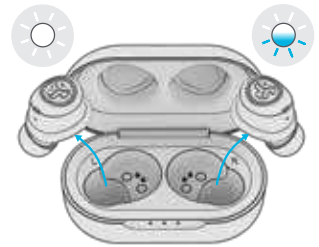

- 4 Select "JLab JBuds Air" in device settings to reconnect.

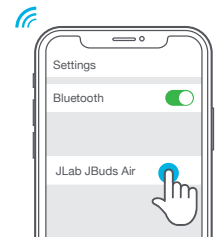

Instructional videos at: [JLAB.COM/MANUALS](https://www.jlab.com/manuals)

ECHOES ON CALLS

If you experience microphone echo/call quality with the JBuds Air, make sure the Cush Fin is not blocking the microphone port.

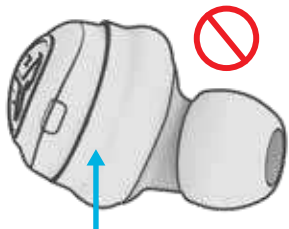

Microphone covered

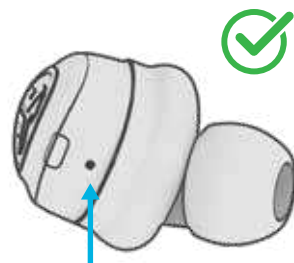

Microphone open

QUICK TIPS

- Fully dry off the earbuds before putting in the charging case to avoid any damage to the case. The earbuds are sweat/water resistant but the case is not.
- Either earbud can connect to your device and be used independently. Simply take out the earbud from charging case and it will auto connect.
- Choosing the correct ear tip makes a significant improvement in audio quality due to proper seal for the driver. Try all ear tips for best results.

WARNING

Fully dry off the earbuds before putting in the charging case to avoid any damage to the case.

The earbuds are sweat/water resistant but the case is not.



CAUTIONS

- Avoid extreme heat, cold, and humidity.
- Avoid dropping or crushing the earbuds.
- Wax may build up in the earbud tips, lowering the sound quality. Carefully remove the wax with a cotton swab or other small tool to improve the sound quality.
- If you experience discomfort or pain, try lowering the volume or discontinuing use temporarily.
- If you experience regular discomfort while using this product, discontinue use and consult your physician.
- We recommend you treat your earbuds as you would a nice pair of sunglasses and keep them in safe location when not in use.



[Shop products](#) | [Product alerts](#) | [Burn-in your headphones](#)

JLab Store + Burn-in Tool

