

# LG TONE Free

Bluetooth® LG Stereo Headset

**NOTE:** For the best performance and to prevent any damage to, or misuse of the headset, please read all of the information carefully prior to using the headset. Any modifications or changes to this manual due to typographical errors or inaccuracies of stated information shall only be made by LG Electronics Inc.

Rev 1.0 SG



Google Play

App Store

HBS-FN7

www.lg.com

Copyright © 2021 LG Electronics Inc. All Rights Reserved

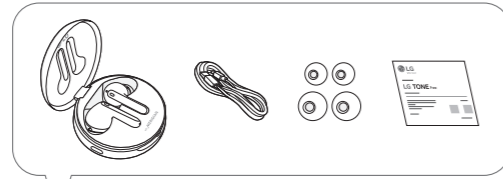

**NOTE:** Actual product design may differ from images shown in manual.  
\*A mid-sized ear gel is attached to the earbud by default.  
\*The appearance and specifications of the actual product may differ depending on the model.

**CAUTION**

Make sure authentic LG Electronics components are used. Using a non-authentic component may damage the product and thus void the warranty.  
Use the USB Type C™ cable provided with the product.

**NOTE**

The complete manual is available for download from the LG Electronics website.

[www.lg.com](http://www.lg.com) > support or service > Manuals & Downloads > Manuals

1

## 1. Overview

### [Charging Case]

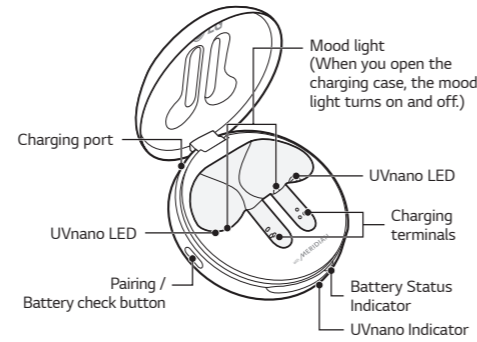

2

### [Earbuds]

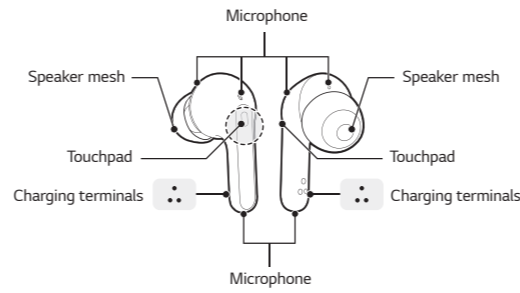

3

## 2. How to pair

- 1 Turn on the **Bluetooth** function on the mobile phone or the device to be connected.
- 2 Open the cover of the charging case with the earbuds mounted on the case. Press the pairing button for 3 to 5 seconds until the blue battery status lamp blinks.

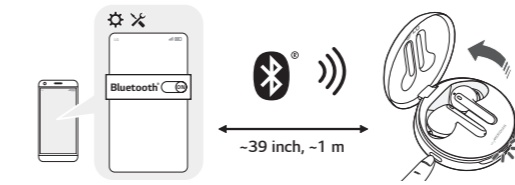

4

- 3 When the Fast Pair connection pop-up appears on the top area of the mobile phone screen, tap it to connect.

• It only supports Android™ 6.0 or higher, and requires configuring **Bluetooth** and location information settings of the mobile device.

- 4 If the pop-up does not appear, select **[LG HBS-FN7]** from the **Bluetooth** menu on the mobile phone and connect it (for users of iOS or Android 5.0 or lower versions).

**CAUTION:** In the list of **Bluetooth** connected devices, **LG HBS-FN7\_LE** is not the correct model name for connection. Check the model name in use and connect with the model name without "LE".

• **NOTE:** To connect with another device, perform the above procedure again.

5

## 3. Wearing Earbuds

- 1 Separate the earbuds from the charging case and adjust them so that they fit comfortably in your ears.  
• **NOTE:** You can easily separate the earbuds from the charging case by turning the part with dotted line in the image below to left or right and lifting the earbuds.

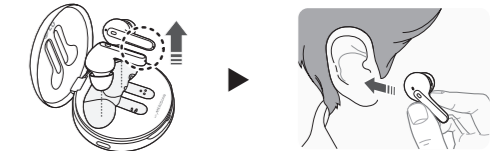

- 2 When you wear the earbuds, you will hear a wearing detection alarm.



6

## 4. Playing Music

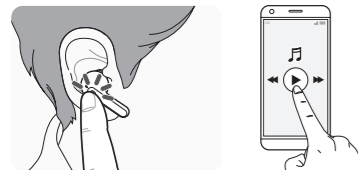

Function	Description
Play / Pause	: <b>Touch the left or right earbud once.</b>
Adjusting the Volume	: <b>Touch the left (Decrease volume) or right (Increase volume) earbud twice.</b>
Play Next	: <b>Touch the left or right earbud three times.</b>

• **NOTE:** You can change the operation method of the function in the touchpad settings of the LG TONE Free app.

7

## 5. Placing a Call

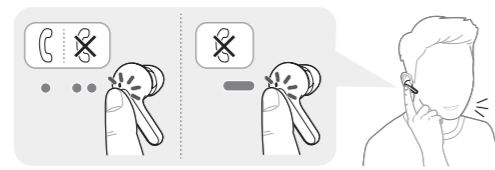

Function	Description
Answering Calls	: <b>Touch the left or right earbud once.</b>
Ending Calls	: <b>Touch the left or right earbud twice.</b>
Rejecting Calls	: <b>Touch and hold the left or right earbud.</b>

8

## 6. Listen to the Ambient Sound (LAS), Active Noise Cancellation (ANC)

### [Listen to the Ambient Sound (LAS)]

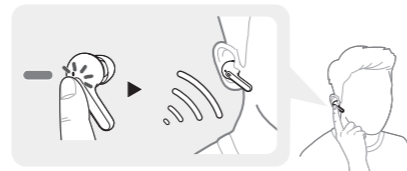

The Listen to the Ambient Sound (LAS) function allows you to listen to the ambient sound so that you can recognize the surrounding situation and any potential risks.

**Touch and hold the left or right earbud** to switch between the ANC mode and the LAS mode. You can set the LAS and ANC functions in the LG TONE Free app. If you use the LAS or ANC function, the battery consumes faster, reducing the time you can use the product. You can use the LAS and ANC functions while being idle, listening to music, or being on the phone.

• **NOTE:** ANC is an acronym for Active Noise Cancellation.

**CAUTION:** When the LAS mode is enabled, you may hear the ambient sound become loud suddenly. When using the ANC function outdoors, pay attention to the surrounding environment for safety.

9

### [Active Noise Cancellation (ANC)]

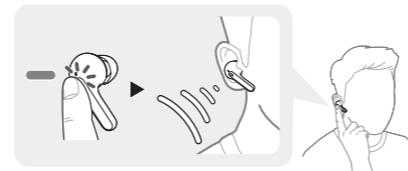

The Active Noise Cancellation (ANC) function blocks any ambient sound. So, you can use the function to listen to the music or watch a video without interference.

10

## 7. UVnano

The charging case has a built-in UVnano LED, which allows you to use your earbuds cleanly.

If you charge the earbuds wired after mounting them on the charging case and closing the cover, the UVnano LED operates for 10 minutes.



\*UVnano is a compound word derived from the words UV and its unit, nanometer.

• **NOTE:** The UVnano indicator turns on blue while the UVnano LED is on. The UVnano LED in the charging case eliminates up to 99.9% of Staphylococcus aureus and Escherichia coli inside the earbud hole. In the case of a white product, discoloring may occur in the contact area of the UVnano LED, but it does not affect the product function. The UVnano LED does not turn on while charging wirelessly.

**CAUTION:** Be aware that the temperature of the earbuds may rise while the UVnano LED is on.

11

## 8. Charging

### [Wired Charging]

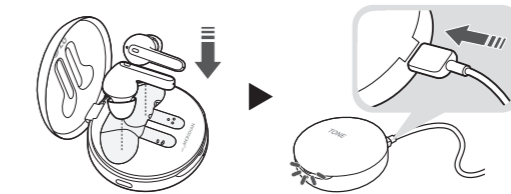

When the charging cable is connected, the charging status is displayed in the charging case.

• **NOTE:** The earbuds and the charging case are charged at the same time. The charging port on the charging case cannot be used to supply power to mobile phones, etc.

12

### [Wireless Charging]

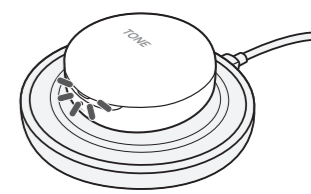

Align the bottom center of the charging case with the center of the wireless charger.

• **NOTE:** The wireless charger is not provided. The wireless charging function may not work in some wireless chargers. Wireless charging feature charges at a slower rate due to less power being transmitted to the charging case.

13

## 9. Checking the Battery Status

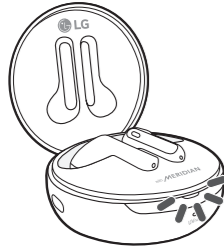

If earbuds are mounted in the charging case, the earbuds' battery status is displayed. Otherwise, the charging case's battery status is displayed. If the earbuds are mounted in the charging case while plugged in, the UVnano process will commence for ten minutes. Once this process is complete, the charging case's battery status will be displayed.

14

Your *Bluetooth* Headset is designed to operate in compliance with the RF exposure guidelines and limits set by national authorities and international health agencies when used with any compatible LG Electronics mobile phone.

### 2. Bluetooth Connection Precautions

The following environments affect the range and reception of *Bluetooth* signals:

- When walls, metal, human bodies, or other obstacles exist between the *Bluetooth* device and the connected device
- When equipment that uses 2.4 GHz frequency signals (Wireless LANs, wireless phones, microwave ovens, etc.) is placed near the devices being used
- When using a *Bluetooth* device (TV, laptop, etc.) other than the mobile phone, the sound quality may be affected by the specifications and performance of the device

21

Battery Status Indicator	Remaining Battery (charger not connected)	Charging State (charger connected)
Red	20% or lower	Charging
Yellow	20% - 80%	-
Green	80% or higher	Fully charged

• **NOTE:** When the charging case lid is closed, charging case battery status is displayed. If the charging case has no remaining charge, there will be no display and it cannot function. We recommend you keep the charging case charged at all times as the earbuds are not able to be turned on and turned off independently.

15

### 3. Potentially explosive atmosphere

Turn off your electronic device when in any area with a potentially explosive atmosphere. It is rare, but your electronic device could generate sparks. Sparks in such areas could cause an explosion or fire resulting in bodily injury or even death. Areas with a potentially explosive atmosphere are often, but not always, clearly marked.

### 4. Battery information

A rechargeable battery has a long service life if treated properly. A new battery or one that has not been used for a long period of time could have reduced capacity the first few times it is used. Do not expose the battery to extreme temperatures, never above +50° or below -10°. For maximum battery capacity, use the battery in room temperature. If the battery is used in low temperatures, the battery capacity will be reduced. The battery can only be charged in temperatures between 0° and +45°.

### 5. Recycling the battery in your Bluetooth Headset

The battery in your *Bluetooth* Headset must be disposed of properly and should never be placed in municipal waste.

22

## LG TONE Free App

If you install the "LG TONE Free" app, you can use Check Earbud Battery, Voice Alert, Change Equalizer Mode, Check Last Connected Location Information, and Find My Earbuds functions. Check out the app for more details.

To install the "LG TONE Free" app, search LG TONE Free in the Google Play Store or App Store or scan the QR code below.

It supports Android 5.0 or higher and iOS 11 or higher.



Google Play



App Store

16

## 6. Conditions

-The warranty is valid only if the original receipt issued to the original purchaser by the dealer, specifying the date of purchase and serial number, is presented with the product to be repaired or replaced. LG Electronics reserves the right to refuse warranty service if this information has been removed or changed after the original purchase of the product from the dealer.

-If LG Electronics repairs or replaces the product, the repaired or replaced product shall be warranted for the remaining time of the original warranty period or for ninety (90) days from the date of repair, whichever is longer. Repair or replacement may involve the use of functionally equivalent reconditioned units. Replaced parts or components will become the property of LG Electronics.

-This Warranty does not cover any failure of the product due to normal wear and tear, or due to misuse, including but not limited to use in other than the normal and customary manner, in accordance with instructions for use and maintenance of the product.

Nor does this warranty cover any failure of the product due to accident, modification or adjustment, acts of God or damage resulting from liquid.

23

## Safety Precautions

The following safety precautions are provided to prevent any unexpected accident or damage. Please familiarize yourself with the safety precautions.

The safety precautions are classified into "WARNING" and "CAUTION".

**WARNING:** Failing to comply with the instructions may result in serious injury or death.

**CAUTION:** Failing to comply with the instructions may result in minor injury or product damage.

### WARNING

- Do not drop the product from a high place. Make sure there is no water, alcohol, or benzene in contact with the product.
- Do not store the product in a wet or dusty place.
- Do not place heavy objects on the product.
- This product is waterproof to the IPX4 level (daily life waterproof). (The IPX4 waterproof rating applies to the earbud product only.)
- Do not put the product under the water or use it in a humid location such as a bathroom.

17

-This warranty does not cover product failures due to improper repair installations, modifications or service performed by a non-LG Electronics authorized person. Tampering with any of the seals on the product will void the warranty.

### Limited Warranty

SUBJECT TO THE CONDITIONS OF THIS LIMITED WARRANTY, LG ELECTRONICS WARRANTS THIS PRODUCT TO BE FREE FROM DEFECTS IN DESIGN, MATERIAL AND WORKMANSHIP AT THE TIME OF ITS ORIGINAL PURCHASE BY A CONSUMER, AND FOR A SUBSEQUENT PERIOD OF ONE (1) YEAR. SHOULD YOUR PRODUCT NEED WARRANTY SERVICE, PLEASE RETURN IT TO THE DEALER FROM WHOM IT WAS PURCHASED OR CONTACT YOUR LOCAL LG ELECTRONICS CONTACT CENTER TO GET FURTHER INFORMATION.

### Important Safety Information

#### Avoiding hearing damage

Permanent hearing loss may occur if you use your Headset at a high volume. Set the volume to a safe level. You can adapt over time to a higher volume of sound that may sound normal but can be damaging to your hearing.

24

## CAUTION

- Do not disassemble, adjust, or repair the product arbitrarily. Do not place the product near excessive heat or flammable material. The product may be damaged if an incompatible charger is used. Make sure that an infant or child does not swallow a magnet or a small component of the product.
- Make sure that foreign objects do not enter the charger's connectors (charging port and power plug). Failure to do so may result in fire or electric shock.
- If you have a medical device implanted, contact your doctor before using this device.
- This product has a built-in battery, and the battery cannot be removed or replaced arbitrarily.
- For your safety, do not remove the battery incorporated in the product. If you arbitrarily replace the battery or don't replace it correctly, it may explode.
- The lithium-ion battery is a hazardous component that can cause injury. Battery replacement by an unqualified professional can cause damage to your device.
- Do not discard the battery arbitrarily. Follow the local procedure for discarding batteries.
- Disposal of a battery into fire or a hot oven, or mechanically crushing or cutting of a battery, that can result in an explosion.

18

If you experience ringing in your ears or muffled speech, stop listening and have your hearing checked. The louder the volume, the less time is required before your hearing could be affected.

Hearing experts suggest that to protect your hearing:

- Limit the amount of time you use the headset at a high volume.
- Avoid turning up the volume to block out noisy surroundings.
- Turn the volume down if you can't hear people speaking near you.



Please refer to your handset user guide for more information on how to adjust listening levels on your handset.

#### Using headsets safely

Use of Headset to listen to music while operating a vehicle is not recommended and is illegal in some areas. Be careful and attentive while driving. Stop using this device if you find it disruptive or distracting while operating any type of vehicle or performing any other activity that requires your full attention.

25

A battery subjected to extremely low air pressure that may result in an explosion or the leakage of flammable liquid or gas.

### NOTE

If the product is exposed to excessive sweat, clean the product. Keep the earbuds clean.

### Declaration of Confirmation

#### As per Administrative Regulations on Low Power Radio Waves Radiated Devices:

Without permission, no company, firm or user may change the frequency, increase the power, or alter features or functions of the original design of type-approved low power radio-frequency devices. The use of low power radio-frequency devices shall not affect aircraft security or interfere with legal communications. If found to be interfering, the device shall cease operation immediately. Use of the device can be resumed only after the device has been improved to the point that it will not cause any interference. The legal communications mentioned above refer to radio communications operated in compliance with the Telecommunications Act.

19

### Open Source Software Notice Information

To obtain the source code under GPL, LGPL, MPL, and other open source licenses, that is contained in this product, please visit <http://opensource.lge.com>.

In addition to the source code, all referred license terms, warranty disclaimers and copyright notices are available for download. LG Electronics will also provide open source code to you on CD-ROM for a charge covering the cost of performing such distribution (such as the cost of media, shipping, and handling) upon email request to [opensource@lge.com](mailto:opensource@lge.com).

This offer is valid for a period of three years after our last shipment of this product. This offer is valid to anyone in receipt of this information.

RISK GROUP 2	
	<b>CAUTION :</b> UV EMITTED FROM THIS PRODUCT. EYE OR SKIN IRRITATION MAY RESULT FROM EXPOSURE. USE APPROPRIATE SHIELDING.
	<b>WARNING :</b> WHEN OPENING THE CHARGING CASE OR WIRELESS CHARGING, THE UV FUNCTION DOES NOT WORK.

Complies With IMDA Standards DB102260

26

Low power radio-frequency devices must accept any interference from legal communications or ISM radio wave radiation-emitting devices.

*Bluetooth*® is a registered trademark of Bluetooth SIG, Inc. worldwide. Android, Google Play, the Google Play logo, and other related marks and logos are trademarks of Google LLC.



### Additional Information

#### 1. Radio frequency exposure

This *Bluetooth* LG Stereo Headset is a radio transmitter and receiver. When in operation, it communicates with a *Bluetooth* equipped mobile device by receiving and transmitting radio frequency (RF) electromagnetic fields (microwaves) in the frequency range 2402 to 2480 MHz.

20

### Specifications and Features

Item	Comments
<i>Bluetooth</i> Specifications	V 5.0 (Headset/Hands-Free/A2DP/AVRCP)
Battery	Earbud : 3.7 V / 55 mAh, Lithium-ion Charging case : 3.7 V / 390 mAh, Lithium-ion
Music Play Time Earbuds & With Charging case (ANC ON)	Up to 7 & Up to 21 hours (Up to 5 / Up to 15 hours)*
Charging Time	Earbud : within an hour / Charging case : within 2 hours Fast Charging : 5 min charge for up to 60 min playtime ※ When charging wired at room temperature
Rated Input Voltage	Earbud : DC 5 V, 110 mA Charging case : DC 5 V, 500 mA
Operating Temperature	0 °C (+32 °F) ~ +40 °C (+104 °F)
Dimensions (mm) / Weight (g)	Earbud : 16.2 mm (W) X 32.7 mm (L) X 26.8 mm (H) / 5.6 g (One earbud) Charging case : 54.5 mm (W) X 54.5 mm (L) X 27.6 mm (H) / 39 g
Frequency range	2402 MHz to 2480 MHz
Output power (Max.)	10 dBm

\*Duration of use may vary depending on the connected mobile device, features being used, settings, signal strength, operating temperature, frequency band, and other methods of use. Fast charging feature does not apply when charging case is placed on wireless charging device such as a pad. Wireless charging feature charges at a slower rate due to less power being transmitted to the charging case.

27