

## Additional information

### LED Display table

LED displays and descriptions are as belows.

LED Display	Description
HELLO	HELLO
BYE	BYE
USB	USB
SD	SD
AUX AUDIO	AUX
PORTABLE AUDIO	PORTABLE
BT	BT
87.50 FM	RADIO (Displays current radio frequency)
READ	READ
PAUSE	PAUSE
ONE	ONE
ALL	ALL
RAND	RANDOM
DEL ALL	DEL ALL
DELETED ALL	DELETED ALL
NO USB	NO USB
NO SD	NO SD
NO SONG	NO SONG
NOT SUPPORT	NOT SUPPORT

### Specifications

Power Requirements	Refer to the main label on the unit.
Power Consumption	Refer to the main label on the unit.
Dimensions (W x H x D)	Approx. 196.0 mm x 239.0 mm x 205.0 mm
Bus Power Supply (USB)	5 V  500 mA
Amplifier (Total RMS output power)	40 W RMS

Design and specifications are subject to change without notice.

### Replacement of battery

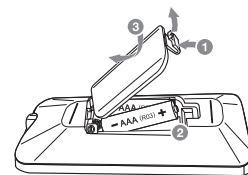

## SIMPLE MANUAL

# Multimedia Speaker System

Please read this manual carefully before operating your set and retain it for future reference.

To view the instructions of advanced features, visit <http://www.lg.com> and then download Owner's Manual. Some of the content in this manual may differ from your unit.

MODELS  
LK72B

LK72BE





## Front Panel

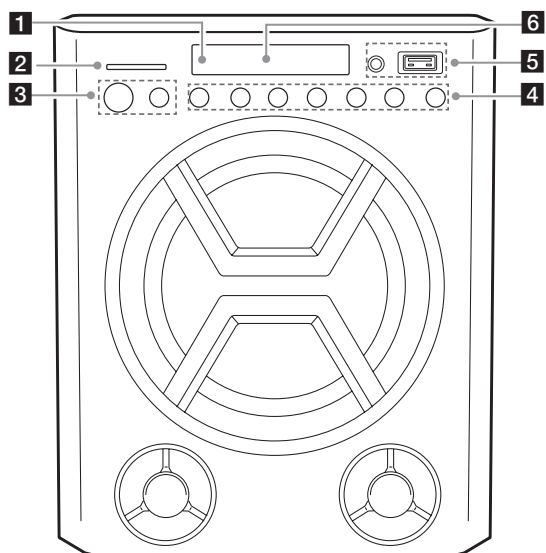

**1** Remote sensor

**2** SD card slot

You can play sound files by connecting the SD card.

**3** (Standby)

Turns the power on or off.

**F** (Function)

Selects the function and input source.

**4** **VOL** (Volume) **-/+**

Adjusts speaker volume.

**⏮ / ⏭** (Skip/Search)

- Skips backward or forwards.

- Searches for a section within a file.

- Selects the radio stations.

**⏮** (Play/Pause)

Starts or pauses playback.

**BASS -/+**

Adjusts bass level.

**5** USB port

You can play sound files by connecting the USB device.

**PORT. (Portable) IN**

Connect a portable device.

**6** Display window

## Rear Panel

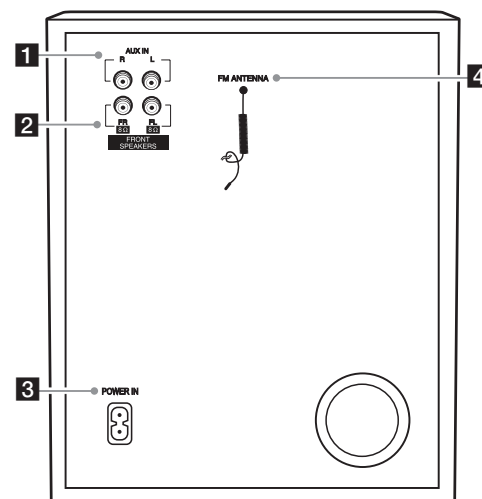

**1** **AUX IN** (L/R)

Connect an auxiliary device.

**2** **FRONT SPEAKERS** (FL/FR) connector

**3** **POWER IN**

**4** **FM ANTENNA**

## Speaker Connection

