

2.1 SOUNDBAR SPEAKER SYSTEM

Model No: - AAVANTE BAR 1280

Bluetooth Name: Aavante Bar 1280



Thank you for choosing the boAt Aavante Bar 1280 as the audio source for your home. Discover a new level of immersive, cinematic audio experience at home with the boAt Aavante Bar 1280. A powerful 80W total output, a slim sound bar and versatile 2-way subwoofer brings every aspect of your entertainment be it a song, show or movie to life. Drivers at each end of your sound bar deliver a clear mid and high range, while a 40W subwoofer fills in the rumbling lows. The 2.1 channel sound system provides a balanced sound and deep bass for your movies, music and even video games and you can experience cinematic sound that revolves around you. Stay plugged into the sound with Bluetooth® wireless technology, AUX and USB mode. Bring your home to life with the boAt Aavante Bar 1280. We request that this guide carefully for proper use of your purchase.



boat

plug into nirvana

Jacqueline

Jacqueline
Fernandez

Includes:

- Aavante Bar 1280
- Subwoofer
- Remote Control
- 2 X AAA Batteries
- Owner Manual
- Warranty Card
- AUX cable
- Wall mount Hardware

Controls and connections

1. Led indicator
2. Power Cord
3. USB Cable
4. AUX Cord
5. Subwoofer Output
6. Standby button
7. Vol +
8. Vol -
9. Bluetooth pair/ play pause

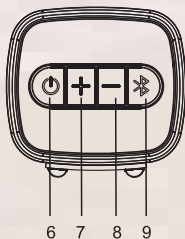
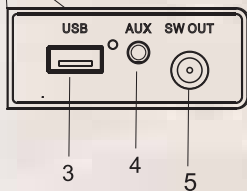
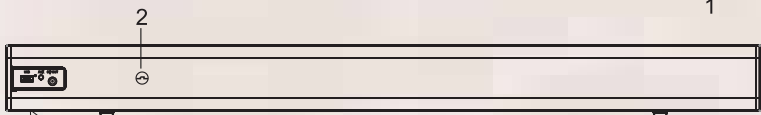
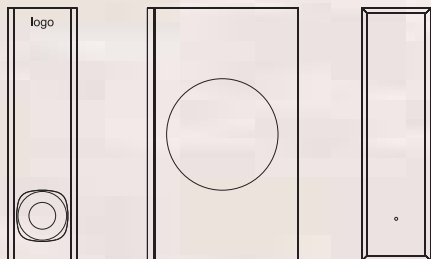

Remote Control - Control/Functions



1. **STANDBY:** Standby mode for power on/off.
2. **PAIR:** Long press this button to disconnect to the pairing device.
(Bluetooth Name: Aavante Bar)
3. **LUM:** Brightness control.
4. **Loop playback.**
(Only work under USB mode, Press to select "ON" to loop playback only one song, press again to select "AL" to loop playback all songs,)
5. **VOL+:** Volume increase adjustment button.
6. **Prev song.** (Only work under USB and BT mode,)
7. **VOL-:** Volume Downward Adjustment Button.
8. **-10:** Go back ten songs. (Only work under USB mode,)
9. **TREBLE-:** Treble Decrease Button.
10. **BASS-:** Bass Decrease Button.
11. **MUSIC:** Select the MUSIC EQ effect.
12. **NEWS:** Select the NEWS EQ effect.
13. **MUTE** mode.
14. **INPUT:** AUX/USB/BT Selection.
15. **RESET:** Location retrieval.
16. **Press to stop.** (Only work under USB mode,)
17. **Next song.** (Only work under USB and BT mode,)
18. **+10:** Go ten songs forward. (Only work under USB mode)
19. **TREBLE+:** Treble Increase Button.
20. **BASS+:** Bass Increase Button.
21. **MOVIE:** Select the MOVIE EQ effect.
22. **3D:** Select the 3D EQ effect.
23. **Play/Pause** (Only work under USB and BT mode,)

Different Indicators/Modes

To power on the Soundbar, simply plug in the power cord and the red LED indicator will indicate that it is in standby mode. Below are the LED indicators for all modes:

Red: Standby mode

Blue: Bluetooth mode

Green: AUX mode

Pink: USB mode

To power on/off the Soundbar, simply press and hold the Standby button for up to 3 seconds until the LED light indicator changes.

To change the input mode (Bluetooth, AUX, (USB) tap the Standby button lightly. Each tap will make the mode change once

Bluetooth Mode

1. Power-on the boAt Aavante Bar 1280 by pressing the Standby button on the Soundbar or on the remote control. The LCD indicator will change from red to blue when in Bluetooth pairing mode.
2. Turn on Bluetooth on your phone and search for available devices within range, select "boAt Aavante Bar 1280" from the list of options.
3. If a password is asked for, enter "0000." The blue LED indicator will stop blinking once the pairing has been successful.
4. Playing/pausing tracks, controlling volume and the choosing of tracks can all be done from your connected device; there is no need to interact with the SoundBar. The remote control can be used as well.

AUX Mode

1. Use a 3.5mm AUX jack to connect any device you intend to use with the boAt Aavante Bar 1280. Use either the buttons on the SoundBar or the "Input" button on the remote to activate AUX mode. A green LED indicator will indicate that AUX mode has been selected.
2. Playback functions (play/pause, volume, tracks) cannot be adjusted through the SoundBar remote when in Aux mode. It can only be done through the Bluetooth connected device.

USB Mode

1. Plug in your pendrive after switching the SoundBar on, the unit will automatically read through the files and begin playing music. The LED indicator will flash pink when in USB mode.
2. Music playback can be controlled from the buttons on the SoundBar – Volume, Play/pause, change tracks through the remote.
3. Simply remove the USB if you wish to exit this mode. You can also utilize the “Input” button on the Soundbar buttons or use the remote to change the mode.

Please note: Up 32 GB USB drives containing MP3 file formats are compatible with the SoundBar.

MOUNTING INSTRUCTIONS

Please measure the distance between the centre holes on the wall brackets before beginning your work.

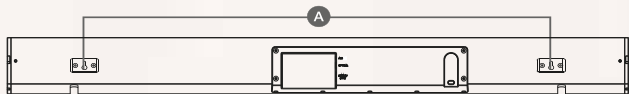

Open you've selected the place you would like to mount the SoundBar on, drill two holes the same distance as the holes on the wall brackets of the SoundBar.

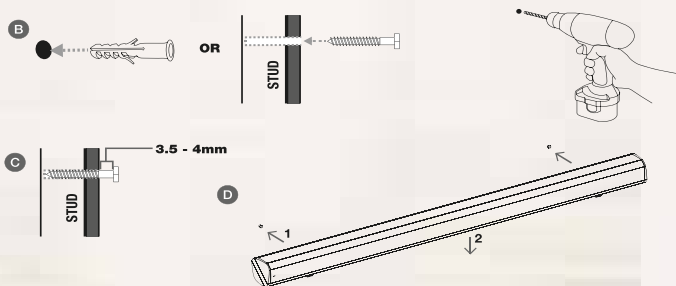

Wall anchors (fig B) are recommended for this task, or drilling into a stud. If you are using anchors, make sure that the holes you have made are deep enough to accommodate them. Be sure to leave a 3.4 – 4mm gap between the wall and the screws head (fig C).

- (1) Align the Soundbar with the mounting screws and slide it onto the same.
- (2) Tug the Soundbar down slightly to ensure that it is seated properly (fig D)

Important Safety Instructions

Caution:

To reduce the risk of shock, please do not dismantle the Soundbar and please allow that it does not come into contact with rain or excessive moisture, which can damage the insides. There is no replacement or user-serviceable parts inside, therefore please only contact qualified personnel for reparations.



This symbol indicates a lack of insulation, creating the chance of dangerous voltage release that can shock or harm persons. Please do not use the Soundbar if this symbol appears.



Means that it is of importance, please read the sections wherever it appears carefully, both on the Soundbar and in this Manual.

Please read this manual before using the boAt Aavante Bar 1280.

As mentioned above, please ensure that any issues with the Soundbar are addressed by persons that have qualifications and experience in the manufacturing/servicing of this product. Please do not attempt to dismantle or service the Soundbar on your own in any fashion. In addition, please only parts that have been provided in the purchase of this product.

- Please do not listen at excessively high volumes for extended periods of time. This can be damaging to one hearing.
- Please do not place apparatus such as vases on the Soundbar
- Please ensure that sources of high temperature are kept away from the Soundbar and that is not exposed to excessive heat through radiators, heaters, stoves, that produce heat.
- Ensure that the voltages on your wall sockets for power output are the same voltage system as the boAt Aavante Bar 1280. Please be careful of the wires, in that they do not cause some to trip and are not pinched and pulled in any way.
- Please keep the device switched off when not in use. Ensure that the plug is always removed directly, never pull on the cord. Further, please plug it in properly before turning on the Soundbar for the first time.
- As mentioned above, please keep away from areas with high moisture.
- Clean the Soundbar with a dry cloth, no chemical solvents or any other cleaning liquids.
- There is a chance of electromagnetic interference between the waves of different devices e.g TV's. Please move such devices away from other if any abnormalities (such as waves appearing on the television) occur.
- The packaging of the product can be useful for further travels, if possible try to store away the packaging during the opening up and placing of the Soundbar.

TROUBLESHOOTING

PROBLEM	SOLUTION
No power	<ol style="list-style-type: none">1. Make sure the boAt Aavante Bar 1280 is plugged in and turned on.2. Turn off the power switch and wait for a few minutes before trying again
No Sound	<ol style="list-style-type: none">1. Make sure you've selected the proper source2. Make sure the volume is set properly on the unit and at the correct playback mode- (Bluetooth, USB or AUX inputs)
Bluetooth pairing fails	<ol style="list-style-type: none">1. Check to see that both devices are turned on and that your Bluetooth device is discoverable2. Turn both devices off and on again3. Make sure you've selected the proper output mode ((Bluetooth, USB or AUX inputs)4. Make sure that the Bluetooth is within 5 feet of the unit5. Move both devices away from other Bluetooth devices, microwaves, wireless routers, and other electronics6. Make sure that the unit is not paired to a previously paired device
Flies on USB memory device will not play back	<ol style="list-style-type: none">1. Make sure you've selected the proper source2. Make sure that the audio files are in MP3 format.3. Make sure that the memory device is no more than 32 Gb
Remote does not work	<ol style="list-style-type: none">1. The batteries may have been depleted, attempt placing new ones.

Important Notes

- If connected to a TV via Bluetooth there may be a sound lag between the TV and the device. To solve this, the best option is to connect the TV and Soundbar using an aux/ optical/ HDMI output.
- The Soundbar may not be compatible with all Bluetooth capable TV's. In this case, please use an aux/ optical/ HDMI output to connect the Tv and Soundbar to one another.

Specifications

Features	1,Audio Output: 2.1CH, Wired Subwoofer 2,AUX input 3,USB input 4,Wireless Bluetooth connection 5,LED indicator 6,Plastic case,Digital Amplifier with DSP inside 7,Remote controller
Power Supply	SMPS 110V-240V ~ 50/60Hz
Power output	20W*2+40W=80W R.M.S.
Driver Unit	2.25"*2 SB + 5.25inch SW
Input impedance	4Ω*2+6Ω
Frequency Response	55Hz-20KHz
S/N	≥ 72dB
Distortion	</=1%(1K/1W)
Input Sensitivity	SB: 800mV±50mV; SW: 400mV±50mV
Dimension(mm)	Sound bar: 70H*78D*860L mm Subwoofer: 115W*420H*250D mm
Bluetooth Version	Version: 4.2+EDR Range:up to 10m



boat
plug into nirvana

Hardik Pandya

Hardik Pandya

WARRANTY

boAt AAVANTE BAR 1280 comes with a one year all India warranty

Warranty Card

Customer Name : _____

Product Name : _____ Model No.: _____

Address: _____ Date of Purchase: _____

Dealer Name : _____ Phone No.: _____

For Service please contact :-

Imagine Marketing Pvt. Ltd, 255, Guru Gobind Industrial Estate Jay Coach, Goregaon East, Mumbai, Maharashtra - 400063 Phone: +91-22-49461882, Email: info@imaginemarketingindia.com

CONNECT WITH US ON



boAt-lifestyle.com



facebook.com/boat.nirvana



instagram.com/boat.lifestyle1



Thank You